

DEVELOPMENT DATA

- EXISTING ZONING R-9
- PROPOSED ZONING R-9
- TOTAL SITE ACRES .06
- 4.14 HAUSING UNITS - 5
- 5.14 DRIVEWAY ACCESS TO
- PACK ROAD FROM W. 104th
- AT THE INTERSECTION OF
- THE PROPOSED DRIVEWAY
- ACCESS TO THE PARK-
- RAMP STREET (SEE PLAN)
- PLANTING STRIP AND EASE-
- MENT TO THE PROPOSED
- SCREENING WALL
- EXISTING TREES TO BE
- REMOVED
- WHERE THESE ARE NOT
- EXISTING TREES TO BE
- REMOVED
- PLANTING STRIP SHALL BE
- PLANTED ALONG PARK-
- RAMP

PARK-PRINCETON
DATE: 24 FEBRUARY 1992

REZONING PLAN
PETITION NO. 92-27
SCALE: 1" = 20'

REVISIONS:
DATE: 6/18/92
APPROVED BY CITY COUNCIL
July 20, 1992

Claydon Properties

1133 GUNNERY RD. #202
CHARLOTTE, NC 28203
PH: 704/371-0989

Tom Barry
architect

1133 GUNNERY RD. #202
CHARLOTTE, NC 28203
PH: 704/371-0989

Tom Barry
architect

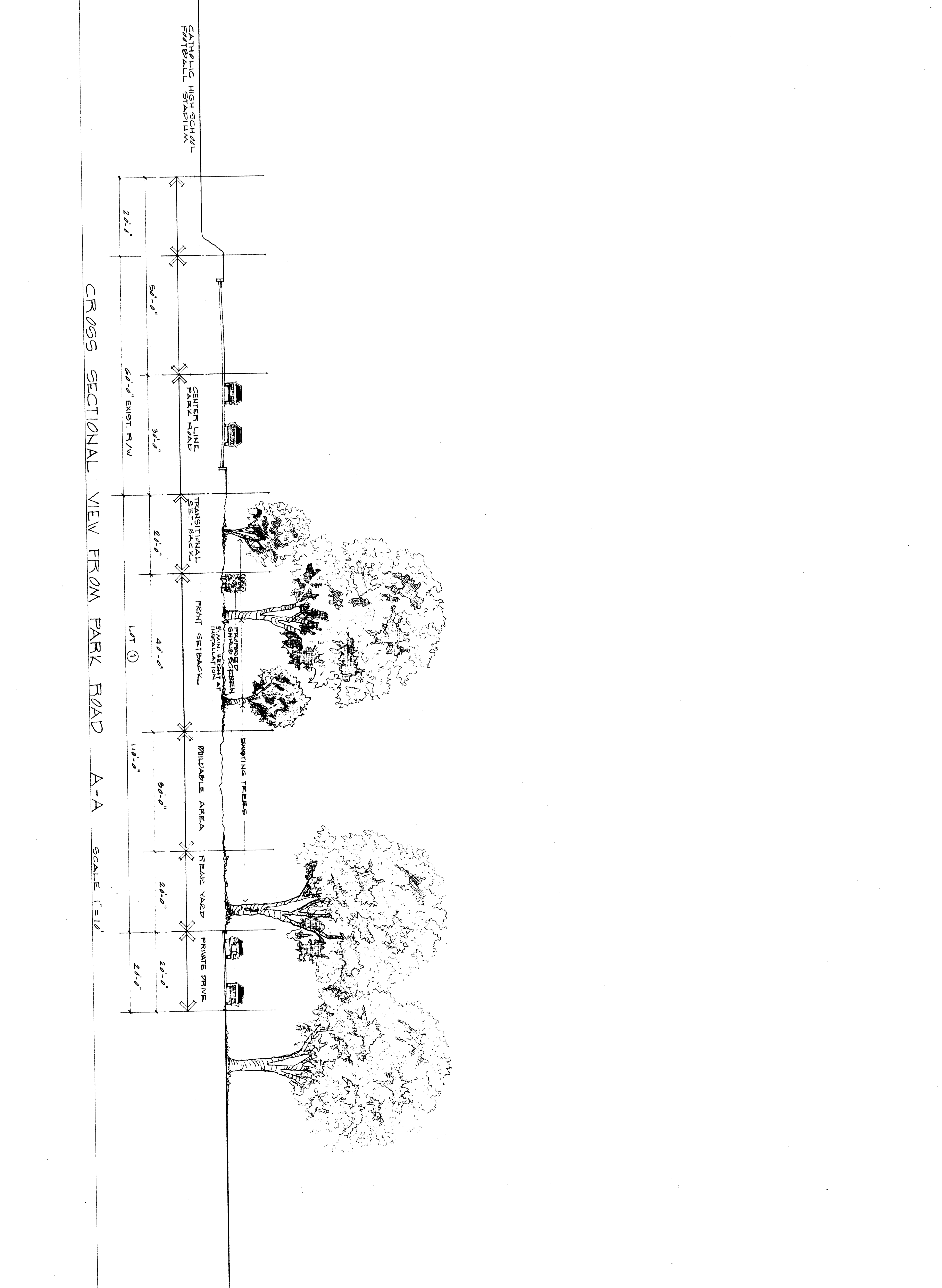

CROSS SECTIONAL VIEW FROM PARK ROAD A-A
SCALE: 1" = 10'

PARK-PRINCETON
25 PRINCETON AVENUE

1133 GUNNERY RD. #202
CHARLOTTE, NC 28203
PH: 704/371-0989

Tom Barry
architect

1133 GUNNERY RD. #202
CHARLOTTE, NC 28203
PH: 704/371-0989

Tom Barry
architect