

HAWTHORNE SCHOOL
PARTIAL SITE PLAN SCALE 1" = 200'
0 50 100 200 400 600

PARCEL DESCRIPTION

LEGAL DESCRIPTION	TOTAL AREA	IMPERVIOUS AREA	LANDSCAPE AREA	REG. PARKING	COMPACT PARKING	HANDICAPPED PARKING	TOTAL PARKING
Parcel A Block 9	86,006 SF 1.974 Ac.	67,406 SF	18,600 SF	6	0	0	6
Parcel B Block 8 Lot 5,6	14,252 SF .327 Ac.	8,107 SF	6,145 SF	10	0	5	16
Parcel C Block 3 Lot 7,8,9,10	32,876 SF .755 Ac.	18,748 SF	14,130 SF	44	13	0	58
Parcel D Block 2	100,785 SF 2.314 Ac.	82,214 SF	18,572 SF	175	66	6	247
Hawthorne School	N/A	N/A	N/A	101	0	0	101
Total				336	79	12	428

All off street parking shall be landscaped in accordance with the requirements of Chapter 21 of City Code "Trees".
A Class B Buffer shall be maintained in accordance with Part 3: Buffers and Screening; Table 12.302b of the Charlotte Zoning Ordinance.

SITE SUMMARY

TOTAL SITE SIZE: 5.37 acres (not including off site shared parking)
EXISTING ZONING: R-5 **PROPOSED ZONING:** O-2
PROPOSED USE: Religious Institution
SEATING CAPACITY: 1,800
BUILDING SIZE: 33,000 SQ.FT. **EXISTING:** 40,000 SQ.FT. **New**
FLOOR AREA RATIO: .312

GENERAL NOTES:

- While indicating a firm concept of development, minor adjustments to building shape, size and location, as well as parking and circulation pattern may occur to accommodate site conditions.
- Storm water detention shall be provided which will meet or exceed the requirements of the Charlotte Stormwater Detention Ordinance. NO DETENTION AREA WILL BE PLACED WITHIN THE SETBACK.
- Signage shall be allowed in accordance with applicable zoning standards.
- Parking and service areas on this site will be screened to comply with Section 12, 303 of City Zoning Ordinance.
- Site lighting shall be designed with a high cut-off angle or shielding and shall be mounted at a height of 20'-0" maximum. FIXTURES TO BE DESIGNED TO REDUCE GLARE.
- ALL SITE DEVELOPMENT SHALL MEET THE REQUIREMENTS OF THE TREE ORDINANCE FOR CITY OF CHARLOTTE.

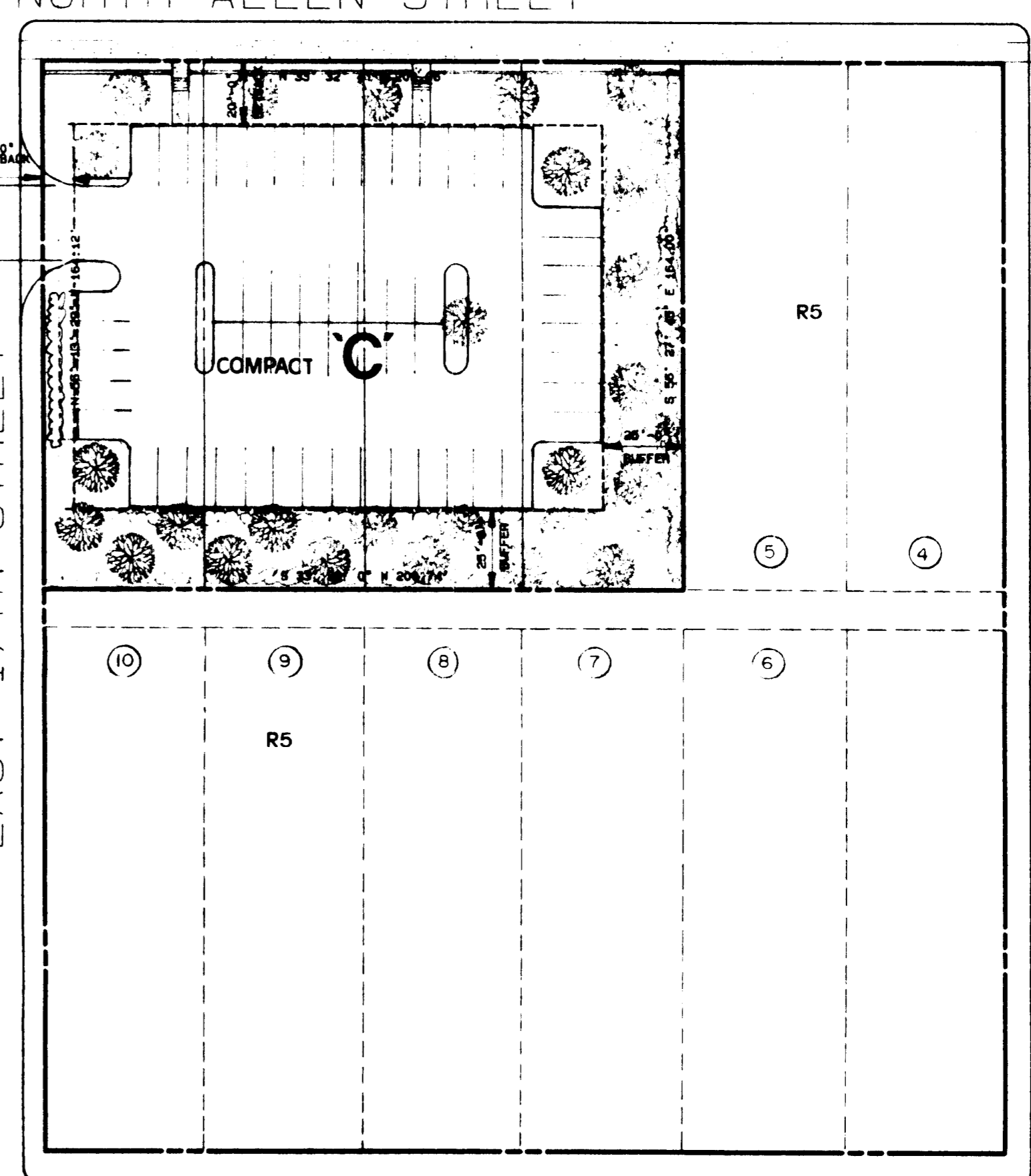
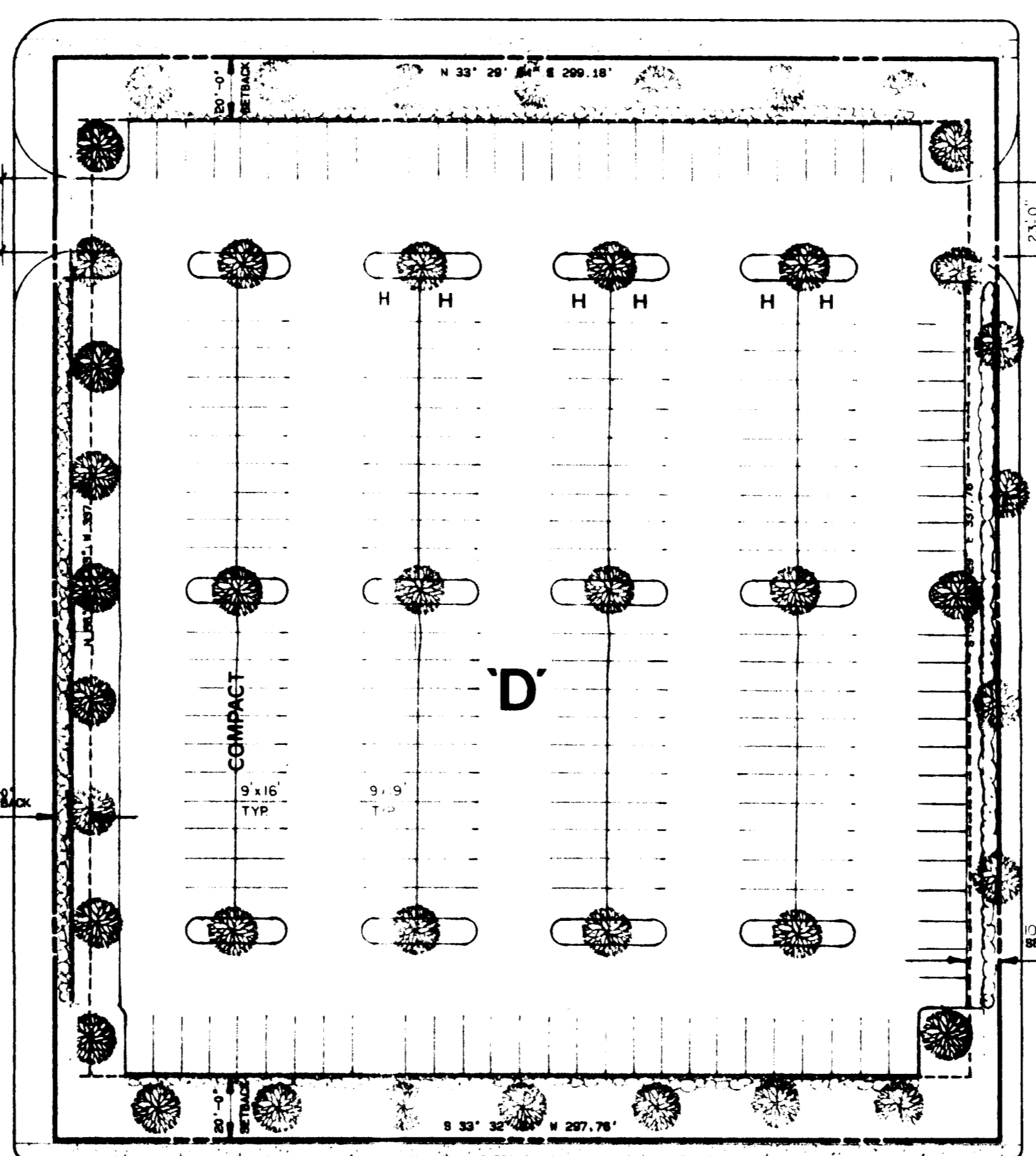
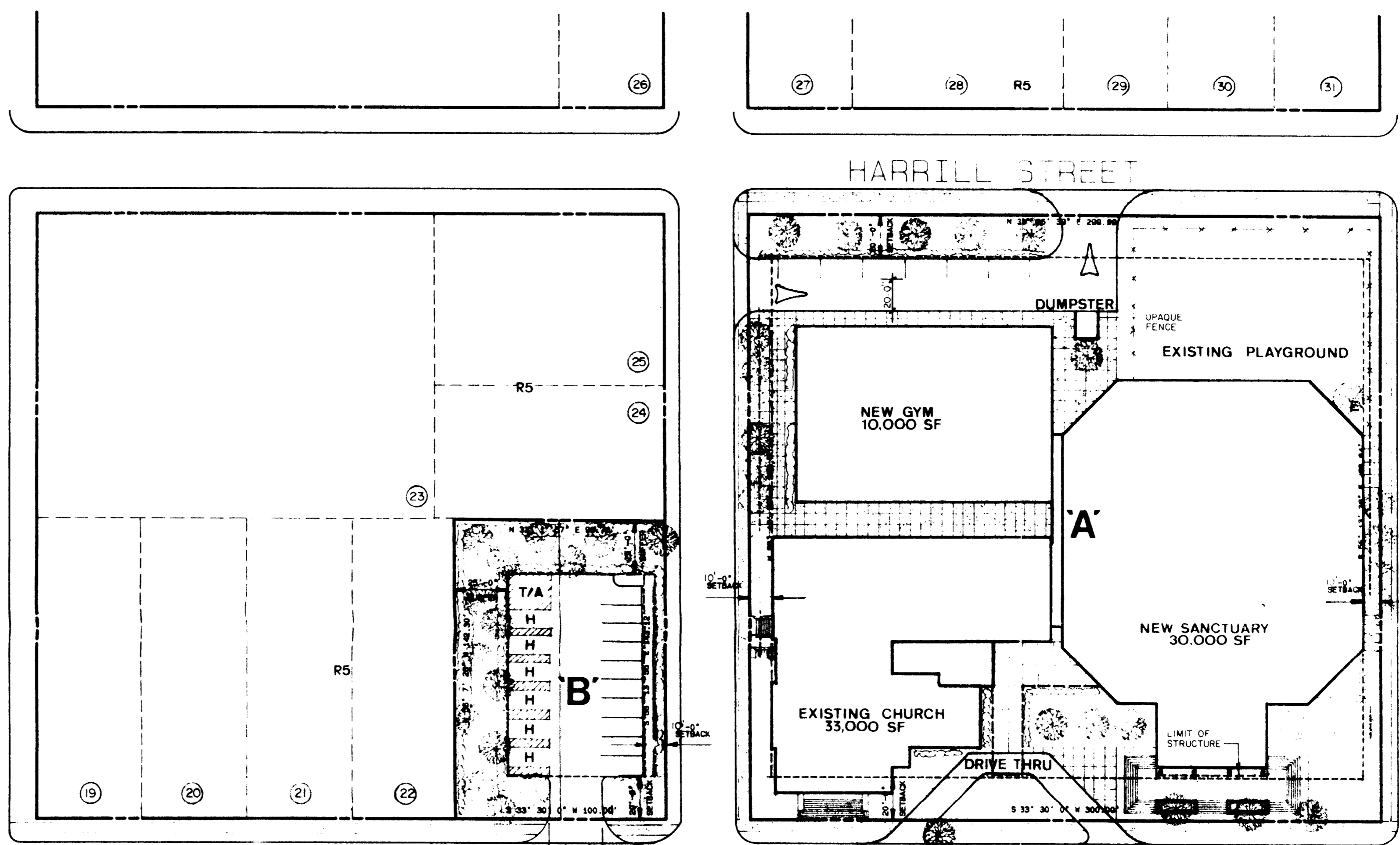

LANDSCAPE LEGEND

(11) NEW TREE	(12) EXISTING TREE	(13) SCREENING SHRUBS
---------------	--------------------	-----------------------

KEYED TO LIST OF ADJOINING PROPERTY OWNERS

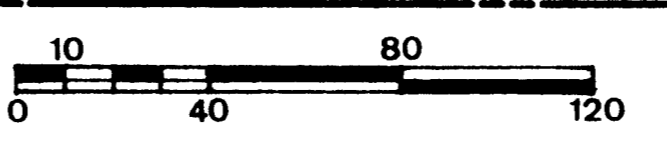

TAX NO. 081-136-07
081-135-06, 07
081-138-01; 2-6; 09; 10
081-137-01
ACAD: 21575 MAP L-130

PEGRAM STREET

HAWTHORNE SCHOOL DRIVES (SEE PARTIAL SITE PLAN)

SITE PLAN

FILE: SPASITEA SCALE: 1"=40'

APPROVED BY CITY COUNCIL
DATE August 24, 1992
92-31

SCALE AS NOTED
SHEET FILE NAME SPASITE1.C
DRAWN BY W.D.R./P.D.M.
CHECKED BY
APPROVED BY
DATE 04/23/92
REVISIONS

JEFFRY C. HONE
ARCHITECT
TYLER, TEXAS

A NEW FACILITY FOR THE
ST. PAUL BAPTIST CHURCH
CHARLOTTE, NORTH CAROLINA

REZONING SITE PLAN
FOR PUBLIC HEARING
REVISED 6-20-92

THIS DRAWING IS THE EXCLUSIVE PROPERTY OF PAUL & ASSOCIATES ANY USE WITHOUT WRITTEN PERMISSION IS EXPRESSLY PROHIBITED.

SHEET NO. OF