



\* 0 0 B R E A K 0 0 \*



**ADVANCED  
IMAGING  
SYSTEMS**

www.aisimc.com

An Information  
Management Company

# City of Charlotte – Planning Dept. Scanning Rezoning Files

Petition # \_\_\_\_\_

## Document type:

- Applications
- Correspondence
- Department Comments
- Land Use Consistency
  - Mail Info
  - Mapping
  - Other
- Site Plans



\* 0 0 B R E A K 0 0 \*

Petition #: 93-14(c)

Petitioner: Crosland Piper Glen Ltd. Ptshp. Hearing Date: June 14, 1993

Zoning Classification (Existing): R-15(CD) and R-12MF(CD)

Zoning Classification (Requested): R-3(CD)

Location: Approximately 38.33 acres located north of the Outer Belt, bounded by Rea Road and Elm Lane West.

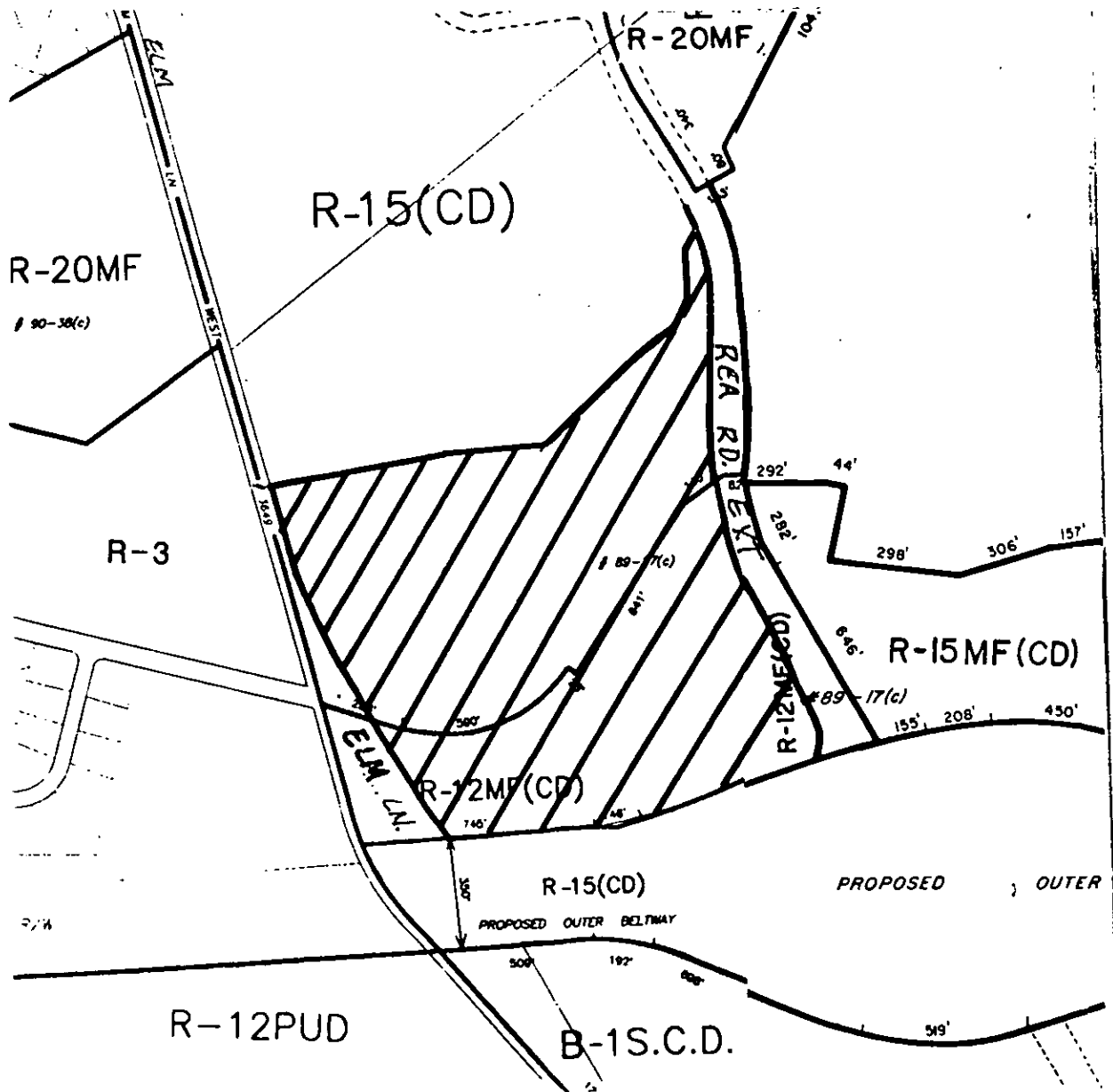

Zoning Map #(s): 176, 177

Scale: 1" = 400'