



\* 0 0 B R E A K 0 0 \*



**ADVANCED  
IMAGING  
SYSTEMS**

www.aisimc.com

An Information  
Management Company

# City of Charlotte – Planning Dept. Scanning Rezoning Files

Petition # \_\_\_\_\_

## Document type:

- Applications
- Correspondence
- Department Comments
- Land Use Consistency
  - Mail Info
  - Mapping
  - Other
- Site Plans



\* 0 0 B R E A K 0 0 \*

**Petition #:** 93-68

**Petitioner:** Charlotte-Mecklenburg Planning Commission

**Hearing Date:** August 30, 1993

**Zoning Classification (Existing):** I-1 & I-2

**Zoning Classification (Requested):** B-2 & I-1

**Location:** (A) properties along South Boulevard on the east side between Magnolia Avenue extending south of Ideal Way (from I-1 to B-2); and (B) two areas along South Boulevard generally located between Clanton Road and New Bern Street (from I-2 to I-1).



**See Attached Sheet(s)**

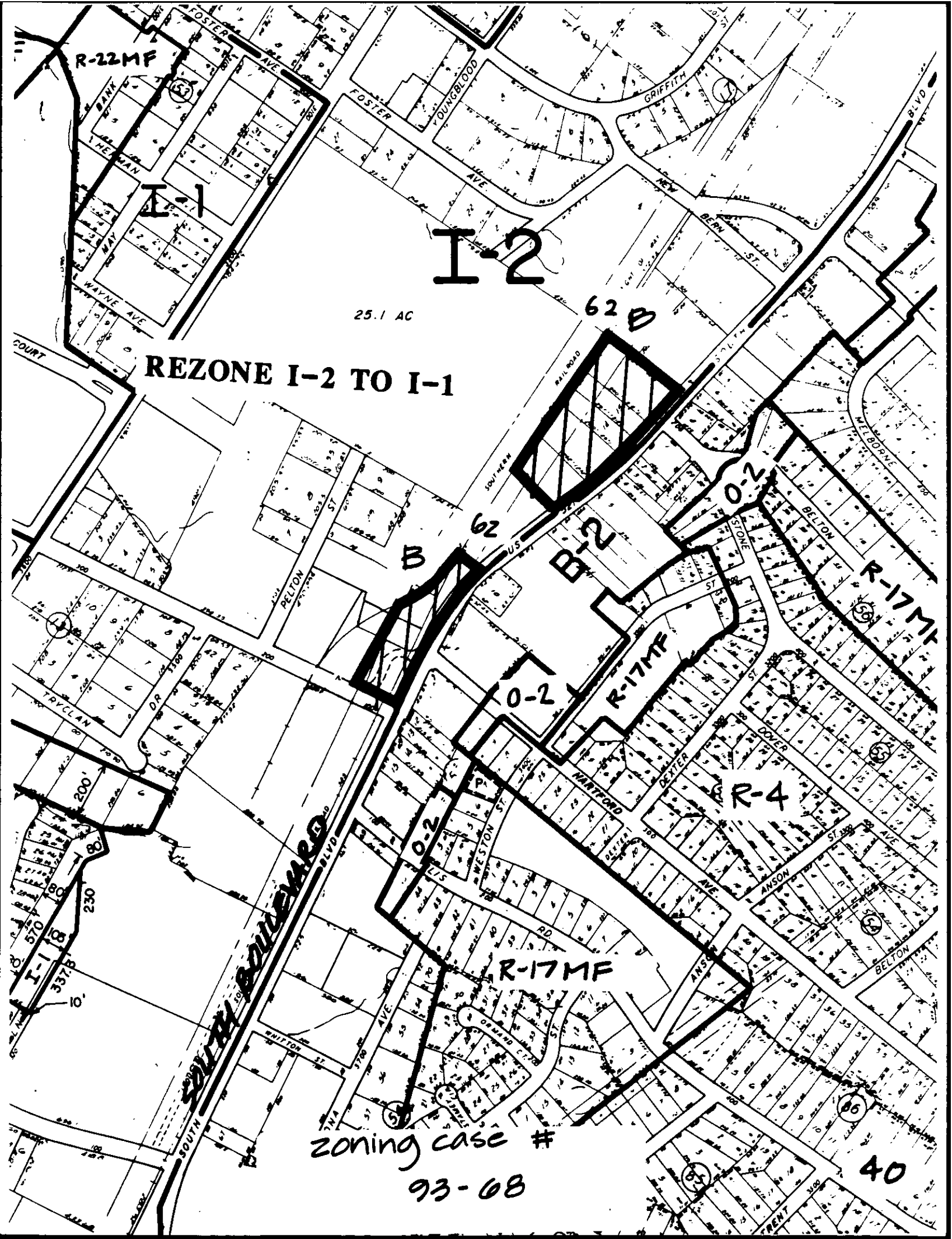

R-22MF

I-1

I-2

25.1 AC

62 B

REZONE I-2 TO I-1

B

62

B

O-2

O-2

R-17MF

R-17MF

R-4

R-17MF

zoning case #

93-08

40

**REZONE  
I-1 TO B-2**

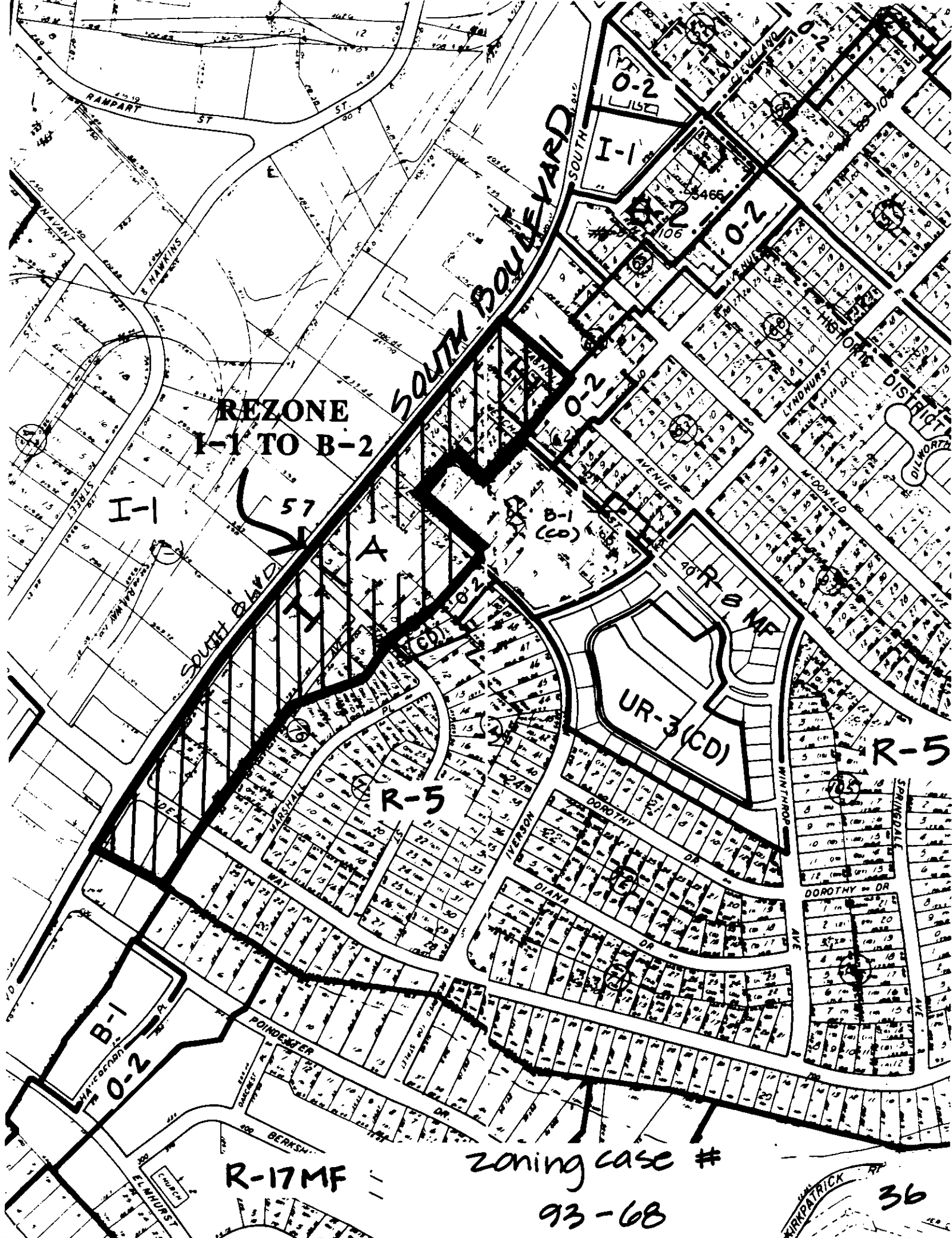

zoning case #  
93-68

R-17MF

36