



\* 0 0 B R E A K 0 0 \*



**ADVANCED  
IMAGING  
SYSTEMS**

www.aisimc.com

An Information  
Management Company

# City of Charlotte – Planning Dept. Scanning Rezoning Files

Petition # \_\_\_\_\_

## Document type:

- Applications
- Correspondence
- Department Comments
- Land Use Consistency
  - Mail Info
  - Mapping
  - Other
- Site Plans



\* 0 0 B R E A K 0 0 \*

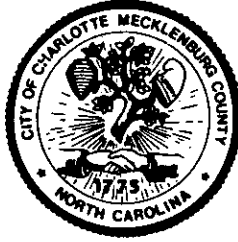

## CHARLOTTE - MECKLENBURG PLANNING COMMISSION

June 13, 1994

### NOTICE OF A REZONING PUBLIC HEARING

This letter serves as notification of a pending rezoning petition on property described below (See Cross-hatched section of map). A joint public hearing with the Mecklenburg County Board of Commissioners and the Charlotte-Mecklenburg Planning Commission has been scheduled for **Monday, July 11, 1994 at 1:30 P.M. in the Charlotte-Mecklenburg Government Center, Meeting Chambers, at 600 East Fourth Street.** You are encouraged to attend the public hearing, if you have any concerns regarding this request.

**Petition # 94-31(c)**

**Petitioner: FCI Realty and Management, Inc.**

**Existing Zoning: R-3**

**Requested Zoning: MX-1**

**Property Location: Approximately 11.46 acres located at the end of Shoal Creek Court south of Providence Country Club Drive.**

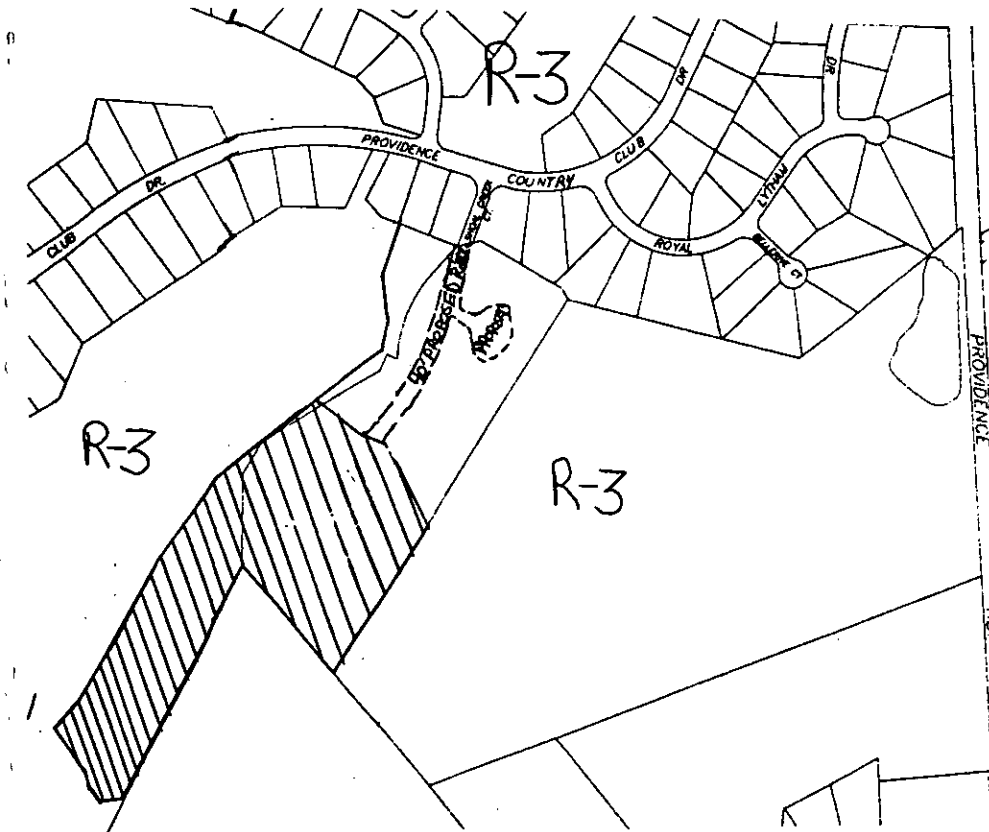

If you have any questions regarding this petition, please call Melony McCullough or myself at 336-2205.

Sincerely,  
  
Tim E. Manes  
Land Development Planner