

NEWTON HUNEYCUTT, RLS
3207 OL' MONTGOMERY PL.
MONROE, N. C. 28112
(704) 764-9501

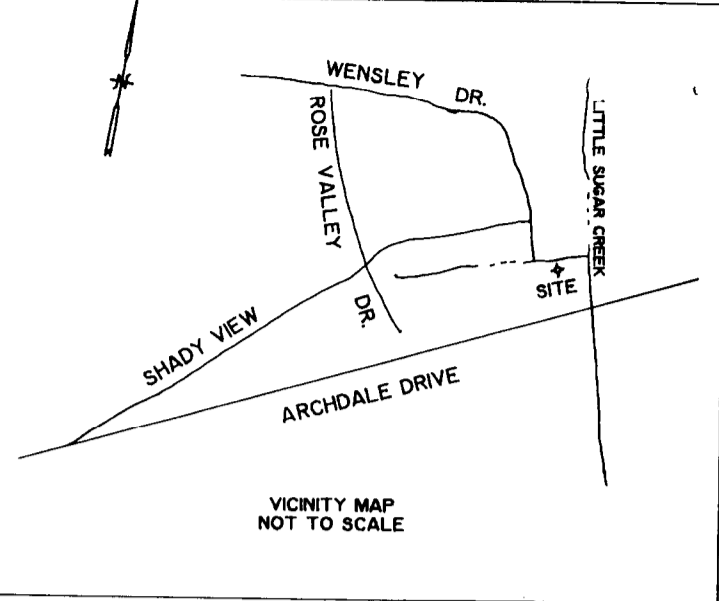

DILWORTH CHURCH OF CHRIST
3843-945
2525 ARCHDALE DRIVE
UNLISTED DRIVE
171-222-15
R-4

ETHELYN SWEET
4103-333
2615 WENSLEY DR.
553-2728
171-224-1
R-4

NOTES :

1. THIS PLAN REPRESENTS A CONCEPT OF DEVELOPMENT WITH REGARD TO PROPOSED SITE LAYOUT. THE FINAL PLAN WILL COMPLY WITH ALL APPLICABLE CITY AND STATE CODES.
2. THE PROPOSED BUILDING WILL NOT EXCEED 5250 SQ. FT. AND WILL COMPLY WITH ALL CITY AND STATE CODES.
3. ALL CONSTRUCTION WILL COMPLY WITH APPLICABLE CITY AND STATE CODES.
4. FENCING WILL BE PLACED ALONG CREEK BANKS AS SHOWN ON PLAN.
5. TOTAL AREA OF TRACT = 1.22 ACRES (53200 SQ. FT.)
6. TOTAL DEVELOPED AREA = 0.88 ACRE (38220 SQ. FT.)
7. CURRENT ZONING IS R-4.
8. PROPOSED ZONING IS R-8MF (CD)
9. NO OUTDOOR PLAY WILL BE PERMITTED AFTER SUNDOWN.
10. IF PROPOSED DEVELOPMENT DOES NOT TAKE PLACE, DEVELOPMENT WILL TAKE PLACE ACCORDING TO R-4 ZONING.
11. ARCHDALE DRIVE IS NOT PART OF THE N. C. DOT SYSTEM.
12. 36 PARKING SPACES ARE REQUIRED; 37 SPACES ARE PROVIDED.
13. PROPOSED USE OF FACILITY IS DAY CARE.
14. SCREENING ON ALL SIDES WILL COMPLY WITH SECTION 12.303 OF THE ZONING ORDINANCE.
15. THERE ARE NO OPPOSING DRIVEWAYS TO THIS TRACT.
16. THE NEAREST FIRE HYDRANT IS MORE THAN 750' FROM THIS DEVELOPMENT.
17. DRIVE WAY ENTRANCES WILL HAVE DROP CURB RAMP TYPE II CONSTRUCTION.
18. BUFFERS ON ALL SIDES WILL COMPLY WITH SECTION 12.303 OF THE ZONING ORDINANCE.
19. MAXIMUM CHILDREN ANTICIPATED WILL BE 175.
20. MAXIMUM STAFF WILL BE 18.
21. PLAY YARD FENCING WILL BE 6'-8" PRIVACY FENCE OR CHAIN LINK FENCING AS SHOWN ON THE SITE PLAN, AND BUFFERS WILL INCLUDE EVERGREEN VARIETIES IN ORDER TO MAINTAIN SEPARATION FROM THE ADJOINING RESIDENTIAL COMMUNITY.
22. ASHLEY PRESCHOOL ACADEMY WILL PROVIDE OUTDOOR PLAYING SPACE ACCORDING TO THE ORDINANCE PREVAILING AT THE TIME OF CONSTRUCTION.
23. THE BUILDING SHALL NOT BE CONSTRUCTED OF PREFAB METAL, PAINTED-ONLY CONCRETE BLOCKS, OR PULLED-IN MODULES.
24. TEMPORARY BARRIER FENCING MAY BE USED DURING CONSTRUCTION AND PRIOR TO INSTALLATION OF PERMANENT FENCING.

25. PRIVACY FENCING WILL BE OF WOODEN CONSTRUCTION AS PER CITY CODE.
PETITION NO. 95-44

PRELIMINARY SITE PLAN
"AS FOR PUBLIC HEARING"
PROPOSED DAYCARE FACILITY
ASHLEY PRESCHOOL ACADEMY
CHRIS AND CATHY AZAR
CHARLOTTE, N.C.
MECKLENBURG COUNTY

APPROVED BY CITY COUNCIL
DATE *February 18, 1995*

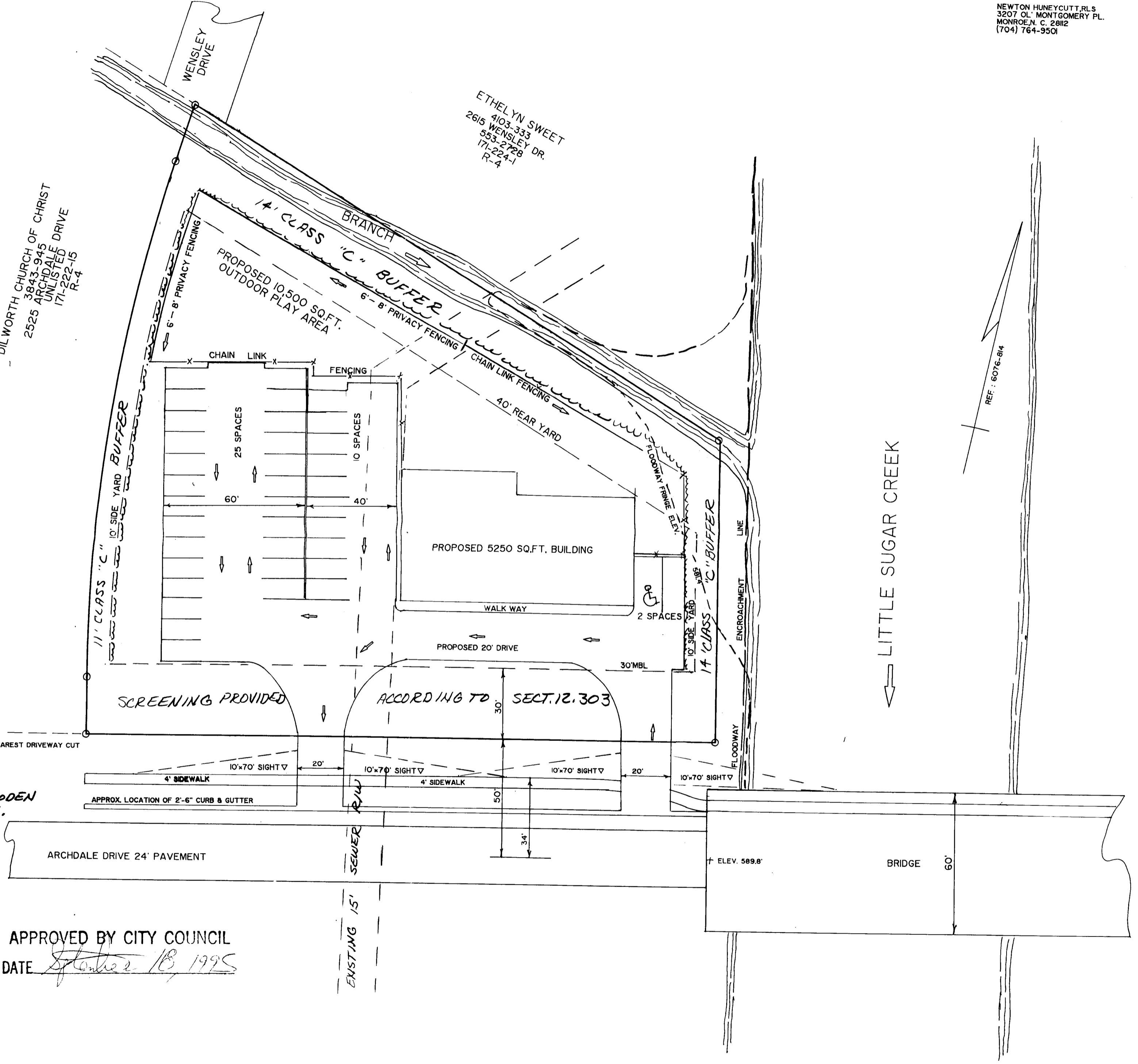

REF: 6076-814

LITTLE SUGAR CREEK

1" = 30'

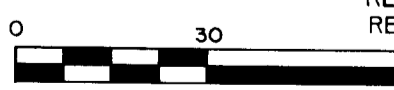

FEB. 14, 1995
REVISED MAY 18, 1995
REVISED JULY 5, 1995