

**W.T. HARRIS BOULEVARD**  
**FOR FAIRFIELD RESIDENTIAL, INC.**  
**AND PORTRAIT HOMES**

FAIRFIELD RESIDENTIAL INC.

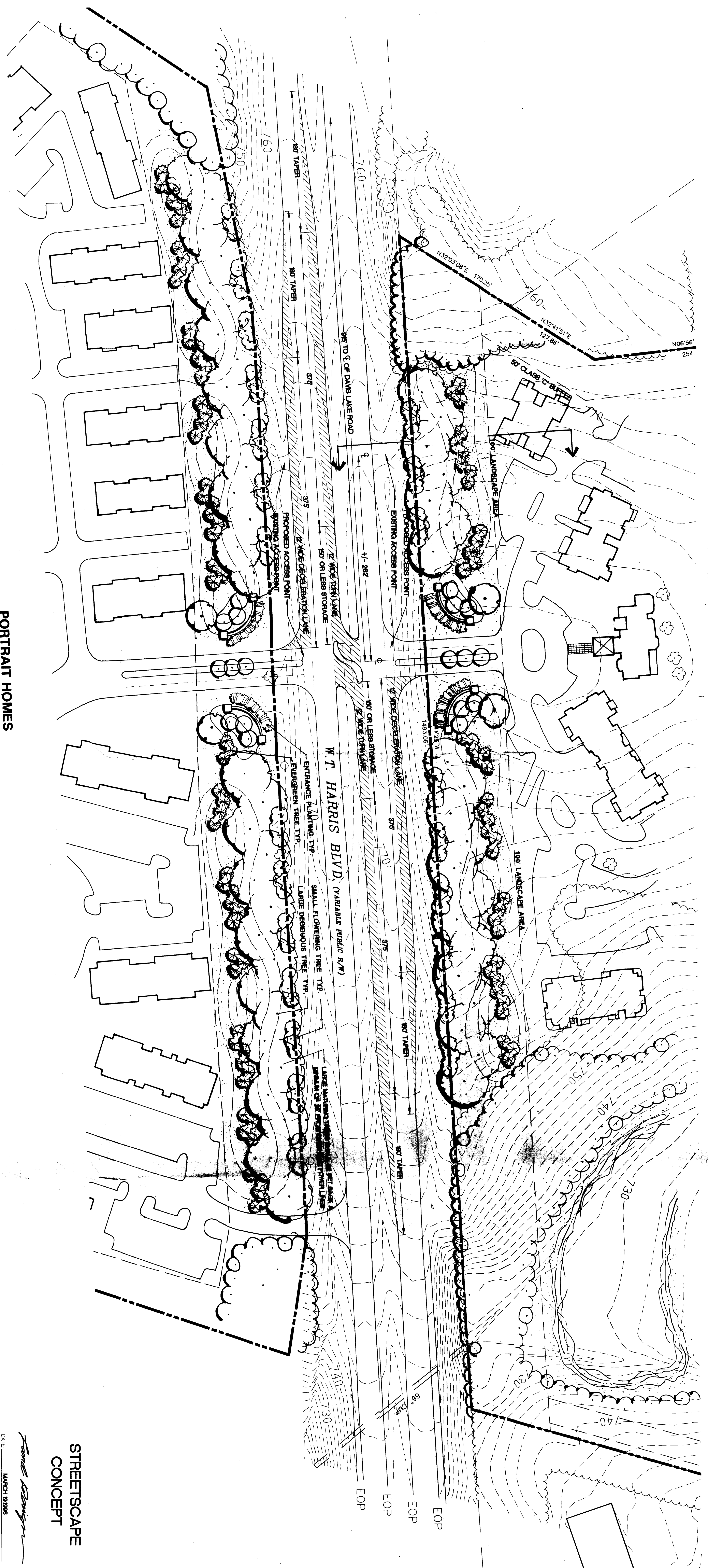

PORTRAIT HOMES

**STREETSCAPE**  
**CONCEPT**

AS FOR PUBLIC HEARING  
 PETITION NO. 96-11(C)

**NOTES:**  
 This plan depicts a commitment to a unified design for landscaping on both sides of Harris Boulevard and is being submitted with two rezoning petitions filed separately (one for each side of Harris Boulevard). While there is a commitment to carry out the plan, it shall be the individual responsibility of the developer of each side to fulfill the requirements without obligation for the opposite side.

PLANTING SHOWN IN 100' LANDSCAPE AREA & SCENERY IN NATURE AND SUBJECT TO REVIEW AND MODIFICATION BY OWNERS WHERE EXISTING NATURAL WETLANDS OCCUR.

THE BUILDING CONFIGURATION, PLACEMENT, AND SIZE SHOWN ON THE SCENERY PLAN ARE SCENERY IN NATURE AND MAY BE ALTERED OR MODIFIED TO ACCOMMODATE BUILDING AND CONSTRUCTION REQUIREMENTS. THE TECHNICAL DATA SHEET, PARKING LAYOUTS MAY ALSO BE MODIFIED TO ACCOMMODATE PAUL BARNES LANDSCAPE.

NOTE: TOP AND BOUNDARY DATA TAKEN FROM SURVEY PROVIDED BY FAIRFIELD RESIDENTIAL, INC. (DATE: 08/01/95) AND PORTRAIT HOMES (DATE: 08/01/95). CONTACT: FAIRFIELD RESIDENTIAL, INC. (PHONE: 770) 525-6000 OR (800) 534-4851. FAX: (770) 525-6000. ON 1/26/96, JOB NO. 95484.

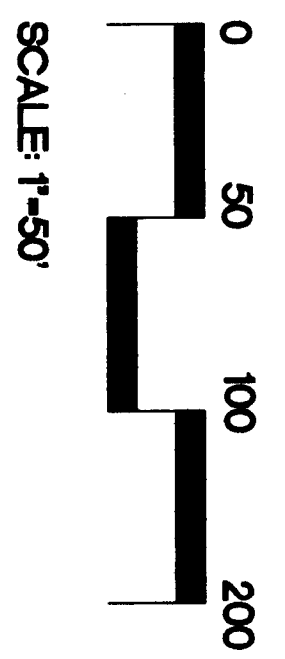

DATE: MARCH 18, 1995  
 PROJECT NO. 8041  
 REVISIONS:  
 MAY 17, 1995 - REVISED PER PLANNING COMMISSION COMMENTS  
 JUNE 28, 1995  
 LANDSCAPE ARCHITECTURE  
 Urban Design  
 I LAND DESIGN INC.  
 0-1701 East Boulevard, Charlotte, NC 28203 (704) 251-0333  
 0-1414 Pines Street, Asheville, NC 28804 (704) 254-7734

SHEET NO.: 3  
 FILE NAME: E:\KIM\KIM030300.DWG OF 3

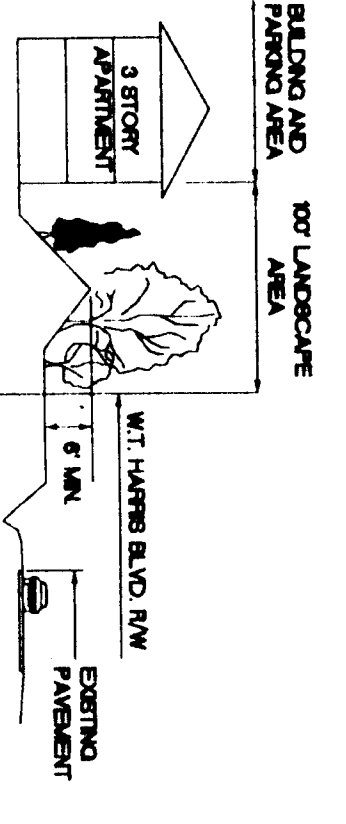

SECTION AT W.T. HARRIS BOULVARD

The following guidelines will be included with the 100' landscape area along W.T. Harris Boulevard for each 100' linear feet of frontage - including driveways:  
 (1) Large flowering trees having a height of at least 2 inches  
 (2) Small flowering trees having a height of 6 feet (see Stevens Hwy) having a height of at least 8 feet.  
 Plants will be included on shown on sections except where existing trees occur within the landscape area.  
 Large maturing trees shall be set back a minimum of 20' from overhead power lines.