

**ADJACENT PROPERTY OWNERS**

PARCEL NUMBER	OWNER MAILING ADDRESS
207-191-98	SUMMIT PROPERTIES PARTNERSHIP LP, 212 SOUTH TRYON ST. #500, CHARLOTTE, NC 28281
207-211-33	CHARLOTTE MECKLENBURG BOARD OF EDUCATION 701 E 2ND ST, CHARLOTTE, NC 28202
209-201-04	CHARLOTTE MECKLENBURG BOARD OF EDUCATION 701 E 2ND ST, CHARLOTTE, NC 28202
209-201-05	HARRIS C.M. HOLDING CO. P.O. BOX 220748, CHARLOTTE, NC 28222
209-511-07	BANDUKDA MOHAMAD N 2801 WINGHAVEN LN, CHARLOTTE, NC 28210
209-511-08	ACKERMANN MICHAEL & WF JACKLYNN M. 2803 WINGHAVEN LN, CHARLOTTE, NC 28210
209-511-09	CARTLEDGE KENNETH & WF TAMMIE B. 2807 WINGHAVEN LN, CHARLOTTE, NC 28210
209-511-10	SMITH CHARLES W III & WF CHERYL R. 2811 WINGHAVEN LN, CHARLOTTE, NC 28210
209-511-11	ZIER GEORGE J. & WF MILDRED S. 2815 WINGHAVEN LN, CHARLOTTE, NC 28210
209-511-12	SIMPSON SUSAN T. 2821 WINGHAVEN LN, CHARLOTTE, NC 28210
209-511-13	WEICHELBAUMER GEORGE & MARTINA FLOEL (R/S) 2827 WINGHAVEN LN, CHARLOTTE, NC 28210
209-511-14	HAWTHORNE DAVID B. & WF ROBIN BRYAN 2833 WINGHAVEN LN, CHARLOTTE, NC 28210
209-511-15	SNEED EVELYNNE A. 2901 WINGHAVEN LN, CHARLOTTE, NC 28210
209-511-16	HEILMAN JOHN J. & WF MARY E. 2907 WINGHAVEN LN, CHARLOTTE, NC 28210
209-511-17	ELAM RODNEY J. 2915 WINGHAVEN LN, CHARLOTTE, NC 28210
209-511-18	WENDLAND EDWARD M. & WF PAULA P. 2921 WINGHAVEN LN, CHARLOTTE, NC 28210
209-511-19	PLEZIA GEORGE H. & SP MICHELLE F. 2927 WINGHAVEN LN, CHARLOTTE, NC 28210
209-511-20	STOKES CRAIG A. & WF JACKIE B. 2933 WINGHAVEN LN, CHARLOTTE, NC 28210
209-511-21	MARKOWITZ SHARON 2939 WINGHAVEN LN, CHARLOTTE, NC 28210
209-511-22	KIRKMAN W. GARY & WF KATHRYN T. 2943 WINGHAVEN LN, CHARLOTTE, NC 28210
209-511-23	PERKINS ROBERT DOUGLAS & WF STELLA D. 2947 WINGHAVEN LN, CHARLOTTE, NC 28210
209-511-33	SOUTHMINSTER INC. PO BOX #3092, CHARLOTTE, NC 28210
209-511-34	SOUTHMINSTER INC. PO BOX #3092, CHARLOTTE, NC 28210
209-511-35	QUAIL HOLLOW PRESBYTERIAN CHURCH 8501 PARK RD, PINEVILLE, NC 28134
209-511-38	TINKER JONATHAN & WF GAIL W. 9000 WARBLER COURT, CHARLOTTE, NC 28210
209-521-10	DWANE JAMES WILLIAM & MELINDA ANN DEY (R/S) 8906 JENNA MARIE LN, CHARLOTTE, NC 28210
209-521-11	DUFOR GREGORY A. & WF WENDY A. 8904 JENNA MARIE LN, CHARLOTTE, NC 28210
209-521-12	CARMICHAEL NEIL G. & WF BARBARA D. 8900 JENNA MARIE LN, CHARLOTTE, NC 28210
209-521-13	CANN SIMON A. & WF HILL A. 3010 OLD CHAPEL LN, CHARLOTTE, NC 28210
209-521-14	ALLEN JAMES EDGAR JR. & WF SENA CAY. 3004 OLD CHAPEL LN, CHARLOTTE, NC 28210
209-521-15	MEAGHER WILLIAM C. JR. & WF ELAINE M. 3000 OLD CHAPEL LN, CHARLOTTE, NC 28210
209-521-16	KOHI AKIO ANDY & WF MIHOKO 3003 OLD CHAPEL LN, CHARLOTTE, NC 28210
209-521-97	CAMERON WOOD HOMEOWNERS ASSOC. INC. 2331 CROWNPOINT EX. DR. #L, CHARLOTTE, NC 28227
209-522-01	CHARLOTTE MECKLENBURG BOARD OF EDUCATION 701 E 2ND ST, CHARLOTTE, NC 28202

EXISTING ZONING - R-3  
 PROPOSED ZONING - INST-CD  
 PROPOSED PROJECT  
 COMPLETION - JUNE 1997

**KEY**

- PROPOSED BUILDING ADDITION
- PROPOSED NEW PAVEMENT
- EXISTING BUILDING, PAVEMENT & ETC.

**SITE PLAN**

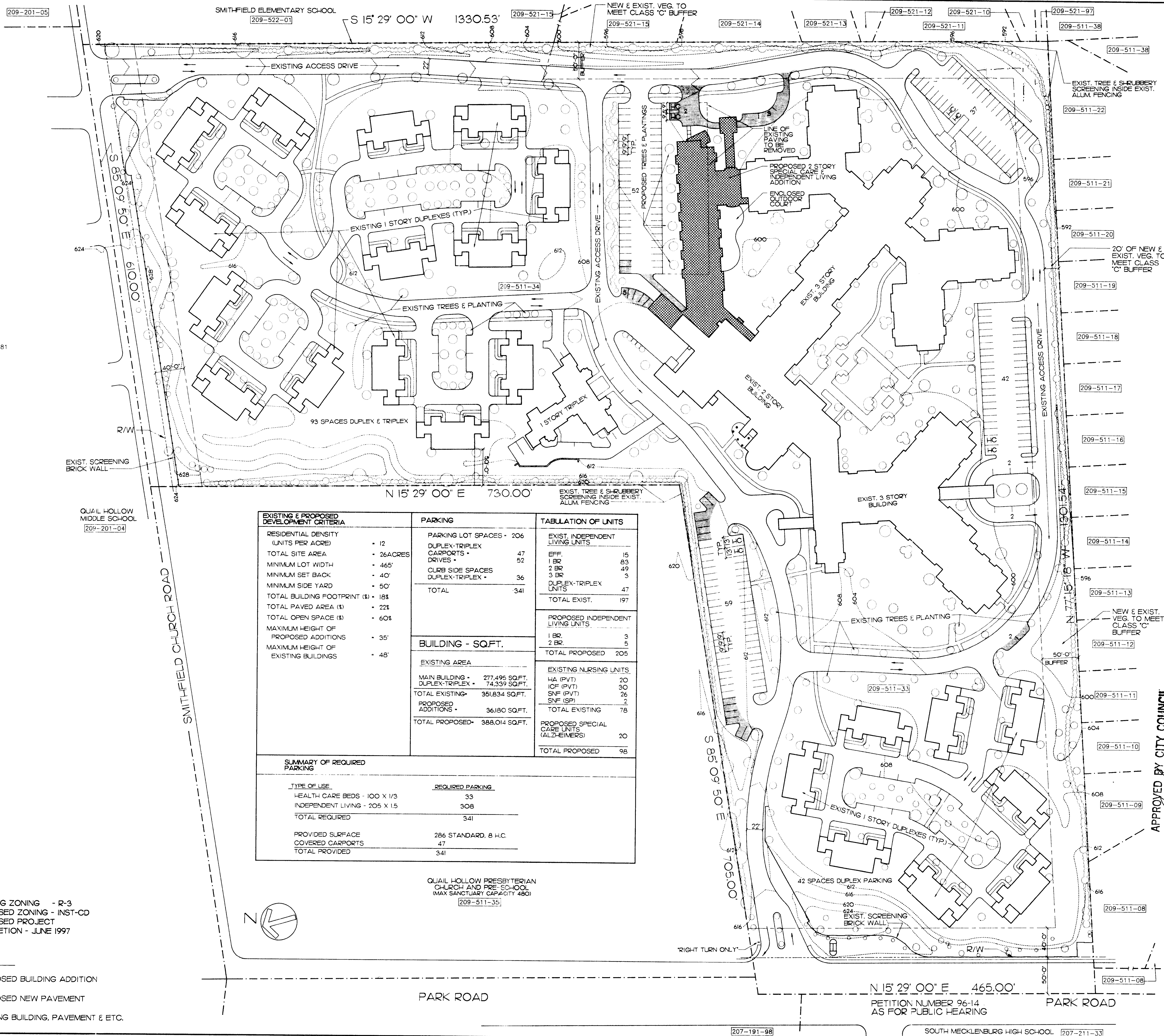
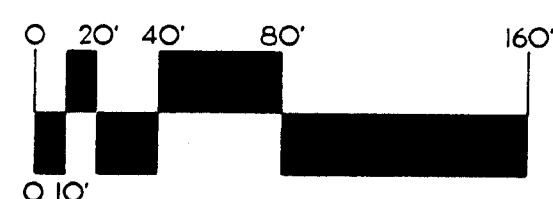

EXISTING & PROPOSED DEVELOPMENT CRITERIA		PARKING		TABULATION OF UNITS	
RESIDENTIAL DENSITY (UNITS PER ACRE)	• 12	PARKING LOT SPACES -	206	EXIST. INDEPENDENT LIVING UNITS	
TOTAL SITE AREA	• 26 ACRES	DUPLEX-TRIPLEX CARPORTS -	47	1 BR.	15
MINIMUM LOT WIDTH	• 465'	DRIVES -	52	2 BR.	83
MINIMUM SET BACK	• 40'	CURB SIDE SPACES DUPLEX-TRIPLEX -	36	3 BR.	49
MINIMUM SIDE YARD	• 50'	TOTAL	341	DUPLEX-TRIPLEX UNITS	47
TOTAL BUILDING FOOTPRINT (S)	• 183			TOTAL EXIST.	197
TOTAL PAVED AREA (S)	• 223			PROPOSED INDEPENDENT LIVING UNITS	
TOTAL OPEN SPACE (S)	• 604			1 BR.	3
MAXIMUM HEIGHT OF PROPOSED ADDITIONS	• 35'			2 BR.	5
MAXIMUM HEIGHT OF EXISTING BUILDINGS	• 48'			TOTAL PROPOSED	205
		<b>BUILDING - SQ.FT.</b>		EXISTING NURSING UNITS	
		EXISTING AREA		LIA (PVT)	20
		MAIN BUILDING -	277,495 SQ.FT.	ICF (PVT)	30
		DUPLEX-TRIPLEX -	74,339 SQ.FT.	SNF (PVT)	26
		TOTAL EXISTING -	351,834 SQ.FT.	SNF (SP)	2
		PROPOSED ADDITIONS -	36,180 SQ.FT.	TOTAL EXISTING	78
		TOTAL PROPOSED -	388,014 SQ.FT.	PROPOSED SPECIAL CARE UNITS (ALZHEIMERS)	20
				TOTAL PROPOSED	98
<b>SUMMARY OF REQUIRED PARKING</b>					
TYPE OF USE		REQUIRED PARKING			
HEALTH CARE BEDS - 100 X 1/3		33			
INDEPENDENT LIVING - 205 X 1.5		308			
TOTAL REQUIRED		341			
PROVIDED SURFACE COVERED CARPORTS		286 STANDARD, 8 H.C.			
TOTAL PROVIDED		47			
		341			

QUAIL HOLLOW PRESBYTERIAN CHURCH AND PRE-SCHOOL (MAX SANCTUARY CAPACITY 480)  
 209-511-35

APPROVED BY CITY COUNCIL  
 DATE *March 13, 1996*

**HAWKINS KIBLER ASSOCIATES**  
 ARCHITECTS  
 209 West 4th Street  
 Charlotte, NC 28202  
 704/775-5611

**NEWMAN & JONES, P.A.**  
 ASSOCIATE ARCHITECT  
 608 West 4th Street  
 Winston-Salem, NC 27101  
 704/775-5687

**SOUTHMINSTER RETIREMENT COMMUNITY**  
 PROPOSED ADDITION

95021  
 10-19-95  
 1-19-96

**L-1B**