



* 0 0 B R E A K 0 0 *



ADVANCED
IMAGING
SYSTEMS

www.aisinc.com

An Information
Management Company

City of Charlotte – Planning Dept. Scanning Rezoning Files

Petition # _____

Document type:

- Applications
- Correspondence
- Department Comments
- Land Use Consistency
- Mail Info
- Mapping
- Other
- Site Plans



* 0 0 B R E A K 0 0 *

Petition #: 2000-17

Petitioner: Unique Southern Estates

Hearing Date: February 21, 2000 , September 18, 2000

Classification (Existing): B-2(CD)

Zoning Classification (Requested): B-2(CD) S.P.A.

Location: Approximately 4.06 acres located on the southeast corner of the intersection of The Plaza and Belvedere Avenue.



Zoning Map #(s): 101

Scale: 1" = 400'

2000-17



- Tax Parcel and Map Sheet Search
- Road Interchange/Intersection Search
- Market Analysis Search Menu
- Return to Full Map Extent
- How to Use the System
- Return to GIS Real Estate System Homepage

Click on Map to Perform Operation

- Refresh Map
- Pan
- Zoom In
- Zoom Out
- Zoom Factor:
- Identify:
- Surveyor's Report
- Adjoining Owner's Report within:
- Measure:
- Label Parcels by:

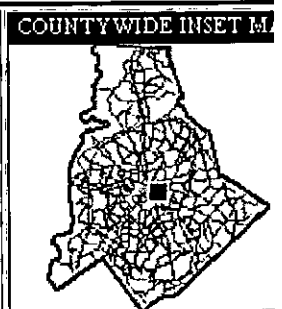
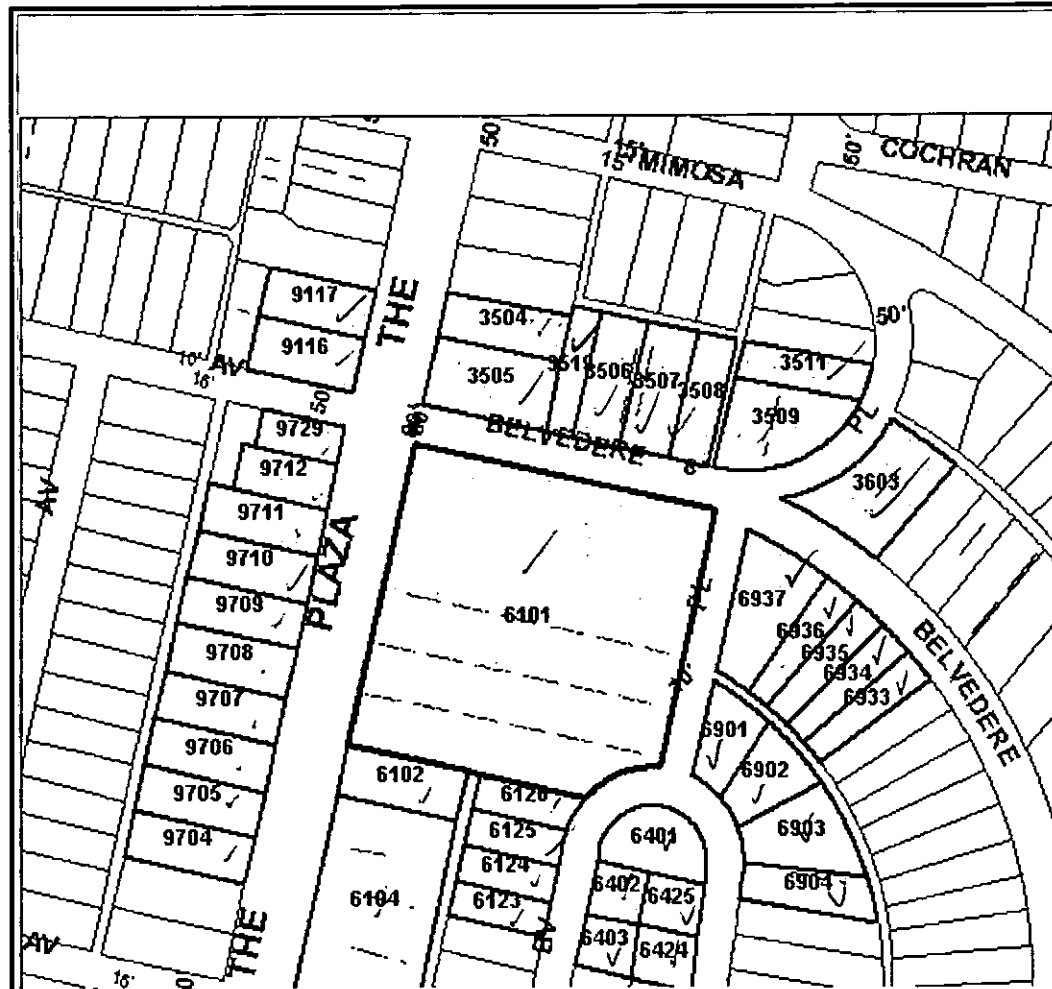

- LEGEND**
- County Bounda
 - Tax Parcels
 - ABC Parcel Dimensic
 - S Sales by Deed Year
 - Railroad ROWs
 - Utility ROWs
 - Bodies of Water
 - Streams
 - Floodplain
 - W Watershed
 - Building Outlin
 - Prop. I-485 Corridor

10	9711	08119711	SPURLING STEPHEN T	2027 THE PLAZA CHARLOTTE NC 28205	2027 THE PLAZA	09480	565	0.258
11	9712	08119712	SMITH DEBRA D & DARYL W MCCOLLUM	8624 TAYBROOK DR HUNTERSVILLE NC 28078	2031 THE PLAZA	07350	113	0.205
12	9729	08119729	SINGLETERY JOHN DAVID	1634 WOODBERRY RD CHARLOTTE NC 28212	2037 THE PLAZA	04846	939	0.138
13	3504	09503504	HALL RAY EFIRD & WIFE RUTH K	2108 THE PLAZA CHARLOTTE NC 28205	2108 THE PLAZA	N/A	N/A	0.254
14	3505	09503505	RICHARDS SUSAN C	2100 THE PLAZA CHARLOTTE NC 28205	2100 THE PLAZA	08160	490	0.371
15	3506	09503506	BOST DORIS BENFIELD	1717 BELVEDERE AVE CHARLOTTE NC 28205	1717 BELVEDERE AV	05667	290	0.273
16	3507	09503507	WHITLOW STEPHEN B & WF JOHNNIE B	1725 BELVEDERE AVE CHARLOTTE NC 28205	1725 BELVEDERE AV	07847	736	0.281
17	3508	09503508	BRENIZER DAVID E	1729 BELVEDERE AVE CHARLOTTE NC 28205	1729 BELVEDERE AV	08030	465	0.201
18	3509	09503509	KRIMMINGER JAMES CORNELIUS	1733 BELVEDERE AVE CHARLOTTE NC 28205	1733 BELVEDERE AV	02772	438	0.513
19	3511	09503511	HONEYCUTT A DEAN	413 CANVASBACK RD MOORESVILLE NC 28117	2119 THURMOND PL	03942	022	0.201
20	3519	09503519	BOST DORIS BENFIELD	1717 BELVEDERE AVE CHARLOTTE NC 28205	1715 BELVEDERE AV	05909	830	0.161
21	3603	09503603	KINSEY CHARLES W & WF KATHERINE S	1801 BELVEDERE AV CHARLOTTE NC 28205	1801 BELVEDERE AV	06401	807	0.542
22	6101	09506101	UNIQUE SOUTHERN ESTATES LLC	2010 THE PLAZA CHARLOTTE NC 28205	2010 THE PLAZA	N/A	N/A	0
23	6101	09506101	GILLESKIE MARK A & WF MARGARET B	2010 THE PLAZA CHARLOTTE NC 28205	2010 THE PLAZA	09034	100	0
24	6102	09506102	NISBET JEFFREY T & WF TAMERA L	1926 THE PLAZA CHARLOTTE NC 28205	1926 THE PLAZA	06130	313	0.273
25	6104	09506104	HOLY TRINITY EVANGELICAL LUTHERN CHURCH	1900 THE PLAZA CHARLOTTE NC 28205	1900 THE PLAZA	N/A	N/A	1.093
26	6123	09506123	KLEIN LINDA S	1915 NASSAU BLVD CHARLOTTE NC 28205	1915 NASSAU BV	05094	630	0.152
				1919 NASSAU BV	1919 NASSAU			



BUFFER: 200 FEET PID: 09506101 SUBJECT: UNIQUE SOUTHERN ESTATES LLC

- GPS Stations
- All Roads
- 1997 Aerial Photo
- Tax Parcel Lane Use
- Planning Land Use

<p>Date and Time Stamp 12/8/99 1:44:50 PM EST</p>	<p>This map is prepared for the inventory of real property within Mecklenburg County and is compiled from recorded deeds, plats, tax maps, surveys, planimetric maps, and other public records and data. Users of this map are hereby notified that the aforementioned public primary information sources should be consulted for verification. Mecklenburg County and its mapping contractors assume no legal responsibility for the information contained herein.</p>
---	---

[Click Here to Open Owner's List \(Comma-Delimited\)](#)

ADJOINING OWNER'S REPORT

Total Parcels Selected: 42

Total Tax Records Selected: 43

Record	MapId#	Parcel-Id#	Owner's Name	Mailing Address	Property Address	Deed Book	Deed Page	Acreege
1	9116	08119116	KALINA ROBERT MICHAEL	2101 THE PLAZA CHARLOTTE NC 28205	2101 THE PLAZA	05556	260	0.269
2	9117	08119117	YOUNG JOHN PHILIP	2107 THE PLAZA CHARLOTTE NC 28205	2107 THE PLAZA	04891	745	0.227
3	9704	08119704	DONEVAN MICHAEL C & DARCY D LEE (T/C)	1913 THE PLAZA CHARLOTTE NC 28205	1913 THE PLAZA	04913	561	0.258
4	9705	08119705	MORTON HERMAN LEON & STEPHEN WILKINSON HARWELL	1919 THE PLAZA CHARLOTTE NC 28205	1919 THE PLAZA	05136	234	0.258
5	9706	08119706	FARRAR CONRAD HOLMES, JR & WIFE LILLIE S	1927 PLAZA CHARLOTTE NC 28205	1927 THE PLAZA	01427	283	0.258
6	9707	08119707	LEONE RICHARD & WF BETTY & PRESSLEY LIVING TRUST **	2001 THE PLAZA CHARLOTTE NC 28205	2001 THE PLAZA	04190	655	0.234
7	9708	08119708	DAVIS WILLIAM H II	2009 THE PLAZA CHARLOTTE NC 28205	2009 THE PLAZA	04693	400	0.258
8	9709	08119709	CRESCENT PROPERTY RENTALS LLC	2220 KENMORE AV CHARLOTTE NC 28204	2015 THE PLAZA	08074	683	0.258
9	9710	08119710	SUMTER GERALDINE	2021 THE PLAZA CHARLOTTE NC 28205	2021 THE PLAZA	05329	591	0.258

27	6124	09506124	SAMUELS LINDA C	CHARLOTTE NC 28205	1919 NASSAU BV	08350	320	0.152
28	6125	09506125	JONES JOHN DARBY (BY WILL)	1945 THURMOND PL CHARLOTTE NC 28205	1921 NASSAU BV	02638	164	0.152
29	6126	09506126	FIDDLEHEAD INN LLC	2021 BAY ST CHARLOTTE NC 28205	1925 NASSAU BV	10508	604	0.158
30	6401	09506401	PARKS EARL LEE SR & WF JUDY CAROL JONES	1945 THURMOND PL CHARLOTTE NC 28205	1945 THURMOND PL	10712	139	0.286
31	6402	09506402	COLLINS-CLAPP WILLIAM K & WF CAROL	1925 NASSAU BLVD CHARLOTTE NC 28205	1920 NASSAU BV	06107	149	0.155
32	6403	09506403	BUSSARD MELANIE S	1914 NASSAU BLVD CHARLOTTE NC 28205	1914 NASSAU BV	03888	466	0.155
33	6424	09506424	CANADY RICHARD G	1933 THURMOND PL CHARLOTTE NC 28205	1933 THURMOND PL	04193	442	0.155
34	6425	09506425	ZAY KINGA & HSB PETER	1939 THURMOND PL CHARLOTTE NC 28205	1939 THURMOND PL	09440	326	0.155
35	6901	09506901	STONE LAVERNE LIBBY	725 MOCKSVILLE AVE SALISBURY NC 28144	1956 THURMOND PL	04593	849	0.175
36	6902	09506902	WALKER ANTHONY L & ALBERT G PILCONIS	1950 THURMOND PL CHARLOTTE NC 28205	1950 THURMOND PL	05593	015	0.196
37	6903	09506903	MANNING HELEN DRIGGERS (BY MARRIAGE)	1948 THURMOND PL CHARLOTTE NC 28205	1948 THURMOND PL	02440	062	0.26
38	6904	09506904	MAYER FLORENCE D ET AL	1942 THURMOND PLACE CHARLOTTE NC 28205	1944 THURMOND PL	03684	392	0.219
39	6933	09506933	READING SCOTT W & WF RHONDA	519 BREEZEWOOD DRIVE CHARLOTTE NC 28262	1822 BELVEDERE AV	07898	855	0.192
40	6934	09506934	CHAN JOSEPH S	1816 BELVEDERE AV CHARLOTTE NC 282053008	1816 BELVEDERE AV	09710	941	0.192
41	6935	09506935	NICHOLS WILLIAM F	1812 BELVEDERE AV CHARLOTTE NC 28205	1812 BELVEDERE AV	09460	110	0.192
42	6936	09506936	HOLDER RUFUS ERNEST & WF PATRICIA R	7340 IDLEWILD RD CHARLOTTE NC 28212	1810 BELVEDERE AV	10242	350	0.218
43	6937	09506937	SUDDRETH JOHN H JR & WF MASAKO	708 ASCOT DR CHARLOTTE NC	1800 BELVEDERE	04966	289	0.414

			GUSHIKEN	28215	AV			
--	--	--	----------	-------	----	--	--	--

This site is powered by



MapObjects Internet Map Server



HITSTATS By



This site was developed by Todd Wilson of Mecklenburg County GIS and was last updated on 11/23/99 1:29:56 PM