



\* 0 0 B R E A K 0 0 \*



**ADVANCED  
IMAGING  
SYSTEMS**

www.aisimc.com

An Information  
Management Company

# City of Charlotte – Planning Dept. Scanning Rezoning Files

Petition # \_\_\_\_\_

## Document type:

- Applications
- Correspondence
- Department Comments
- Land Use Consistency
  - Mail Info
  - Mapping
  - Other
- Site Plans



\* 0 0 B R E A K 0 0 \*

# MECKLENBURG COUNTY, NC GIS PUBLIC ACCESS SYSTEM

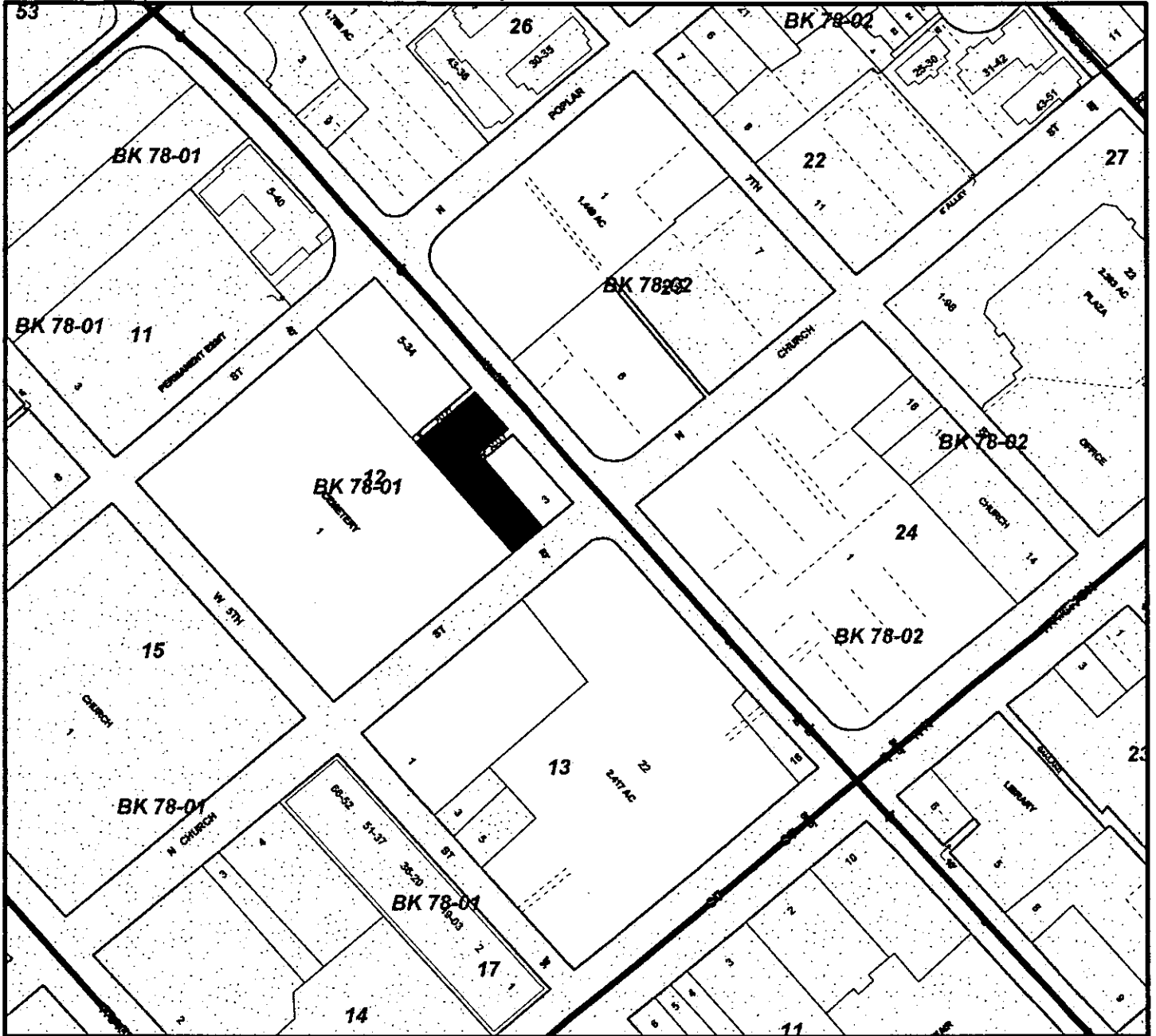

Tax Parcel-Id#s Selected: 07801201, 07801202, 07801203, 07801301, 07801322, 07801C98, 07802401, 07802501, 07802506

Tax Book & Page Selected: N/A

**LEGEND**

- Rivers/Creeks/Streams
- I-485 Corridor
- Utility ROW
- Utility ROW
- Railroad ROW
- Water Bodies
- Tax Page Boundaries
- Tax Parcels

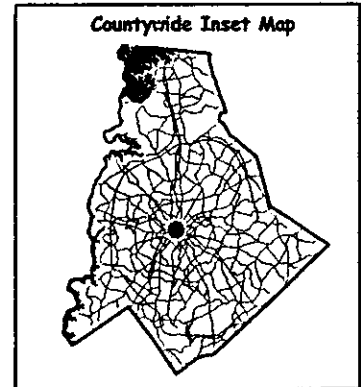
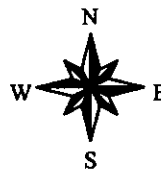

Scale : 1 Inch = 200 Feet

Map Created on Friday, January 14, 2000 01:51 PM

This map is prepared for the inventory of real property within Mecklenburg County and is compiled from recorded deeds, plats, tax maps, surveys, planimetric maps, and other public records and data. Users of this map are hereby notified that the aforementioned public primary information sources should be consulted for verification. Mecklenburg County and its mapping contractors assume no legal responsibility for the information contained herein.

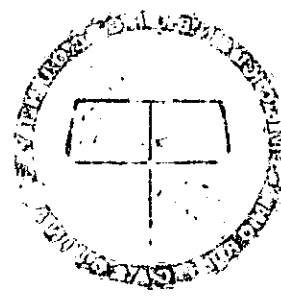
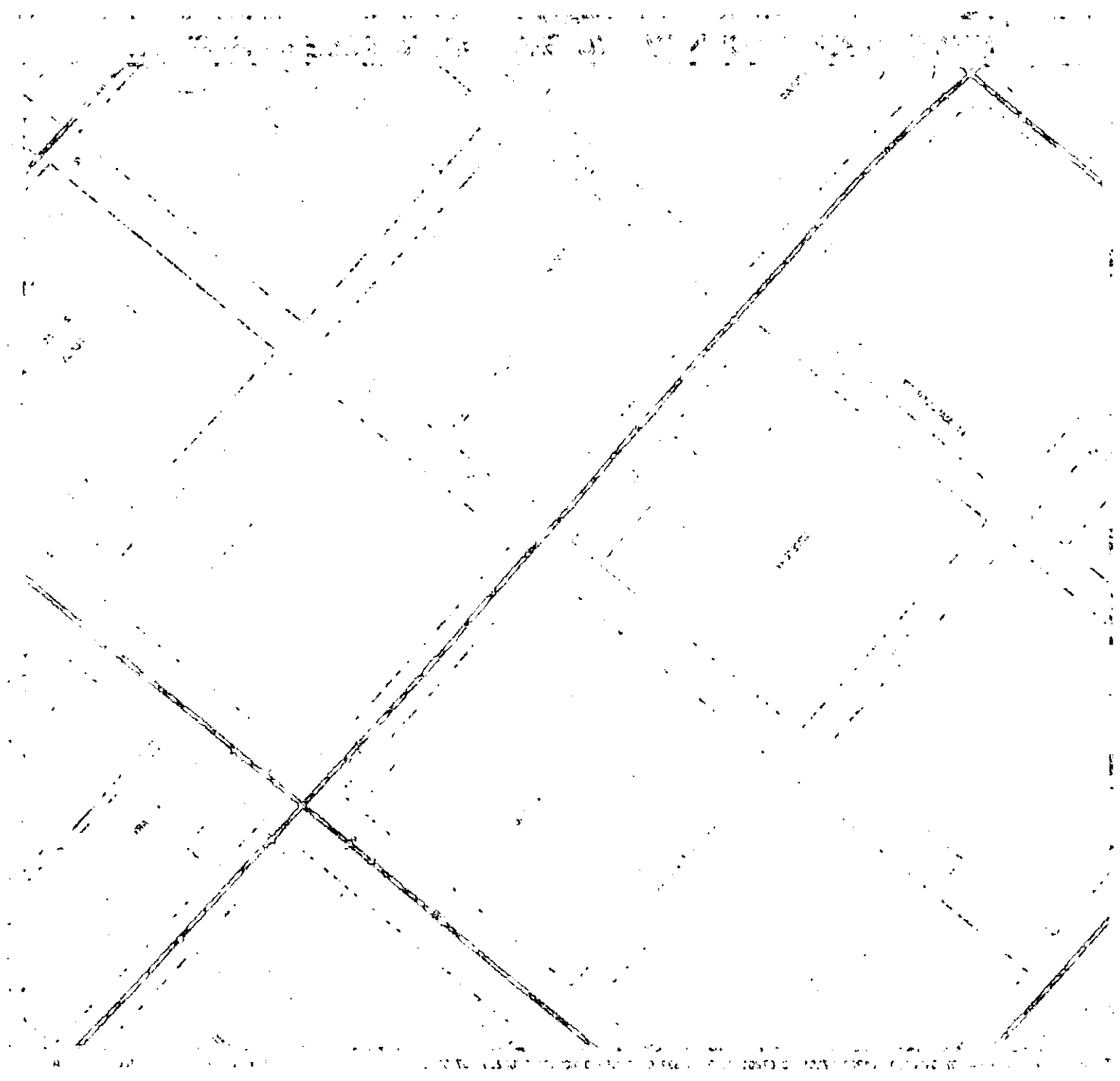

Handwritten text and a signature are present in the lower-right area. The text is mostly illegible due to the quality of the scan, but there is a prominent signature that appears to start with a large 'M' or 'W'. There are also some smaller markings and possibly a date or reference number.

Printed text at the bottom center of the page, likely a title or a reference number. It is mostly illegible but seems to contain several lines of information, possibly including a date or a project name.

# MECKLENBURG COUNTY, NC GIS PUBLIC ACCESS SYSTEM

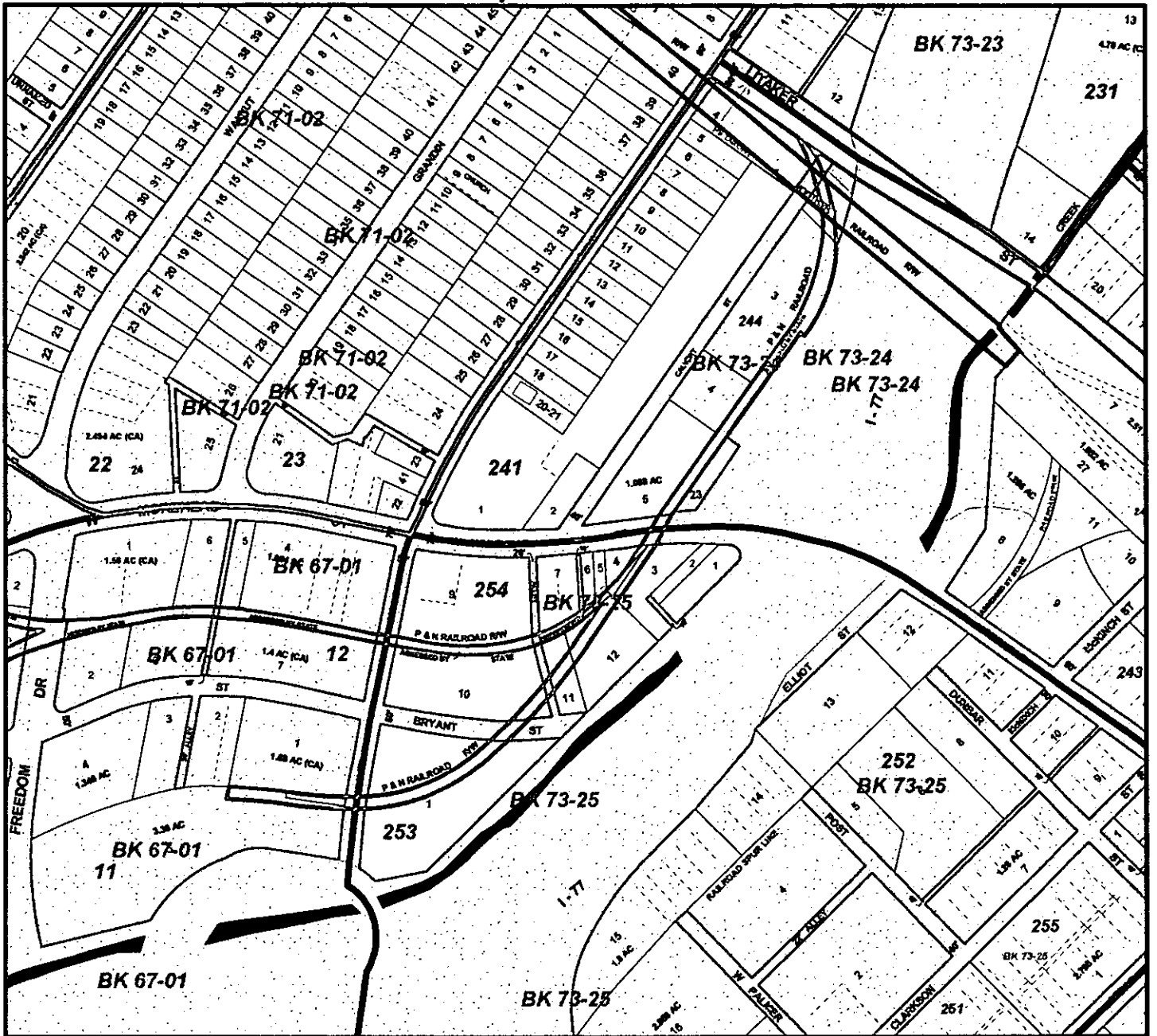

Tax Parcel-Id#s Selected: See Tax Information Report for List of Parcel-Id#s

Tax Book & Page Selected: N/A

**LEGEND**

- Rivers/Creeks/Streams
- I-485 Corridor
- Utility ROW
- Utility ROW
- Railroad ROW
- Water Bodies
- Tax Page Boundaries
- Tax Parcels

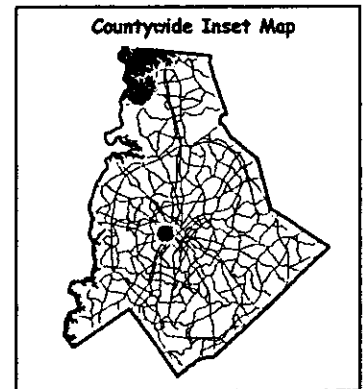
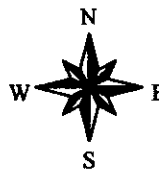

Scale : 1 Inch = 400 Feet

Map Created on Friday, January 14, 2000 02:05 PM

This map is prepared for the inventory of real property within Mecklenburg County and is compiled from recorded deeds, plats, tax maps, surveys, planimetric maps, and other public records and data. Users of this map are hereby notified that the aforementioned public primary information sources should be consulted for verification. Mecklenburg County and its mapping contractors assume no legal responsibility for the information contained herein.

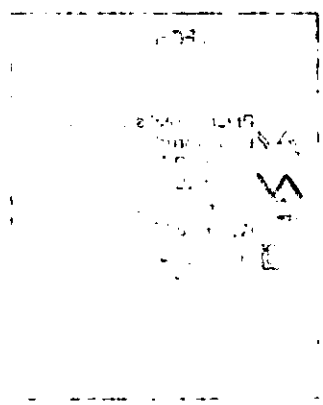
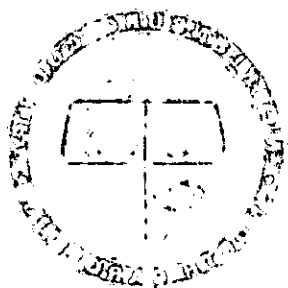
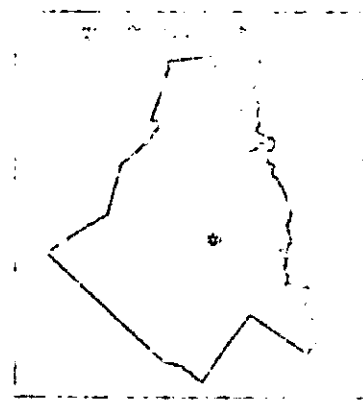

2317