



* 0 0 B R E A K 0 0 *



**ADVANCED
IMAGING
SYSTEMS**

www.aisimc.com

An Information
Management Company

City of Charlotte – Planning Dept. Scanning Rezoning Files

Petition # _____

Document type:

- Applications
- Correspondence
- Department Comments
- Land Use Consistency
 - Mail Info
 - Mapping
 - Other
- Site Plans



* 0 0 B R E A K 0 0 *

Petition #: 2000-56

Petitioner: Coconut Company LLC & Two Moon Dog

Hearing Date: April 17, 2000

Classification (Existing): B-1

Zoning Classification (Requested): MUDD-0

Location: Approximately .78 acres located at the southwest corner of North Davidson Street and East 36th Street and the southwest corner of North Davidson Street and East 35th Street.

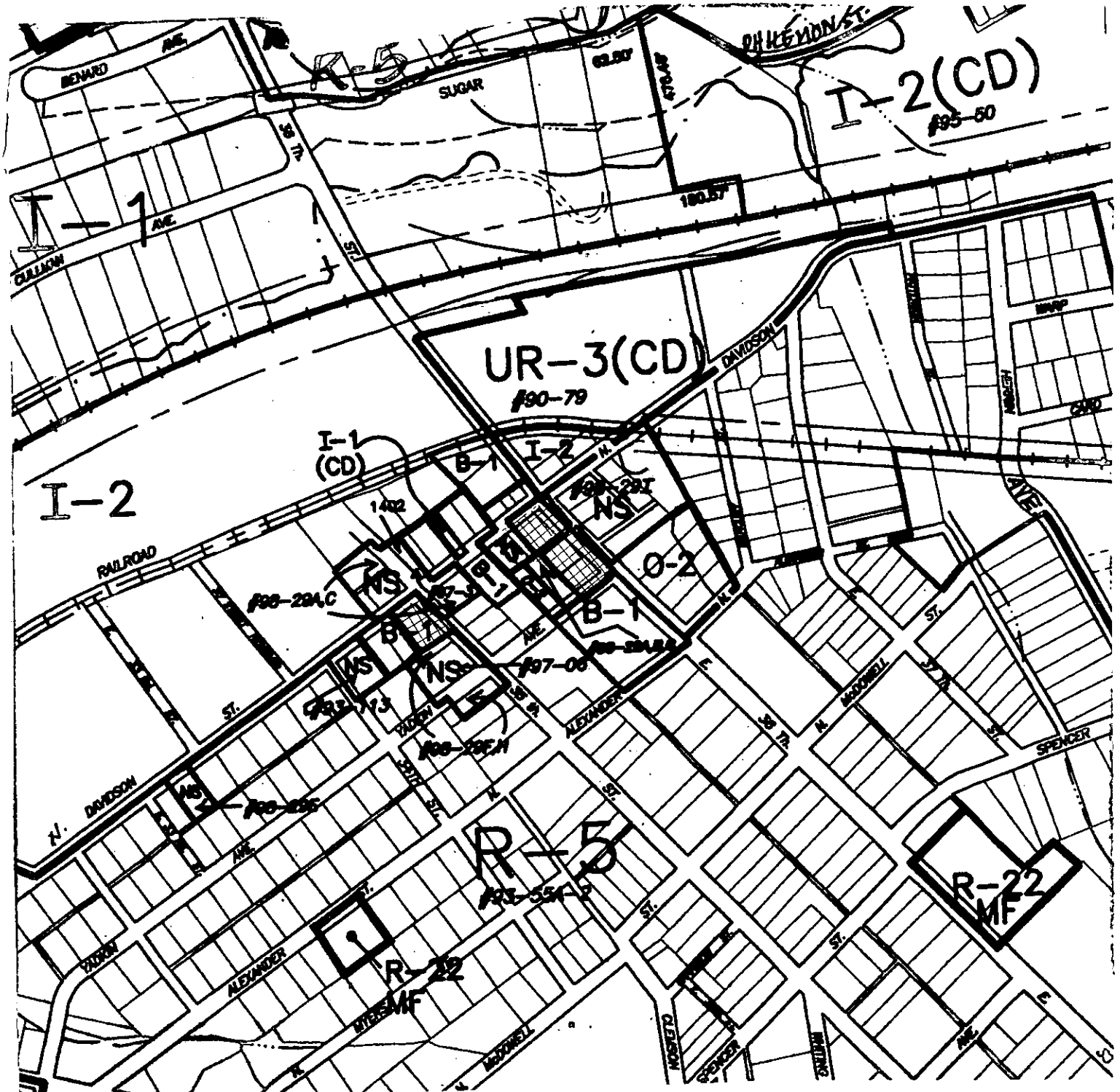

Zoning Map #(s): 89

Scale: 1" = 400 feet

MECKLENBURG COUNTY, NC GIS PUBLIC ACCESS SYSTEM

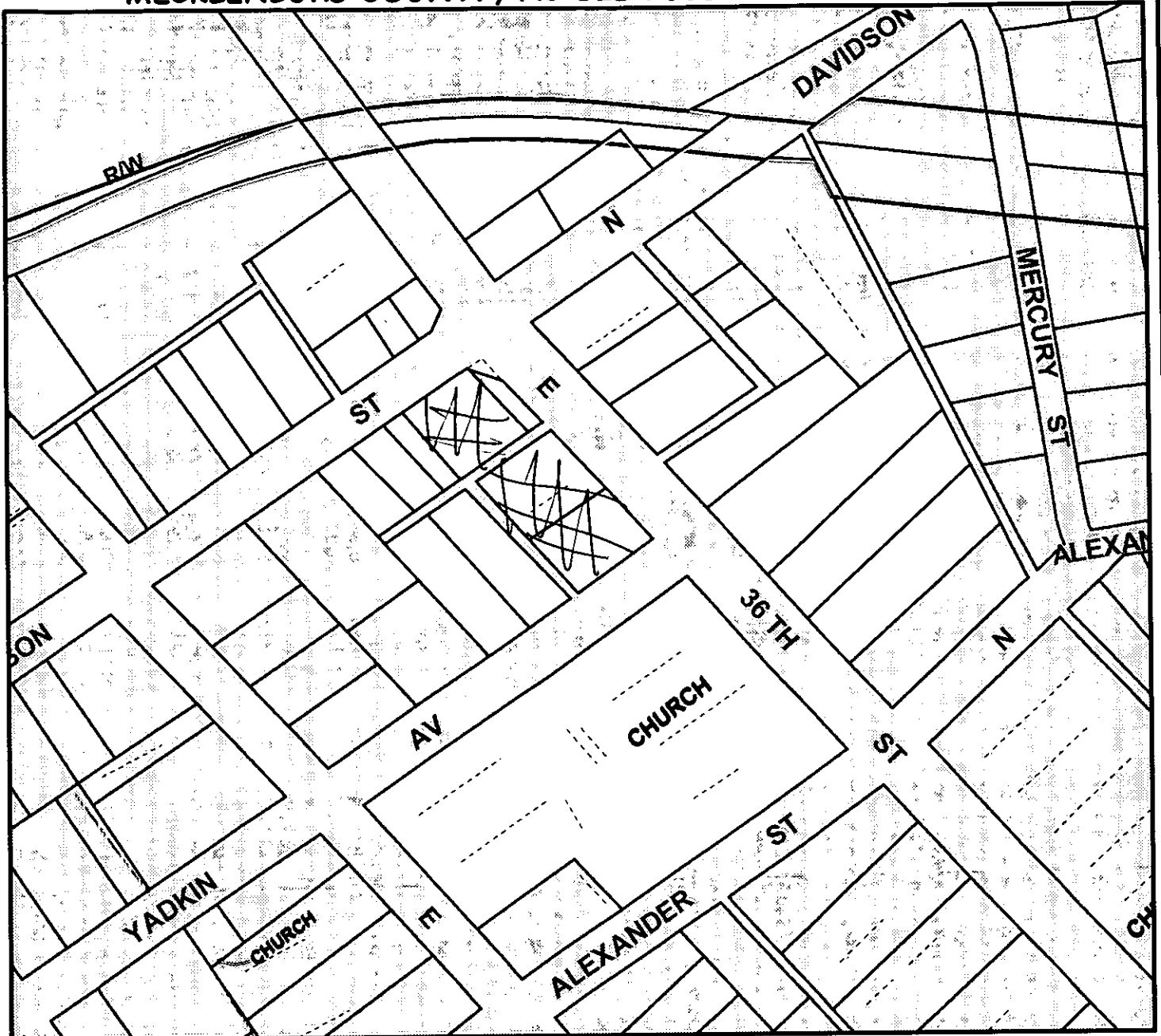

Tax Parcel-Id#s Selected: See Tax Information Report for List of Parcel-Id#s

Tax Book & Page Selected: NA

00-56

LEGEND

- Parcel/Ownership
- Right-of-Way
- Utility PCN
- Utility PCN
- Asst Parcel Line
- Right of PCN
- Water Bodies
- Jurisdiction
- Charlotte
- Davidson
- Carrboro
- Pineville
- Winterville
- Waxhills
- West 102
- Tr 1 Parcel

Rechecked 8-28-00

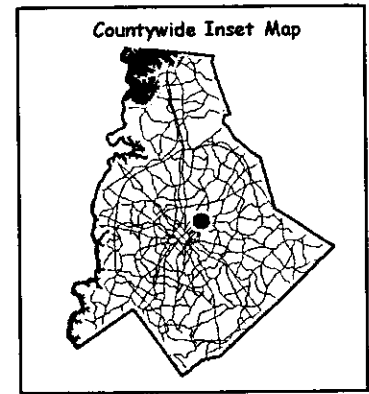
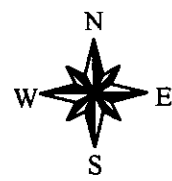

Scale: 1 Inch = 200 Feet

Map Created on Tuesday, July 18, 2000 02:20 PM

This map is prepared for the inventory of real property within Mecklenburg County and is compiled from recorded deeds, plats, tax maps, surveys, planimetric maps, and other public records and data. Users of this map are hereby notified that the aforementioned public primary information sources should be consulted for verification. Mecklenburg County and its mapping contractors assume no legal responsibility for the information contained herein.