



\* 0 0 B R E A K 0 0 \*



**ADVANCED  
IMAGING  
SYSTEMS**

www.aisimc.com

An Information  
Management Company

# City of Charlotte – Planning Dept. Scanning Rezoning Files

Petition # \_\_\_\_\_

## Document type:

- Applications
- Correspondence
- Department Comments
- Land Use Consistency
  - Mail Info
  - Mapping
  - Other
- Site Plans



\* 0 0 B R E A K 0 0 \*

# MECKLENBURG COUNTY, NC GIS PUBLIC ACCESS SYSTEM

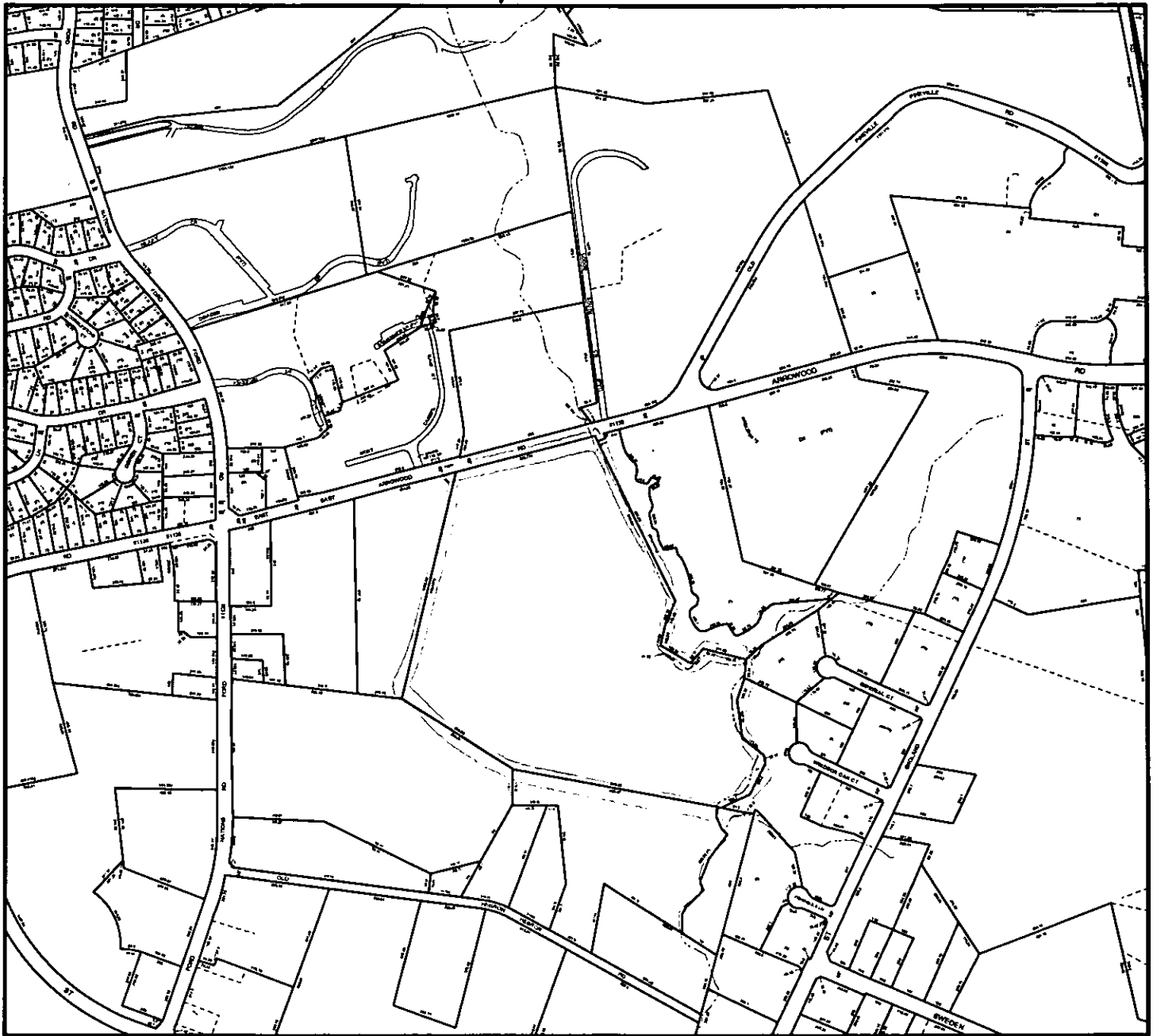

Tax Parcel-Id#s Selected: See Tax Information Report for List of Parcel-Id#s

Tax Book & Page Selected: N/A

## LEGEND

- County Boundary
- Rivers/Creeks/Streams
- Railroad ROW
- Water Bodies
- Jurisdictions**
- County
- Charlotte
- Cornelius
- Davidson
- Huntersville
- Matthews
- Mint Hill
- Pineville



## Countywide Inset Map



Scale : 1 Inch = 750 Feet

Map Created on Monday, April 8, 2002 12:28 PM

This map is prepared for the inventory of real property within Mecklenburg County and is compiled from recorded deeds, plats, tax maps, surveys, planimetric maps, and other public records and data. Users of this map are hereby notified that the aforementioned public primary information sources should be consulted for verification. Mecklenburg County and its mapping contractors assume no legal responsibility for the information contained herein.



# MECKLENBURG COUNTY, NC

DATE PRINTED

## GIS PUBLIC ACCESS SYSTEM REPORT

Note : Records are sorted in Parcel Number order.

PAGE : 1

**Record No.:** 1      **BUILDING KEY NUMBER :** 16924103 001

**PARCEL-ID :** 16924103      **NEIGHBORHOOD CODE :** 16901      **ZONING CLASS :** R12MF

**OWNER'S NAME :** ARROWOOD COMPANY LIMITED      **PARTNERSHIP**

**MAILING ADDRESS :** 7200 STONEHENGE DR STE 211

**CITY :** RALEIGH      **STATE :** NC      **ZIP CODE :** 276131620

**PROPERTY LOCATION :** E ARROWOOD      RE

**LEGAL DESC. :** NA      **DEED BK,PG & DATE :** 08870 /944 1996-12-23

**ACREAGE :** 15.000      **SALE PRICE :** \$425,000      **QUALIFIED SALE (Y/N) :** Y

**LAND VALUE :** \$405,430      **IMPVMTS VALUE :** \$5,852,020      **TOTAL VALUE :** \$6,257,450

**LAND-USE TYPE :** APARTMENT      **BUILDING TYPE :** GARDEN APARTMENT

**YEAR BUILT :** 2,001      **SQUARE FEET :** 10,288      **STYLE CODE :** 2.5 STORIES OR MORE

**BEDROOMS :** 0      **BATHROOMS :** 0      **RESTROOMS :** 0      **BASEMENT :** N      **GARAGE :** N

**EXTERIOR TYPE :** ALUMINUM/VINYL SIDING      **QUALITY GRADE :** 2      **IMPVMT. VALUE :** \$439,250

**A/C :** CENTRAL      **FIREPLACE :** NONE

**Record No.:** 2      **BUILDING KEY NUMBER :** 16924103 002

**PARCEL-ID :** 16924103      **NEIGHBORHOOD CODE :** 16901      **ZONING CLASS :** R12MF

**OWNER'S NAME :** ARROWOOD COMPANY LIMITED      **PARTNERSHIP**

**MAILING ADDRESS :** 7200 STONEHENGE DR STE 211

**CITY :** RALEIGH      **STATE :** NC      **ZIP CODE :** 276131620

**PROPERTY LOCATION :** 8929 MONT CARMEL      LN

**LEGAL DESC. :** NA      **DEED BK,PG & DATE :** 08870 /944 1996-12-23

**ACREAGE :** 15.000      **SALE PRICE :** \$425,000      **QUALIFIED SALE (Y/N) :** Y

**LAND VALUE :** \$405,430      **IMPVMTS VALUE :** \$5,852,020      **TOTAL VALUE :** \$6,257,450

**LAND-USE TYPE :** APARTMENT      **BUILDING TYPE :** GARDEN APARTMENT

**YEAR BUILT :** 2,001      **SQUARE FEET :** 7,940      **STYLE CODE :** 2.0 STORIES

**BEDROOMS :** 0      **BATHROOMS :** 0      **RESTROOMS :** 0      **BASEMENT :** N      **GARAGE :** N

**EXTERIOR TYPE :** ALUMINUM/VINYL SIDING      **QUALITY GRADE :** 2      **IMPVMT. VALUE :** \$339,410

**A/C :** CENTRAL      **FIREPLACE :** NONE

**Record No.:** 3      **BUILDING KEY NUMBER :** 16924103 003

**PARCEL-ID :** 16924103      **NEIGHBORHOOD CODE :** 16901      **ZONING CLASS :** R12MF

**OWNER'S NAME :** ARROWOOD COMPANY LIMITED      **PARTNERSHIP**

**MAILING ADDRESS :** 7200 STONEHENGE DR STE 211

**CITY :** RALEIGH      **STATE :** NC      **ZIP CODE :** 276131620

**PROPERTY LOCATION :** 8909 MONT CARMEL      LN

**LEGAL DESC. :** NA      **DEED BK,PG & DATE :** 08870 /944 1996-12-23

**ACREAGE :** 15.000      **SALE PRICE :** \$425,000      **QUALIFIED SALE (Y/N) :** Y

**LAND VALUE :** \$405,430      **IMPVMTS VALUE :** \$5,852,020      **TOTAL VALUE :** \$6,257,450

**LAND-USE TYPE :** APARTMENT      **BUILDING TYPE :** GARDEN APARTMENT

**YEAR BUILT :** 2,001      **SQUARE FEET :** 20,472      **STYLE CODE :** 2.5 STORIES OR MORE

**BEDROOMS :** 0      **BATHROOMS :** 0      **RESTROOMS :** 0      **BASEMENT :** N      **GARAGE :** N

**EXTERIOR TYPE :** ALUMINUM/VINYL SIDING      **QUALITY GRADE :** 2      **IMPVMT. VALUE :** \$843,820

**A/C :** CENTRAL      **FIREPLACE :** NONE

NOTE: This data is prepared for the purposes of revaluation, assessing & determining ownership of real property & is compiled from recorded deeds, plats, tax maps & other public records & data. Users of this data are hereby notified that the aforementioned public information sources should be consulted for verification. Mecklenburg County assumes no legal responsibility for the information herein.



# MECKLENBURG COUNTY, NC

DATE PRINTED

## GIS PUBLIC ACCESS SYSTEM REPORT

Note : Records are sorted in Parcel Number order.

PAGE : 2

**Record No.:** 4      **BUILDING KEY NUMBER :** 16924103 004  
**PARCEL-ID :** 16924103      **NEIGHBORHOOD CODE :** 16901      **ZONING CLASS :** R12MF  
**OWNER'S NAME :** ARROWOOD COMPANY LIMITED      **PARTNERSHIP**  
**MAILING ADDRESS :** 7200 STONEHENGE DR STE 211  
**CITY :** RALEIGH      **STATE :** NC      **ZIP CODE :** 276131620

**PROPERTY LOCATION :** 8918      **MONT CARMEL**      **LN**  
**LEGAL DESC. :** NA      **DEED BK,PG & DATE :** 08870 /944 1996-12-23  
**ACREAGE :** 15.000      **SALE PRICE :** \$425,000      **QUALIFIED SALE (Y/N) :** Y  
**LAND VALUE :** \$405,430      **IMPVMTS VALUE :** \$5,852,020      **TOTAL VALUE :** \$6,257,450

**LAND-USE TYPE :** APARTMENT      **BUILDING TYPE :** GARDEN APARTMENT  
**YEAR BUILT :** 2,001      **SQUARE FEET :** 11,910      **STYLE CODE :** 2.5 STORIES OR MORE  
**BEDROOMS :** 0      **BATHROOMS :** 0      **RESTROOMS :** 0      **BASEMENT :** N      **GARAGE :** N  
**EXTERIOR TYPE :** ALUMINUM/VINYL SIDING      **QUALITY GRADE :** 2      **IMPVMT. VALUE :** \$502,080  
**A/C :** CENTRAL      **FIREPLACE :** NONE

**Record No.:** 5      **BUILDING KEY NUMBER :** 16924103 005  
**PARCEL-ID :** 16924103      **NEIGHBORHOOD CODE :** 16901      **ZONING CLASS :** R12MF  
**OWNER'S NAME :** ARROWOOD COMPANY LIMITED      **PARTNERSHIP**  
**MAILING ADDRESS :** 7200 STONEHENGE DR STE 211  
**CITY :** RALEIGH      **STATE :** NC      **ZIP CODE :** 276131620

**PROPERTY LOCATION :** 8910      **MONT CARMEL**      **LN**  
**LEGAL DESC. :** NA      **DEED BK,PG & DATE :** 08870 /944 1996-12-23  
**ACREAGE :** 15.000      **SALE PRICE :** \$425,000      **QUALIFIED SALE (Y/N) :** Y  
**LAND VALUE :** \$405,430      **IMPVMTS VALUE :** \$5,852,020      **TOTAL VALUE :** \$6,257,450

**LAND-USE TYPE :** APARTMENT      **BUILDING TYPE :** GARDEN APARTMENT  
**YEAR BUILT :** 2,001      **SQUARE FEET :** 14,088      **STYLE CODE :** 2.5 STORIES OR MORE  
**BEDROOMS :** 0      **BATHROOMS :** 0      **RESTROOMS :** 0      **BASEMENT :** N      **GARAGE :** N  
**EXTERIOR TYPE :** ALUMINUM/VINYL SIDING      **QUALITY GRADE :** 2      **IMPVMT. VALUE :** \$585,030  
**A/C :** CENTRAL      **FIREPLACE :** NONE

**Record No.:** 6      **BUILDING KEY NUMBER :** 16924103 006  
**PARCEL-ID :** 16924103      **NEIGHBORHOOD CODE :** 16901      **ZONING CLASS :** R12MF  
**OWNER'S NAME :** ARROWOOD COMPANY LIMITED      **PARTNERSHIP**  
**MAILING ADDRESS :** 7200 STONEHENGE DR STE 211  
**CITY :** RALEIGH      **STATE :** NC      **ZIP CODE :** 276131620

**PROPERTY LOCATION :** 8820      **MONT CARMEL**      **LN**  
**LEGAL DESC. :** NA      **DEED BK,PG & DATE :** 08870 /944 1996-12-23  
**ACREAGE :** 15.000      **SALE PRICE :** \$425,000      **QUALIFIED SALE (Y/N) :** Y  
**LAND VALUE :** \$405,430      **IMPVMTS VALUE :** \$5,852,020      **TOTAL VALUE :** \$6,257,450

**LAND-USE TYPE :** APARTMENT      **BUILDING TYPE :** GARDEN APARTMENT  
**YEAR BUILT :** 2,001      **SQUARE FEET :** 14,088      **STYLE CODE :** 2.5 STORIES OR MORE  
**BEDROOMS :** 0      **BATHROOMS :** 0      **RESTROOMS :** 0      **BASEMENT :** N      **GARAGE :** N  
**EXTERIOR TYPE :** ALUMINUM/VINYL SIDING      **QUALITY GRADE :** 2      **IMPVMT. VALUE :** \$585,030  
**A/C :** CENTRAL      **FIREPLACE :** NONE

NOTE: This data is prepared for the purposes of revaluation, assessing & determining ownership of real property & is compiled from recorded deeds, plats, tax maps & other public records & data. Users of this data are hereby notified that the aforementioned public information sources should be consulted for verification. Mecklenburg County assumes no legal responsibility for the information herein.



# MECKLENBURG COUNTY, NC

DATE PRINTED

## GIS PUBLIC ACCESS SYSTEM REPORT

Note : Records are sorted in Parcel Number order.

PAGE : 3

**Record No.:** 7      **BUILDING KEY NUMBER :** 16924103 007

**PARCEL-ID :** 16924103      **NEIGHBORHOOD CODE :** 16901      **ZONING CLASS :** R12MF

**OWNER'S NAME :** ARROWOOD COMPANY LIMITED      **PARTNERSHIP**

**MAILING ADDRESS :** 7200 STONEHENGE DR STE 211

**CITY :** RALEIGH      **STATE :** NC      **ZIP CODE :** 276131620

**PROPERTY LOCATION :** 8810      MONT CARMEL      LN

**LEGAL DESC. :** NA      **DEED BK,PG & DATE :** 08870 /944 1996-12-23

**ACREAGE :** 15.000      **SALE PRICE :** \$425,000      **QUALIFIED SALE (Y/N) :** Y

**LAND VALUE :** \$405,430      **IMPVMTS VALUE :** \$5,852,020      **TOTAL VALUE :** \$6,257,450

**LAND-USE TYPE :** APARTMENT      **BUILDING TYPE :** GARDEN APARTMENT

**YEAR BUILT :** 2,001      **SQUARE FEET :** 11,910      **STYLE CODE :** 2.5 STORIES OR MORE

**BEDROOMS :** 0      **BATHROOMS :** 0      **RESTROOMS :** 0      **BASEMENT :** N      **GARAGE :** N

**EXTERIOR TYPE :** ALUMINUM/VINYL SIDING      **QUALITY GRADE :** 2      **IMPVMT. VALUE :** \$502,080

**A/C :** CENTRAL      **FIREPLACE :** NONE

**Record No.:** 8      **BUILDING KEY NUMBER :** 16924103 008

**PARCEL-ID :** 16924103      **NEIGHBORHOOD CODE :** 16901      **ZONING CLASS :** R12MF

**OWNER'S NAME :** ARROWOOD COMPANY LIMITED      **PARTNERSHIP**

**MAILING ADDRESS :** 7200 STONEHENGE DR STE 211

**CITY :** RALEIGH      **STATE :** NC      **ZIP CODE :** 276131620

**PROPERTY LOCATION :** 425      BRANCHVIEW      DR

**LEGAL DESC. :** NA      **DEED BK,PG & DATE :** 08870 /944 1996-12-23

**ACREAGE :** 15.000      **SALE PRICE :** \$425,000      **QUALIFIED SALE (Y/N) :** Y

**LAND VALUE :** \$405,430      **IMPVMTS VALUE :** \$5,852,020      **TOTAL VALUE :** \$6,257,450

**LAND-USE TYPE :** APARTMENT      **BUILDING TYPE :** GARDEN APARTMENT

**YEAR BUILT :** 2,001      **SQUARE FEET :** 20,472      **STYLE CODE :** 2.5 STORIES OR MORE

**BEDROOMS :** 0      **BATHROOMS :** 0      **RESTROOMS :** 0      **BASEMENT :** N      **GARAGE :** N

**EXTERIOR TYPE :** ALUMINUM/VINYL SIDING      **QUALITY GRADE :** 2      **IMPVMT. VALUE :** \$843,820

**A/C :** CENTRAL      **FIREPLACE :** NONE

**Record No.:** 9      **BUILDING KEY NUMBER :** 16924103 009

**PARCEL-ID :** 16924103      **NEIGHBORHOOD CODE :** 16901      **ZONING CLASS :** R12MF

**OWNER'S NAME :** ARROWOOD COMPANY LIMITED      **PARTNERSHIP**

**MAILING ADDRESS :** 7200 STONEHENGE DR STE 211

**CITY :** RALEIGH      **STATE :** NC      **ZIP CODE :** 276131620

**PROPERTY LOCATION :** 426      BRANCHVIEW      DR

**LEGAL DESC. :** NA      **DEED BK,PG & DATE :** 08870 /944 1996-12-23

**ACREAGE :** 15.000      **SALE PRICE :** \$425,000      **QUALIFIED SALE (Y/N) :** Y

**LAND VALUE :** \$405,430      **IMPVMTS VALUE :** \$5,852,020      **TOTAL VALUE :** \$6,257,450

**LAND-USE TYPE :** APARTMENT      **BUILDING TYPE :** GARDEN APARTMENT

**YEAR BUILT :** 2,001      **SQUARE FEET :** 20,472      **STYLE CODE :** 2.5 STORIES OR MORE

**BEDROOMS :** 0      **BATHROOMS :** 0      **RESTROOMS :** 0      **BASEMENT :** N      **GARAGE :** N

**EXTERIOR TYPE :** ALUMINUM/VINYL SIDING      **QUALITY GRADE :** 2      **IMPVMT. VALUE :** \$843,820

**A/C :** CENTRAL      **FIREPLACE :** NONE

NOTE: This data is prepared for the purposes of revaluation, assessing & determining ownership of real property & is compiled from recorded deeds, plats, tax maps & other public records & data. Users of this data are hereby notified that the aforementioned public information sources should be consulted for verification. Mecklenburg County assumes no legal responsibility for the information herein.



# MECKLENBURG COUNTY, NC

DATE PRINTED

## GIS PUBLIC ACCESS SYSTEM REPORT

Note : Records are sorted in Parcel Number order.

PAGE : 4

**Record No.:** 10      **BUILDING KEY NUMBER :** 16924103 010  
**PARCEL-ID :** 16924103      **NEIGHBORHOOD CODE :** 16901      **ZONING CLASS :** R12MF  
**OWNER'S NAME :** ARROWOOD COMPANY LIMITED      **PARTNERSHIP**  
**MAILING ADDRESS :** 7200 STONEHENGE DR STE 211  
**CITY :** RALEIGH      **STATE :** NC      **ZIP CODE :** 276131620

**PROPERTY LOCATION :** 8825      **MONT CARMEL**      **LN**  
**LEGAL DESC. :** NA      **DEED BK,PG & DATE :** 08870 /944 1996-12-23  
**ACREAGE :** 15.000      **SALE PRICE :** \$425,000      **QUALIFIED SALE (Y/N) :** Y  
**LAND VALUE :** \$405,430      **IMPVMTS VALUE :** \$5,852,020      **TOTAL VALUE :** \$6,257,450

**LAND-USE TYPE :** COMMERCIAL      **BUILDING TYPE :** CLUB-LODGE  
**YEAR BUILT :** 2,001      **SQUARE FEET :** 1,820      **STYLE CODE :** 1.0 STORY  
**BEDROOMS :** 0      **BATHROOMS :** 0      **RESTROOMS :** 0      **BASEMENT :** N      **GARAGE :** N  
**EXTERIOR TYPE :** ALUMINUM/VINYL SIDING      **QUALITY GRADE :** 2      **IMPVMT. VALUE :** \$121,210  
**A/C :** CENTRAL      **FIREPLACE :** PREFAB

**Record No.:** 11      **BUILDING KEY NUMBER :** 16924104 001  
**PARCEL-ID :** 16924104      **NEIGHBORHOOD CODE :** 16901      **ZONING CLASS :** R4  
**OWNER'S NAME :** B P O E LODGE # 392      **TRUSTEES**  
**MAILING ADDRESS :** 401 E ARROWOOD RD  
**CITY :** CHARLOTTE      **STATE :** NC      **ZIP CODE :** 28210

**PROPERTY LOCATION :** 401      **E ARROWOOD**      **RE**  
**LEGAL DESC. :** M O & D BK8-17      **DEED BK,PG & DATE :** 03510 /047 1973-02-01  
**ACREAGE :** 9.000      **SALE PRICE :** \$0      **QUALIFIED SALE (Y/N) :** N  
**LAND VALUE :** \$112,500      **IMPVMTS VALUE :** \$362,760      **TOTAL VALUE :** \$475,260

**LAND-USE TYPE :** COMMERCIAL      **BUILDING TYPE :** CLUB-LODGE  
**YEAR BUILT :** 1,973      **SQUARE FEET :** 7,360      **STYLE CODE :** 1.0 STORY  
**BEDROOMS :** 0      **BATHROOMS :** 0      **RESTROOMS :** 0      **BASEMENT :** N      **GARAGE :** N  
**EXTERIOR TYPE :** COMMON BRICK      **QUALITY GRADE :** 3      **IMPVMT. VALUE :** \$316,420  
**A/C :** CENTRAL      **FIREPLACE :** NONE

**Record No.:** 12      **BUILDING KEY NUMBER :** 16924105 001  
**PARCEL-ID :** 16924105      **NEIGHBORHOOD CODE :** 16901      **ZONING CLASS :** R12MF  
**OWNER'S NAME :** WXI/MCN MULTIFAMILY R/E LP  
**MAILING ADDRESS :** PO BOX 81290  
**CITY :** CHICAGO      **STATE :** IL      **ZIP CODE :** 606810290

**PROPERTY LOCATION :** 8925      **LODGE SOUTH**      **CR**  
**LEGAL DESC. :** NA      **DEED BK,PG & DATE :** 11080 /176 2000-02-10  
**ACREAGE :** 26.000      **SALE PRICE :** \$0      **QUALIFIED SALE (Y/N) :**  
**LAND VALUE :** \$846,810      **IMPVMTS VALUE :** \$7,706,120      **TOTAL VALUE :** \$8,552,930

**LAND-USE TYPE :** APARTMENT      **BUILDING TYPE :** GARDEN APARTMENT  
**YEAR BUILT :** 1,974      **SQUARE FEET :** 12,672      **STYLE CODE :** 2.0 STORIES  
**BEDROOMS :** 0      **BATHROOMS :** 0      **RESTROOMS :** 0      **BASEMENT :** N      **GARAGE :** N  
**EXTERIOR TYPE :** WOOD ON SHEATHING OR PLYWO      **QUALITY GRADE :** 2      **IMPVMT. VALUE :** \$291,960  
**A/C :** CENTRAL      **FIREPLACE :** NONE

NOTE: This data is prepared for the purposes of revaluation, assessing & determining ownership of real property & is compiled from recorded deeds, plat tax maps & other public records & lists. List of the data are hereby notified that the above mentioned public information is subject to the applicable laws, regulations, policies, procedures, and other information of the information system.



# MECKLENBURG COUNTY, NC

DATE PRINTED

## GIS PUBLIC ACCESS SYSTEM REPORT

Note : Records are sorted in Parcel Number order.

PAGE : 5

**Record No.:** 13      **BUILDING KEY NUMBER :** 16924105 002  
**PARCEL-ID :** 16924105      **NEIGHBORHOOD CODE :** 16901      **ZONING CLASS :** R12MF  
**OWNER'S NAME :** WXI/MCN MULTIFAMILY R/E LP  
**MAILING ADDRESS :** PO BOX 81290  
**CITY :** CHICAGO      **STATE :** IL      **ZIP CODE :** 606810290

**PROPERTY LOCATION :** 8520      **LODGE SOUTH**      **CR**  
**LEGAL DESC. :** NA      **DEED BK,PG & DATE :** 11080 /176 2000-02-10  
**ACREAGE :** 26.000      **SALE PRICE :** \$0      **QUALIFIED SALE (Y/N) :**  
**LAND VALUE :** \$846,810      **IMPVMTS VALUE :** \$7,706,120      **TOTAL VALUE :** \$8,552,930

**LAND-USE TYPE :** APARTMENT      **BUILDING TYPE :** GARDEN APARTMENT  
**YEAR BUILT :** 1,974      **SQUARE FEET :** 11,996      **STYLE CODE :** 2.0 STORIES  
**BEDROOMS :** 0      **BATHROOMS :** 0      **RESTROOMS :** 0      **BASEMENT :** N      **GARAGE :** N  
**EXTERIOR TYPE :** WOOD ON SHEATHING OR PLYWO      **QUALITY GRADE :** 2      **IMPVMT. VALUE :** \$276,390  
**A/C :** CENTRAL      **FIREPLACE :** NONE

**Record No.:** 14      **BUILDING KEY NUMBER :** 16924105 003  
**PARCEL-ID :** 16924105      **NEIGHBORHOOD CODE :** 16901      **ZONING CLASS :** R12MF  
**OWNER'S NAME :** WXI/MCN MULTIFAMILY R/E LP  
**MAILING ADDRESS :** PO BOX 81290  
**CITY :** CHICAGO      **STATE :** IL      **ZIP CODE :** 606810290

**PROPERTY LOCATION :** 8528      **LODGE SOUTH**      **CR**  
**LEGAL DESC. :** NA      **DEED BK,PG & DATE :** 11080 /176 2000-02-10  
**ACREAGE :** 26.000      **SALE PRICE :** \$0      **QUALIFIED SALE (Y/N) :**  
**LAND VALUE :** \$846,810      **IMPVMTS VALUE :** \$7,706,120      **TOTAL VALUE :** \$8,552,930

**LAND-USE TYPE :** APARTMENT      **BUILDING TYPE :** GARDEN APARTMENT  
**YEAR BUILT :** 1,974      **SQUARE FEET :** 1,824      **STYLE CODE :** 2.0 STORIES  
**BEDROOMS :** 0      **BATHROOMS :** 0      **RESTROOMS :** 0      **BASEMENT :** N      **GARAGE :** N  
**EXTERIOR TYPE :** WOOD ON SHEATHING OR PLYWO      **QUALITY GRADE :** 2      **IMPVMT. VALUE :** \$55,810  
**A/C :** CENTRAL      **FIREPLACE :** NONE

**Record No.:** 15      **BUILDING KEY NUMBER :** 16924105 004  
**PARCEL-ID :** 16924105      **NEIGHBORHOOD CODE :** 16901      **ZONING CLASS :** R12MF  
**OWNER'S NAME :** WXI/MCN MULTIFAMILY R/E LP  
**MAILING ADDRESS :** PO BOX 81290  
**CITY :** CHICAGO      **STATE :** IL      **ZIP CODE :** 606810290

**PROPERTY LOCATION :** 8534      **LODGE SOUTH**      **CR**  
**LEGAL DESC. :** NA      **DEED BK,PG & DATE :** 11080 /176 2000-02-10  
**ACREAGE :** 26.000      **SALE PRICE :** \$0      **QUALIFIED SALE (Y/N) :**  
**LAND VALUE :** \$846,810      **IMPVMTS VALUE :** \$7,706,120      **TOTAL VALUE :** \$8,552,930

**LAND-USE TYPE :** APARTMENT      **BUILDING TYPE :** GARDEN APARTMENT  
**YEAR BUILT :** 1,974      **SQUARE FEET :** 12,646      **STYLE CODE :** 2.0 STORIES  
**BEDROOMS :** 0      **BATHROOMS :** 0      **RESTROOMS :** 0      **BASEMENT :** N      **GARAGE :** N  
**EXTERIOR TYPE :** WOOD ON SHEATHING OR PLYWO      **QUALITY GRADE :** 2      **IMPVMT. VALUE :** \$276,390  
**A/C :** CENTRAL      **FIREPLACE :** NONE

NOTE: This data is presented for the purpose of providing a general overview of the information contained in the public access system. It is not intended to be used as a legal document. For more information, please contact the Mecklenburg County GIS Department at (704) 273-1111.



# MECKLENBURG COUNTY, NC

DATE PRINTED

## GIS PUBLIC ACCESS SYSTEM REPORT

Note : Records are sorted in Parcel Number order.

PAGE : 6

**Record No.:** 16      **BUILDING KEY NUMBER :** 16924105 005  
**PARCEL-ID :** 16924105      **NEIGHBORHOOD CODE :** 16901      **ZONING CLASS :** R12MF  
**OWNER'S NAME :** WXI/MCN MULTIFAMILY R/E LP  
**MAILING ADDRESS :** PO BOX 81290  
**CITY :** CHICAGO      **STATE :** IL      **ZIP CODE :** 606810290

**PROPERTY LOCATION :** 8540      **LODGE SOUTH**      **CR**  
**LEGAL DESC. :** NA      **DEED BK,PG & DATE :** 11080 /176 2000-02-10  
**ACREAGE :** 26.000      **SALE PRICE :** \$0      **QUALIFIED SALE (Y/N) :**  
**LAND VALUE :** \$846,810      **IMPVMTS VALUE :** \$7,706,120      **TOTAL VALUE :** \$8,552,930

**LAND-USE TYPE :** APARTMENT      **BUILDING TYPE :** GARDEN APARTMENT  
**YEAR BUILT :** 1,974      **SQUARE FEET :** 13,296      **STYLE CODE :** 2.0 STORIES  
**BEDROOMS :** 0      **BATHROOMS :** 0      **RESTROOMS :** 0      **BASEMENT :** N      **GARAGE :** N  
**EXTERIOR TYPE :** WOOD ON SHEATHING OR PLYWO      **QUALITY GRADE :** 2      **IMPVMT. VALUE :** \$313,150  
**A/C :** CENTRAL      **FIREPLACE :** NONE

**Record No.:** 17      **BUILDING KEY NUMBER :** 16924105 006  
**PARCEL-ID :** 16924105      **NEIGHBORHOOD CODE :** 16901      **ZONING CLASS :** R12MF  
**OWNER'S NAME :** WXI/MCN MULTIFAMILY R/E LP  
**MAILING ADDRESS :** PO BOX 81290  
**CITY :** CHICAGO      **STATE :** IL      **ZIP CODE :** 606810290

**PROPERTY LOCATION :** 8601      **LODGE SOUTH**      **CR**  
**LEGAL DESC. :** NA      **DEED BK,PG & DATE :** 11080 /176 2000-02-10  
**ACREAGE :** 26.000      **SALE PRICE :** \$0      **QUALIFIED SALE (Y/N) :**  
**LAND VALUE :** \$846,810      **IMPVMTS VALUE :** \$7,706,120      **TOTAL VALUE :** \$8,552,930

**LAND-USE TYPE :** COMMERCIAL      **BUILDING TYPE :** CLUB-LODGE  
**YEAR BUILT :** 1,974      **SQUARE FEET :** 3,479      **STYLE CODE :** 2.0 STORIES  
**BEDROOMS :** 0      **BATHROOMS :** 0      **RESTROOMS :** 2      **BASEMENT :** N      **GARAGE :** N  
**EXTERIOR TYPE :** WOOD ON SHEATHING OR PLYWO      **QUALITY GRADE :** 2      **IMPVMT. VALUE :** \$155,250  
**A/C :** CENTRAL      **FIREPLACE :** NONE

**Record No.:** 18      **BUILDING KEY NUMBER :** 16924105 007  
**PARCEL-ID :** 16924105      **NEIGHBORHOOD CODE :** 16901      **ZONING CLASS :** R12MF  
**OWNER'S NAME :** WXI/MCN MULTIFAMILY R/E LP  
**MAILING ADDRESS :** PO BOX 81290  
**CITY :** CHICAGO      **STATE :** IL      **ZIP CODE :** 606810290

**PROPERTY LOCATION :** 8829      **LODGE SOUTH**      **CR**  
**LEGAL DESC. :** NA      **DEED BK,PG & DATE :** 11080 /176 2000-02-10  
**ACREAGE :** 26.000      **SALE PRICE :** \$0      **QUALIFIED SALE (Y/N) :**  
**LAND VALUE :** \$846,810      **IMPVMTS VALUE :** \$7,706,120      **TOTAL VALUE :** \$8,552,930

**LAND-USE TYPE :** APARTMENT      **BUILDING TYPE :** GARDEN APARTMENT  
**YEAR BUILT :** 1,974      **SQUARE FEET :** 12,672      **STYLE CODE :** 2.0 STORIES  
**BEDROOMS :** 0      **BATHROOMS :** 0      **RESTROOMS :** 0      **BASEMENT :** N      **GARAGE :** N  
**EXTERIOR TYPE :** WOOD ON SHEATHING OR PLYWO      **QUALITY GRADE :** 2      **IMPVMT. VALUE :** \$291,960  
**A/C :** CENTRAL      **FIREPLACE :** NONE

NOTICE: This data is provided for informational purposes only. It is not intended to be used for legal or financial purposes. The information is provided as is, without warranty. The user assumes all responsibility for any errors or omissions. The information is subject to change without notice.





# MECKLENBURG COUNTY, NC

DATE PRINTED

## GIS PUBLIC ACCESS SYSTEM REPORT

Note : Records are sorted in Parcel Number order.

PAGE : 7

**Record No.:** 19      **BUILDING KEY NUMBER :** 16924105 008  
**PARCEL-ID :** 16924105      **NEIGHBORHOOD CODE :** 16901      **ZONING CLASS :** R12MF  
**OWNER'S NAME :** WXI/MCN MULTIFAMILY R/E LP  
**MAILING ADDRESS :** PO BOX 81290  
**CITY :** CHICAGO      **STATE :** IL      **ZIP CODE :** 606810290

**PROPERTY LOCATION :** 8901      **LODGE SOUTH**      **CR**  
**LEGAL DESC. :** NA      **DEED BK,PG & DATE :** 11080 /176 2000-02-10  
**ACREAGE :** 26.000      **SALE PRICE :** \$0      **QUALIFIED SALE (Y/N) :**  
**LAND VALUE :** \$846,810      **IMPVMTS VALUE :** \$7,706,120      **TOTAL VALUE :** \$8,552,930

**LAND-USE TYPE :** APARTMENT      **BUILDING TYPE :** GARDEN APARTMENT  
**YEAR BUILT :** 1,974      **SQUARE FEET :** 10,456      **STYLE CODE :** 2.0 STORIES  
**BEDROOMS :** 0      **BATHROOMS :** 0      **RESTROOMS :** 0      **BASEMENT :** N      **GARAGE :** N  
**EXTERIOR TYPE :** WOOD ON SHEATHING OR PLYWO      **QUALITY GRADE :** 2      **IMPVMT. VALUE :** \$300,670  
**A/C :** CENTRAL      **FIREPLACE :** NONE

**Record No.:** 20      **BUILDING KEY NUMBER :** 16924105 009  
**PARCEL-ID :** 16924105      **NEIGHBORHOOD CODE :** 16901      **ZONING CLASS :** R12MF  
**OWNER'S NAME :** WXI/MCN MULTIFAMILY R/E LP  
**MAILING ADDRESS :** PO BOX 81290  
**CITY :** CHICAGO      **STATE :** IL      **ZIP CODE :** 606810290

**PROPERTY LOCATION :** 441      **E ARROWOOD**      **RC**  
**LEGAL DESC. :** NA      **DEED BK,PG & DATE :** 11080 /176 2000-02-10  
**ACREAGE :** 26.000      **SALE PRICE :** \$0      **QUALIFIED SALE (Y/N) :**  
**LAND VALUE :** \$846,810      **IMPVMTS VALUE :** \$7,706,120      **TOTAL VALUE :** \$8,552,930

**LAND-USE TYPE :** APARTMENT      **BUILDING TYPE :** GARDEN APARTMENT  
**YEAR BUILT :** 1,979      **SQUARE FEET :** 5,040      **STYLE CODE :** 2.0 STORIES  
**BEDROOMS :** 0      **BATHROOMS :** 0      **RESTROOMS :** 0      **BASEMENT :** N      **GARAGE :** N  
**EXTERIOR TYPE :** WOOD ON SHEATHING OR PLYWO      **QUALITY GRADE :** 2      **IMPVMT. VALUE :** \$170,210  
**A/C :** CENTRAL      **FIREPLACE :** NONE

**Record No.:** 21      **BUILDING KEY NUMBER :** 16924105 010  
**PARCEL-ID :** 16924105      **NEIGHBORHOOD CODE :** 16901      **ZONING CLASS :** R12MF  
**OWNER'S NAME :** WXI/MCN MULTIFAMILY R/E LP  
**MAILING ADDRESS :** PO BOX 81290  
**CITY :** CHICAGO      **STATE :** IL      **ZIP CODE :** 606810290

**PROPERTY LOCATION :** 411      **E ARROWOOD**      **RF**  
**LEGAL DESC. :** NA      **DEED BK,PG & DATE :** 11080 /176 2000-02-10  
**ACREAGE :** 26.000      **SALE PRICE :** \$0      **QUALIFIED SALE (Y/N) :**  
**LAND VALUE :** \$846,810      **IMPVMTS VALUE :** \$7,706,120      **TOTAL VALUE :** \$8,552,930

**LAND-USE TYPE :** APARTMENT      **BUILDING TYPE :** GARDEN APARTMENT  
**YEAR BUILT :** 1,979      **SQUARE FEET :** 5,040      **STYLE CODE :** 2.0 STORIES  
**BEDROOMS :** 0      **BATHROOMS :** 0      **RESTROOMS :** 0      **BASEMENT :** N      **GARAGE :** N  
**EXTERIOR TYPE :** WOOD ON SHEATHING OR PLYWO      **QUALITY GRADE :** 2      **IMPVMT. VALUE :** \$170,210  
**A/C :** CENTRAL      **FIREPLACE :** NONE



**MECKLENBURG COUNTY, NC**  
**GIS PUBLIC ACCESS SYSTEM REPORT**

DATE PRINTED

Note : Records are sorted in Parcel Number order.

PAGE : 8

**Record No.:** 22      **BUILDING KEY NUMBER :** 16924105 011  
**PARCEL-ID :** 16924105      **NEIGHBORHOOD CODE :** 16901      **ZONING CLASS :** R12MF  
**OWNER'S NAME :** WXI/MCN MULTIFAMILY R/E LP  
**MAILING ADDRESS :** PO BOX 81290  
**CITY :** CHICAGO      **STATE :** IL      **ZIP CODE :** 606810290

**PROPERTY LOCATION :** 441 E ARROWOOD      **RE**  
**LEGAL DESC. :** NA      **DEED BK,PG & DATE :** 11080 /176 2000-02-10  
**ACREAGE :** 26.000      **SALE PRICE :** \$0      **QUALIFIED SALE (Y/N) :**  
**LAND VALUE :** \$846,810      **IMPVMTS VALUE :** \$7,706,120      **TOTAL VALUE :** \$8,552,930

**LAND-USE TYPE :** APARTMENT      **BUILDING TYPE :** GARDEN APARTMENT  
**YEAR BUILT :** 1,979      **SQUARE FEET :** 6,876      **STYLE CODE :** 2.0 STORIES  
**BEDROOMS :** 0      **BATHROOMS :** 0      **RESTROOMS :** 0      **BASEMENT :** N      **GARAGE :** N  
**EXTERIOR TYPE :** WOOD ON SHEATHING OR PLYWO      **QUALITY GRADE :** 2      **IMPVMT. VALUE :** \$225,370  
**A/C :** CENTRAL      **FIREPLACE :** NONE

**Record No.:** 23      **BUILDING KEY NUMBER :** 16924105 012  
**PARCEL-ID :** 16924105      **NEIGHBORHOOD CODE :** 16901      **ZONING CLASS :** R12MF  
**OWNER'S NAME :** WXI/MCN MULTIFAMILY R/E LP  
**MAILING ADDRESS :** PO BOX 81290  
**CITY :** CHICAGO      **STATE :** IL      **ZIP CODE :** 606810290

**PROPERTY LOCATION :** 441 E ARROWOOD      **RE**  
**LEGAL DESC. :** NA      **DEED BK,PG & DATE :** 11080 /176 2000-02-10  
**ACREAGE :** 26.000      **SALE PRICE :** \$0      **QUALIFIED SALE (Y/N) :**  
**LAND VALUE :** \$846,810      **IMPVMTS VALUE :** \$7,706,120      **TOTAL VALUE :** \$8,552,930

**LAND-USE TYPE :** APARTMENT      **BUILDING TYPE :** GARDEN APARTMENT  
**YEAR BUILT :** 1,979      **SQUARE FEET :** 6,876      **STYLE CODE :** 2.0 STORIES  
**BEDROOMS :** 0      **BATHROOMS :** 0      **RESTROOMS :** 0      **BASEMENT :** N      **GARAGE :** N  
**EXTERIOR TYPE :** WOOD ON SHEATHING OR PLYWO      **QUALITY GRADE :** 2      **IMPVMT. VALUE :** \$225,370  
**A/C :** CENTRAL      **FIREPLACE :** NONE

**Record No.:** 24      **BUILDING KEY NUMBER :** 16924105 013  
**PARCEL-ID :** 16924105      **NEIGHBORHOOD CODE :** 16901      **ZONING CLASS :** R12MF  
**OWNER'S NAME :** WXI/MCN MULTIFAMILY R/E LP  
**MAILING ADDRESS :** PO BOX 81290  
**CITY :** CHICAGO      **STATE :** IL      **ZIP CODE :** 606810290

**PROPERTY LOCATION :** 441 E ARROWOOD      **RE**  
**LEGAL DESC. :** NA      **DEED BK,PG & DATE :** 11080 /176 2000-02-10  
**ACREAGE :** 26.000      **SALE PRICE :** \$0      **QUALIFIED SALE (Y/N) :**  
**LAND VALUE :** \$846,810      **IMPVMTS VALUE :** \$7,706,120      **TOTAL VALUE :** \$8,552,930

**LAND-USE TYPE :** APARTMENT      **BUILDING TYPE :** GARDEN APARTMENT  
**YEAR BUILT :** 1,979      **SQUARE FEET :** 6,876      **STYLE CODE :** 2.0 STORIES  
**BEDROOMS :** 0      **BATHROOMS :** 0      **RESTROOMS :** 0      **BASEMENT :** N      **GARAGE :** N  
**EXTERIOR TYPE :** WOOD ON SHEATHING OR PLYWO      **QUALITY GRADE :** 2      **IMPVMT. VALUE :** \$225,370  
**A/C :** CENTRAL      **FIREPLACE :** NONE



# MECKLENBURG COUNTY, NC

DATE PRINTED

## GIS PUBLIC ACCESS SYSTEM REPORT

Note : Records are sorted in Parcel Number order.

PAGE : 9

**Record No.:** 25      **BUILDING KEY NUMBER :** 16924105 014  
**PARCEL-ID :** 16924105      **NEIGHBORHOOD CODE :** 16901      **ZONING CLASS :** R12MF  
**OWNER'S NAME :** WXI/MCN MULTIFAMILY R/E LP  
**MAILING ADDRESS :** PO BOX 81290  
**CITY :** CHICAGO      **STATE :** IL      **ZIP CODE :** 606810290

**PROPERTY LOCATION :** 441 E ARROWOOD      RE  
**LEGAL DESC. :** NA      **DEED BK,PG & DATE :** 11080 /176 2000-02-10  
**ACREAGE :** 26.000      **SALE PRICE :** \$0      **QUALIFIED SALE (Y/N) :**  
**LAND VALUE :** \$846,810      **IMPVMTS VALUE :** \$7,706,120      **TOTAL VALUE :** \$8,552,930

**LAND-USE TYPE :** APARTMENT      **BUILDING TYPE :** GARDEN APARTMENT  
**YEAR BUILT :** 1,979      **SQUARE FEET :** 6,876      **STYLE CODE :** 2.0 STORIES  
**BEDROOMS :** 0      **BATHROOMS :** 0      **RESTROOMS :** 0      **BASEMENT :** N      **GARAGE :** N  
**EXTERIOR TYPE :** WOOD ON SHEATHING OR PLYWO      **QUALITY GRADE :** 2      **IMPVMT. VALUE :** \$225,370  
**A/C :** CENTRAL      **FIREPLACE :** NONE

**Record No.:** 26      **BUILDING KEY NUMBER :** 16924105 015  
**PARCEL-ID :** 16924105      **NEIGHBORHOOD CODE :** 16901      **ZONING CLASS :** R12MF  
**OWNER'S NAME :** WXI/MCN MULTIFAMILY R/E LP  
**MAILING ADDRESS :** PO BOX 81290  
**CITY :** CHICAGO      **STATE :** IL      **ZIP CODE :** 606810290

**PROPERTY LOCATION :** 441 E ARROWOOD      RE  
**LEGAL DESC. :** NA      **DEED BK,PG & DATE :** 11080 /176 2000-02-10  
**ACREAGE :** 26.000      **SALE PRICE :** \$0      **QUALIFIED SALE (Y/N) :**  
**LAND VALUE :** \$846,810      **IMPVMTS VALUE :** \$7,706,120      **TOTAL VALUE :** \$8,552,930

**LAND-USE TYPE :** APARTMENT      **BUILDING TYPE :** GARDEN APARTMENT  
**YEAR BUILT :** 1,979      **SQUARE FEET :** 7,712      **STYLE CODE :** 2.0 STORIES  
**BEDROOMS :** 0      **BATHROOMS :** 0      **RESTROOMS :** 0      **BASEMENT :** N      **GARAGE :** N  
**EXTERIOR TYPE :** WOOD ON SHEATHING OR PLYWO      **QUALITY GRADE :** 2      **IMPVMT. VALUE :** \$237,550  
**A/C :** CENTRAL      **FIREPLACE :** NONE

**Record No.:** 27      **BUILDING KEY NUMBER :** 16924105 016  
**PARCEL-ID :** 16924105      **NEIGHBORHOOD CODE :** 16901      **ZONING CLASS :** R12MF  
**OWNER'S NAME :** WXI/MCN MULTIFAMILY R/E LP  
**MAILING ADDRESS :** PO BOX 81290  
**CITY :** CHICAGO      **STATE :** IL      **ZIP CODE :** 606810290

**PROPERTY LOCATION :** 441 E ARROWOOD      RE  
**LEGAL DESC. :** NA      **DEED BK,PG & DATE :** 11080 /176 2000-02-10  
**ACREAGE :** 26.000      **SALE PRICE :** \$0      **QUALIFIED SALE (Y/N) :**  
**LAND VALUE :** \$846,810      **IMPVMTS VALUE :** \$7,706,120      **TOTAL VALUE :** \$8,552,930

**LAND-USE TYPE :** APARTMENT      **BUILDING TYPE :** GARDEN APARTMENT  
**YEAR BUILT :** 1,979      **SQUARE FEET :** 7,712      **STYLE CODE :** 2.0 STORIES  
**BEDROOMS :** 0      **BATHROOMS :** 0      **RESTROOMS :** 0      **BASEMENT :** N      **GARAGE :** N  
**EXTERIOR TYPE :** WOOD ON SHEATHING OR PLYWO      **QUALITY GRADE :** 2      **IMPVMT. VALUE :** \$237,550  
**A/C :** CENTRAL      **FIREPLACE :** NONE



# MECKLENBURG COUNTY, NC

DATE PRINTED

## *GIS PUBLIC ACCESS SYSTEM REPORT*

Note : Records are sorted in Parcel Number order.

PAGE : 10

**Record No.:** 28      **BUILDING KEY NUMBER :** 16924105 017  
**PARCEL-ID :** 16924105      **NEIGHBORHOOD CODE :** 16901      **ZONING CLASS :** R12MF  
**OWNER'S NAME :** WXI/MCN MULTIFAMILY R/E LP  
**MAILING ADDRESS :** PO BOX 81290  
**CITY :** CHICAGO      **STATE :** IL      **ZIP CODE :** 606810290

**PROPERTY LOCATION :** 441 E ARROWOOD      RE  
**LEGAL DESC. :** NA      **DEED BK,PG & DATE :** 11080 /176 2000-02-10  
**ACREAGE :** 26.000      **SALE PRICE :** \$0      **QUALIFIED SALE (Y/N) :**  
**LAND VALUE :** \$846,810      **IMPVMTS VALUE :** \$7,706,120      **TOTAL VALUE :** \$8,552,930

**LAND-USE TYPE :** APARTMENT      **BUILDING TYPE :** GARDEN APARTMENT  
**YEAR BUILT :** 1,979      **SQUARE FEET :** 7,712      **STYLE CODE :** 2.0 STORIES  
**BEDROOMS :** 0      **BATHROOMS :** 0      **RESTROOMS :** 0      **BASEMENT :** N      **GARAGE :** N  
**EXTERIOR TYPE :** WOOD ON SHEATHING OR PLYWO      **QUALITY GRADE :** 2      **IMPVMT. VALUE :** \$237,550  
**A/C :** CENTRAL      **FIREPLACE :** NONE

**Record No.:** 29      **BUILDING KEY NUMBER :** 16924105 018  
**PARCEL-ID :** 16924105      **NEIGHBORHOOD CODE :** 16901      **ZONING CLASS :** R12MF  
**OWNER'S NAME :** WXI/MCN MULTIFAMILY R/E LP  
**MAILING ADDRESS :** PO BOX 81290  
**CITY :** CHICAGO      **STATE :** IL      **ZIP CODE :** 606810290

**PROPERTY LOCATION :** 441 E ARROWOOD      RE  
**LEGAL DESC. :** NA      **DEED BK,PG & DATE :** 11080 /176 2000-02-10  
**ACREAGE :** 26.000      **SALE PRICE :** \$0      **QUALIFIED SALE (Y/N) :**  
**LAND VALUE :** \$846,810      **IMPVMTS VALUE :** \$7,706,120      **TOTAL VALUE :** \$8,552,930

**LAND-USE TYPE :** APARTMENT      **BUILDING TYPE :** GARDEN APARTMENT  
**YEAR BUILT :** 1,979      **SQUARE FEET :** 6,876      **STYLE CODE :** 2.0 STORIES  
**BEDROOMS :** 0      **BATHROOMS :** 0      **RESTROOMS :** 0      **BASEMENT :** N      **GARAGE :** N  
**EXTERIOR TYPE :** WOOD ON SHEATHING OR PLYWO      **QUALITY GRADE :** 2      **IMPVMT. VALUE :** \$225,370  
**A/C :** CENTRAL      **FIREPLACE :** NONE

**Record No.:** 30      **BUILDING KEY NUMBER :** 16924105 019  
**PARCEL-ID :** 16924105      **NEIGHBORHOOD CODE :** 16901      **ZONING CLASS :** R12MF  
**OWNER'S NAME :** WXI/MCN MULTIFAMILY R/E LP  
**MAILING ADDRESS :** PO BOX 81290  
**CITY :** CHICAGO      **STATE :** IL      **ZIP CODE :** 606810290

**PROPERTY LOCATION :** 441 E ARROWOOD      RE  
**LEGAL DESC. :** NA      **DEED BK,PG & DATE :** 11080 /176 2000-02-10  
**ACREAGE :** 26.000      **SALE PRICE :** \$0      **QUALIFIED SALE (Y/N) :**  
**LAND VALUE :** \$846,810      **IMPVMTS VALUE :** \$7,706,120      **TOTAL VALUE :** \$8,552,930

**LAND-USE TYPE :** APARTMENT      **BUILDING TYPE :** GARDEN APARTMENT  
**YEAR BUILT :** 1,979      **SQUARE FEET :** 6,876      **STYLE CODE :** 2.0 STORIES  
**BEDROOMS :** 0      **BATHROOMS :** 0      **RESTROOMS :** 0      **BASEMENT :** N      **GARAGE :** N  
**EXTERIOR TYPE :** WOOD ON SHEATHING OR PLYWO      **QUALITY GRADE :** 2      **IMPVMT. VALUE :** \$225,370  
**A/C :** CENTRAL      **FIREPLACE :** NONE



**MECKLENBURG COUNTY, NC**  
**GIS PUBLIC ACCESS SYSTEM REPORT**

DATE PRINTED

Note : Records are sorted in Parcel Number order.

PAGE : 11

**Record No.:** 31      **BUILDING KEY NUMBER :** 16924105 020  
**PARCEL-ID :** 16924105      **NEIGHBORHOOD CODE :** 16901      **ZONING CLASS :** R12MF  
**OWNER'S NAME :** WXI/MCN MULTIFAMILY R/E LP  
**MAILING ADDRESS :** PO BOX 81290  
**CITY :** CHICAGO      **STATE :** IL      **ZIP CODE :** 606810290  
**PROPERTY LOCATION :** 441 E ARROWOOD      RE  
**LEGAL DESC. :** NA      **DEED BK,PG & DATE :** 11080 /176 2000-02-10  
**ACREAGE :** 26.000      **SALE PRICE :** \$0      **QUALIFIED SALE (Y/N) :**  
**LAND VALUE :** \$846,810      **IMPVMTS VALUE :** \$7,706,120      **TOTAL VALUE :** \$8,552,930

**LAND-USE TYPE :** APARTMENT      **BUILDING TYPE :** GARDEN APARTMENT  
**YEAR BUILT :** 1,979      **SQUARE FEET :** 4,564      **STYLE CODE :** 2.0 STORIES  
**BEDROOMS :** 0      **BATHROOMS :** 0      **RESTROOMS :** 0      **BASEMENT :** N      **GARAGE :** N  
**EXTERIOR TYPE :** WOOD ON SHEATHING OR PLYWO      **QUALITY GRADE :** 2      **IMPVMT. VALUE :** \$112,410  
**A/C :** CENTRAL      **FIREPLACE :** NONE

**Record No.:** 32      **BUILDING KEY NUMBER :** 16924105 021  
**PARCEL-ID :** 16924105      **NEIGHBORHOOD CODE :** 16901      **ZONING CLASS :** R12MF  
**OWNER'S NAME :** WXI/MCN MULTIFAMILY R/E LP  
**MAILING ADDRESS :** PO BOX 81290  
**CITY :** CHICAGO      **STATE :** IL      **ZIP CODE :** 606810290  
**PROPERTY LOCATION :** 441 E ARROWOOD      RE  
**LEGAL DESC. :** NA      **DEED BK,PG & DATE :** 11080 /176 2000-02-10  
**ACREAGE :** 26.000      **SALE PRICE :** \$0      **QUALIFIED SALE (Y/N) :**  
**LAND VALUE :** \$846,810      **IMPVMTS VALUE :** \$7,706,120      **TOTAL VALUE :** \$8,552,930

**LAND-USE TYPE :** COMMERCIAL      **BUILDING TYPE :** CLUB-LODGE  
**YEAR BUILT :** 1,979      **SQUARE FEET :** 528      **STYLE CODE :** 2.0 STORIES  
**BEDROOMS :** 0      **BATHROOMS :** 0      **RESTROOMS :** 0      **BASEMENT :** N      **GARAGE :** N  
**EXTERIOR TYPE :** WOOD ON SHEATHING OR PLYWO      **QUALITY GRADE :** 2      **IMPVMT. VALUE :** \$20,240  
**A/C :** CENTRAL      **FIREPLACE :** NONE

**Record No.:** 33      **BUILDING KEY NUMBER :** 16924105 022  
**PARCEL-ID :** 16924105      **NEIGHBORHOOD CODE :** 16901      **ZONING CLASS :** R12MF  
**OWNER'S NAME :** WXI/MCN MULTIFAMILY R/E LP  
**MAILING ADDRESS :** PO BOX 81290  
**CITY :** CHICAGO      **STATE :** IL      **ZIP CODE :** 606810290  
**PROPERTY LOCATION :** 441 E ARROWOOD      RE  
**LEGAL DESC. :** NA      **DEED BK,PG & DATE :** 11080 /176 2000-02-10  
**ACREAGE :** 26.000      **SALE PRICE :** \$0      **QUALIFIED SALE (Y/N) :**  
**LAND VALUE :** \$846,810      **IMPVMTS VALUE :** \$7,706,120      **TOTAL VALUE :** \$8,552,930

**LAND-USE TYPE :** APARTMENT      **BUILDING TYPE :** GARDEN APARTMENT  
**YEAR BUILT :** 1,974      **SQUARE FEET :** 912      **STYLE CODE :** 2.0 STORIES  
**BEDROOMS :** 0      **BATHROOMS :** 0      **RESTROOMS :** 0      **BASEMENT :** N      **GARAGE :** N  
**EXTERIOR TYPE :** WOOD ON SHEATHING OR PLYWO      **QUALITY GRADE :** 2      **IMPVMT. VALUE :** \$25,360  
**A/C :** CENTRAL      **FIREPLACE :** NONE



# MECKLENBURG COUNTY, NC

## GIS PUBLIC ACCESS SYSTEM REPORT

DATE PRINTED

Note : Records are sorted in Parcel Number order.

PAGE : 12

**Record No.:** 34      **BUILDING KEY NUMBER:** 16924105 023  
**PARCEL-ID:** 16924105      **NEIGHBORHOOD CODE:** 16901      **ZONING CLASS:** R12MF  
**OWNER'S NAME:** WXI/MCN MULTIFAMILY R/E LP  
**MAILING ADDRESS:** PO BOX 81290  
**CITY:** CHICAGO      **STATE:** IL      **ZIP CODE:** 606810290

**PROPERTY LOCATION:** 8832      **BROOMSAGE**      **LN**  
**LEGAL DESC.:** NA      **DEED BK,PG & DATE:** 11080 /176 2000-02-10  
**ACREAGE:** 26.000      **SALE PRICE:** \$0      **QUALIFIED SALE (Y/N):**  
**LAND VALUE:** \$846,810      **IMPVMTS VALUE:** \$7,706,120      **TOTAL VALUE:** \$8,552,930

**LAND-USE TYPE:** APARTMENT      **BUILDING TYPE:** GARDEN APARTMENT  
**YEAR BUILT:** 1,980      **SQUARE FEET:** 6,876      **STYLE CODE:** 2.0 STORIES  
**BEDROOMS:** 0      **BATHROOMS:** 0      **RESTROOMS:** 0      **EASEMENT:** N      **GARAGE:** N  
**EXTERIOR TYPE:** WOOD ON SHEATHING OR FLYWO      **QUALITY GRADE:** 2      **IMPVMT. VALUE:** \$225,370  
**A/C:** CENTRAL      **FIREPLACE:** NONE

**Record No.:** 35      **BUILDING KEY NUMBER:** 16924105 024  
**PARCEL-ID:** 16924105      **NEIGHBORHOOD CODE:** 16901      **ZONING CLASS:** R12MF  
**OWNER'S NAME:** WXI/MCN MULTIFAMILY R/E LP  
**MAILING ADDRESS:** PO BOX 81290  
**CITY:** CHICAGO      **STATE:** IL      **ZIP CODE:** 606810290

**PROPERTY LOCATION:** 8828      **OLD PINEVILLE RD**  
**LEGAL DESC.:** NA      **DEED BK,PG & DATE:** 11080 /176 2000-02-10  
**ACREAGE:** 26.000      **SALE PRICE:** \$0      **QUALIFIED SALE (Y/N):**  
**LAND VALUE:** \$846,810      **IMPVMTS VALUE:** \$7,706,120      **TOTAL VALUE:** \$8,552,930

**LAND-USE TYPE:** APARTMENT      **BUILDING TYPE:** GARDEN APARTMENT  
**YEAR BUILT:** 1,980      **SQUARE FEET:** 5,040      **STYLE CODE:** 2.0 STORIES  
**BEDROOMS:** 0      **BATHROOMS:** 0      **RESTROOMS:** 0      **EASEMENT:** N      **GARAGE:** N  
**EXTERIOR TYPE:** WOOD ON SHEATHING OR PLYWO      **QUALITY GRADE:** 2      **IMPVMT. VALUE:** \$170,210  
**A/C:** CENTRAL      **FIREPLACE:** NONE

**Record No.:** 36      **BUILDING KEY NUMBER:** 16924105 025  
**PARCEL-ID:** 16924105      **NEIGHBORHOOD CODE:** 16901      **ZONING CLASS:** R12MF  
**OWNER'S NAME:** WXI/MCN MULTIFAMILY R/E LP  
**MAILING ADDRESS:** PO BOX 81290  
**CITY:** CHICAGO      **STATE:** IL      **ZIP CODE:** 606810290

**PROPERTY LOCATION:** 8832      **BROOMSAGE**      **LN**  
**LEGAL DESC.:** NA      **DEED BK,PG & DATE:** 11080 /176 2000-02-10  
**ACREAGE:** 26.000      **SALE PRICE:** \$0      **QUALIFIED SALE (Y/N):**  
**LAND VALUE:** \$846,810      **IMPVMTS VALUE:** \$7,706,120      **TOTAL VALUE:** \$8,552,930

**LAND-USE TYPE:** APARTMENT      **BUILDING TYPE:** GARDEN APARTMENT  
**YEAR BUILT:** 1,980      **SQUARE FEET:** 6,375      **STYLE CODE:** 2.0 STORIES  
**BEDROOMS:** 0      **BATHROOMS:** 0      **RESTROOMS:** 0      **EASEMENT:** N      **GARAGE:** N  
**EXTERIOR TYPE:** WOOD ON SHEATHING OR PLYWO      **QUALITY GRADE:** 2      **IMPVMT. VALUE:** \$225,370  
**A/C:** CENTRAL      **FIREPLACE:** NONE



# MECKLENBURG COUNTY, NC

DATE PRINTED

## GIS PUBLIC ACCESS SYSTEM REPORT

Note : Records are sorted in Parcel Number order.

PAGE : 13

**Record No.:** 37      **BUILDING KEY NUMBER :** 16924105 026  
**PARCEL-ID :** 16924105      **NEIGHBORHOOD CODE :** 16901      **ZONING CLASS :** R12MF  
**OWNER'S NAME :** WXI/MCN MULTIFAMILY R/E LP  
**MAILING ADDRESS :** PO BOX 81290  
**CITY :** CHICAGO      **STATE :** IL      **ZIP CODE :** 606810290

**PROPERTY LOCATION :** 8700      OLD PINEVILLE RD  
**LEGAL DESC. :** NA      **DEED BK,PG & DATE :** 11080 /176 2000-02-10  
**ACREAGE :** 26.000      **SALE PRICE :** \$0      **QUALIFIED SALE (Y/N) :**  
**LAND VALUE :** \$846,810      **IMPVMTS VALUE :** \$7,706,120      **TOTAL VALUE :** \$8,552,930

**LAND-USE TYPE :** APARTMENT      **BUILDING TYPE :** GARDEN APARTMENT  
**YEAR BUILT :** 1,980      **SQUARE FEET :** 7,712      **STYLE CODE :** 2.0 STORIES  
**BEDROOMS :** 0      **BATHROOMS :** 0      **RESTROOMS :** 0      **BASEMENT :** N      **GARAGE :** N  
**EXTERIOR TYPE :** WOOD ON SHEATHING OR PLYWO      **QUALITY GRADE :** 2      **IMPVMT. VALUE :** \$237,550  
**A/C :** CENTRAL      **FIREPLACE :** NONE

**Record No.:** 38      **BUILDING KEY NUMBER :** 16924105 027  
**PARCEL-ID :** 16924105      **NEIGHBORHOOD CODE :** 16901      **ZONING CLASS :** R12MF  
**OWNER'S NAME :** WXI/MCN MULTIFAMILY R/E LP  
**MAILING ADDRESS :** PO BOX 81290  
**CITY :** CHICAGO      **STATE :** IL      **ZIP CODE :** 606810290

**PROPERTY LOCATION :** 8717      OLD PINEVILLE RD  
**LEGAL DESC. :** NA      **DEED BK,PG & DATE :** 11080 /176 2000-02-10  
**ACREAGE :** 26.000      **SALE PRICE :** \$0      **QUALIFIED SALE (Y/N) :**  
**LAND VALUE :** \$846,810      **IMPVMTS VALUE :** \$7,706,120      **TOTAL VALUE :** \$8,552,930

**LAND-USE TYPE :** APARTMENT      **BUILDING TYPE :** GARDEN APARTMENT  
**YEAR BUILT :** 1,980      **SQUARE FEET :** 7,712      **STYLE CODE :** 2.0 STORIES  
**BEDROOMS :** 0      **BATHROOMS :** 0      **RESTROOMS :** 0      **BASEMENT :** N      **GARAGE :** N  
**EXTERIOR TYPE :** WOOD ON SHEATHING OR PLYWO      **QUALITY GRADE :** 2      **IMPVMT. VALUE :** \$237,550  
**A/C :** CENTRAL      **FIREPLACE :** NONE

**Record No.:** 39      **BUILDING KEY NUMBER :** 16924105 028  
**PARCEL-ID :** 16924105      **NEIGHBORHOOD CODE :** 16901      **ZONING CLASS :** R12MF  
**OWNER'S NAME :** WXI/MCN MULTIFAMILY R/E LP  
**MAILING ADDRESS :** PO BOX 81290  
**CITY :** CHICAGO      **STATE :** IL      **ZIP CODE :** 606810290

**PROPERTY LOCATION :** 8723      OLD PINEVILLE RD  
**LEGAL DESC. :** NA      **DEED BK,PG & DATE :** 11080 /176 2000-02-10  
**ACREAGE :** 26.000      **SALE PRICE :** \$0      **QUALIFIED SALE (Y/N) :**  
**LAND VALUE :** \$846,810      **IMPVMTS VALUE :** \$7,706,120      **TOTAL VALUE :** \$8,552,930

**LAND-USE TYPE :** APARTMENT      **BUILDING TYPE :** GARDEN APARTMENT  
**YEAR BUILT :** 1,980      **SQUARE FEET :** 7,712      **STYLE CODE :** 2.0 STORIES  
**BEDROOMS :** 0      **BATHROOMS :** 0      **RESTROOMS :** 0      **BASEMENT :** N      **GARAGE :** N  
**EXTERIOR TYPE :** WOOD ON SHEATHING OR PLYWO      **QUALITY GRADE :** 2      **IMPVMT. VALUE :** \$237,550  
**A/C :** CENTRAL      **FIREPLACE :** NONE



# MECKLENBURG COUNTY, NC

## GIS PUBLIC ACCESS SYSTEM REPORT

DATE PRINTED

Note : Records are sorted in Parcel Number order.

PAGE : 14

**Record No.:** 40      **BUILDING KEY NUMBER:** 16924105 029  
**PARCEL-ID:** 16924105      **NEIGHBORHOOD CODE:** 16901      **ZONING CLASS:** R12MF  
**OWNER'S NAME:** WXI/MCN MULTIFAMILY R/E LP  
**MAILING ADDRESS:** PO BOX 81290  
**CITY:** CHICAGO      **STATE:** IL      **ZIP CODE:** 606810290

**PROPERTY LOCATION:** 8801      OLD PINEVILLE RD  
**LEGAL DESC.:** NA      **DEED BK,PG & DATE:** 11080 /176 2000-02-10  
**ACREAGE:** 26.000      **SALE PRICE:** \$0      **QUALIFIED SALE (Y/N):**  
**LAND VALUE:** \$846,810      **IMPVMTS VALUE:** \$7,706,120      **TOTAL VALUE:** \$8,552,930

**LAND-USE TYPE:** APARTMENT      **BUILDING TYPE:** GARDEN APARTMENT  
**YEAR BUILT:** 1,980      **SQUARE FEET:** 4,564      **STYLE CODE:** 2.0 STORIES  
**BEDROOMS:** 0      **BATHROOMS:** 0      **RESTROOMS:** 0      **BASEMENT:** N      **GARAGE:** N  
**EXTERIOR TYPE:** WOOD ON SHEATHING OR PLYWO      **QUALITY GRADE:** 2      **IMPVMT. VALUE:** \$225,270  
**A/C:** CENTRAL      **FIREPLACE:** NONE

**Record No.:** 41      **BUILDING KEY NUMBER:** 16924105 028  
**PARCEL-ID:** 16924105      **NEIGHBORHOOD CODE:** 16901      **ZONING CLASS:** R12MF  
**OWNER'S NAME:** WXI/MCN MULTIFAMILY R/E LP  
**MAILING ADDRESS:** PO BOX 81290  
**CITY:** CHICAGO      **STATE:** IL      **ZIP CODE:** 606810290

**PROPERTY LOCATION:** 8819      OLD PINEVILLE RD  
**LEGAL DESC.:** NA      **DEED BK,PG & DATE:** 11080 /176 2000-02-10  
**ACREAGE:** 26.000      **SALE PRICE:** \$0      **QUALIFIED SALE (Y/N):**  
**LAND VALUE:** \$846,810      **IMPVMTS VALUE:** \$7,706,120      **TOTAL VALUE:** \$8,552,930

**LAND-USE TYPE:** APARTMENT      **BUILDING TYPE:** GARDEN APARTMENT  
**YEAR BUILT:** 1,980      **SQUARE FEET:** 4,564      **STYLE CODE:** 2.0 STORIES  
**BEDROOMS:** 0      **BATHROOMS:** 0      **RESTROOMS:** 0      **BASEMENT:** N      **GARAGE:** N  
**EXTERIOR TYPE:** WOOD ON SHEATHING OR PLYWO      **QUALITY GRADE:** 2      **IMPVMT. VALUE:** \$149,410  
**A/C:** CENTRAL      **FIREPLACE:** NONE

**Record No.:** 42      **BUILDING KEY NUMBER:** 16924105 031  
**PARCEL-ID:** 16924105      **NEIGHBORHOOD CODE:** 16901      **ZONING CLASS:** R12MF  
**OWNER'S NAME:** WXI/MCN MULTIFAMILY R/E LP  
**MAILING ADDRESS:** PO BOX 81290  
**CITY:** CHICAGO      **STATE:** IL      **ZIP CODE:** 606810290

**PROPERTY LOCATION:** 8821      OLD PINEVILLE RD  
**LEGAL DESC.:** NA      **DEED BK,PG & DATE:** 11080 /176 2000-02-10  
**ACREAGE:** 26.000      **SALE PRICE:** \$0      **QUALIFIED SALE (Y/N):**  
**LAND VALUE:** \$846,810      **IMPVMTS VALUE:** \$7,706,120      **TOTAL VALUE:** \$8,552,930

**LAND-USE TYPE:** APARTMENT      **BUILDING TYPE:** GARDEN APARTMENT  
**YEAR BUILT:** 1,980      **SQUARE FEET:** 4,564      **STYLE CODE:** 2.0 STORIES  
**BEDROOMS:** 0      **BATHROOMS:** 0      **RESTROOMS:** 0      **BASEMENT:** N      **GARAGE:** N  
**EXTERIOR TYPE:** WOOD ON SHEATHING OR PLYWO      **QUALITY GRADE:** 2      **IMPVMT. VALUE:** \$170,310  
**A/C:** CENTRAL      **FIREPLACE:** NONE





# MECKLENBURG COUNTY, NC

DATE PRINTED

## GIS PUBLIC ACCESS SYSTEM REPORT

Note : Records are sorted in Parcel Number order.

PAGE : 15

**Record No.:** 43      **BUILDING KEY NUMBER :** 16924105 032  
**PARCEL-ID :** 16924105      **NEIGHBORHOOD CODE :** 16901      **ZONING CLASS :** R12MF  
**OWNER'S NAME :** WXI/MCN MULTIFAMILY R/E LP  
**MAILING ADDRESS :** PO BOX 81290  
**CITY :** CHICAGO      **STATE :** IL      **ZIP CODE :** 606810290

**PROPERTY LOCATION :** 8701      OLD PINEVILLE RD  
**LEGAL DESC. :** NA      **DEED BK,PG & DATE :** 11080 /176 2000-02-10  
**ACREAGE :** 26.000      **SALE PRICE :** \$0      **QUALIFIED SALE (Y/N) :**  
**LAND VALUE :** \$846,810      **IMPVMTS VALUE :** \$7,706,120      **TOTAL VALUE :** \$8,552,930

**LAND-USE TYPE :** APARTMENT      **BUILDING TYPE :** GARDEN APARTMENT  
**YEAR BUILT :** 1,980      **SQUARE FEET :** 6,576      **STYLE CODE :** 2. STORIES  
**BEDROOMS :** 0      **BATHROOMS :** 0      **RESTROOMS :** 0      **BASEMENT :** N      **GARAGE :** N  
**EXTERIOR TYPE :** WOOD ON SHEATHING OR PLYWO      **QUALITY GRADE :** 2      **IMPVMT. VALUE :** \$237,550  
**A/C :** CENTRAL      **FIREPLACE :** NONE

**CEL-ID :** 16924105      **NEIGHBORHOOD CODE :** 16901      **ZONING CLASS :** R12MF  
**OWNER'S NAME :** WXI/MCN MULTIFAMILY R/E LP  
**MAILING ADDRESS :** PO BOX 81290  
**CITY :** CHICAGO      **STATE :** IL      **ZIP CODE :** 606810290

**PROPERTY LOCATION :** 8735      OLD PINEVILLE RD  
**LEGAL DESC. :** NA      **DEED BK,PG & DATE :** 11080 /176 2000-02-10  
**ACREAGE :** 26.000      **SALE PRICE :** \$0      **QUALIFIED SALE (Y/N) :**  
**LAND VALUE :** \$846,810      **IMPVMTS VALUE :** \$7,706,120      **TOTAL VALUE :** \$8,552,930

**LAND-USE TYPE :** APARTMENT      **BUILDING TYPE :** GARDEN APARTMENT  
**YEAR BUILT :** 1,980      **SQUARE FEET :** 6,576      **STYLE CODE :** 2. STORIES  
**BEDROOMS :** 0      **BATHROOMS :** 0      **RESTROOMS :** 0      **BASEMENT :** N      **GARAGE :** N  
**EXTERIOR TYPE :** WOOD ON SHEATHING OR PLYWO      **QUALITY GRADE :** 2      **IMPVMT. VALUE :** \$225,370  
**A/C :** CENTRAL      **FIREPLACE :** NONE

**Record No.:** 45      **BUILDING KEY NUMBER :** 16924105 034  
**PARCEL-ID :** 16924105      **NEIGHBORHOOD CODE :** 16901      **ZONING CLASS :** R12MF  
**OWNER'S NAME :** WXI/MCN MULTIFAMILY R/E LP  
**MAILING ADDRESS :** PO BOX 81290  
**CITY :** CHICAGO      **STATE :** IL      **ZIP CODE :** 606810290

**PROPERTY LOCATION :** 8805      OLD PINEVILLE RD  
**LEGAL DESC. :** NA      **DEED BK,PG & DATE :** 11080 /176 2000-02-10  
**ACREAGE :** 26.000      **SALE PRICE :** \$0      **QUALIFIED SALE (Y/N) :**  
**LAND VALUE :** \$846,810      **IMPVMTS VALUE :** \$7,706,120      **TOTAL VALUE :** \$8,552,930

**LAND-USE TYPE :** COMMERCIAL      **BUILDING TYPE :** CLUB-LODGE  
**YEAR BUILT :** 1,980      **SQUARE FEET :** 57,000      **STYLE CODE :** 1. STORIES  
**BEDROOMS :** 0      **BATHROOMS :** 0      **RESTROOMS :** 0      **BASEMENT :** N      **GARAGE :** N  
**EXTERIOR TYPE :** WOOD ON SHEATHING OR PLYWO      **QUALITY GRADE :** 2      **IMPVMT. VALUE :** \$225,370  
**A/C :** CENTRAL      **FIREPLACE :** NONE



# MECKLENBURG COUNTY, NC

DATE PRINTED

## GIS PUBLIC ACCESS SYSTEM REPORT

Note : Records are sorted in Parcel Number order.

PAGE : 16

**Record No.:** 46      **BUILDING KEY NUMBER :** 16924105 035  
**PARCEL-ID :** 16924105      **NEIGHBORHOOD CODE :** 16901      **ZONING CLASS :** R12MF  
**OWNER'S NAME :** WXI/MCN MULTIFAMILY R/E LP  
**MAILING ADDRESS :** PO BOX 81290  
**CITY :** CHICAGO      **STATE :** IL      **ZIP CODE :** 606810290

**PROPERTY LOCATION :** 8716      OLD PINEVILLE RD  
**LEGAL DESC. :** NA      **DEED BK,PG & DATE :** 11080 /176 2000-02-10  
**ACREAGE :** 26.000      **SALE PRICE :** \$0      **QUALIFIED SALE (Y/N) :**  
**LAND VALUE :** \$846,810      **IMPVMTS VALUE :** \$7,706,120      **TOTAL VALUE :** \$8,552,930

**LAND-USE TYPE :** APARTMENT      **BUILDING TYPE :** GARDEN APARTMENT  
**YEAR BUILT :** 1,980      **SQUARE FEET :** 6,876      **STYLE CODE :** 2.0 STORIES  
**BEDROOMS :** 0      **BATHROOMS :** 0      **RESTROOMS :** 0      **BASEMENT :** N      **GARAGE :** N  
**EXTERIOR TYPE :** WOOD ON SHEATHING OR PLYWO      **QUALITY GRADE :** 2      **IMPVMT. VALUE :** \$237,570  
**A/C :** CENTRAL      **FIREPLACE :** NONE

**PARCEL :** 16924105      **OWNER'S NAME :** WXI/MCN MULTIFAMILY R/E LP  
**MAILING ADDRESS :** PO BOX 81290  
**CITY :** CHICAGO      **STATE :** IL      **ZIP CODE :** 606810290

**PROPERTY LOCATION :** 8809      OLD PINEVILLE RD  
**LEGAL DESC. :** NA      **DEED BK,PG & DATE :** 11080 /176 2000-02-10  
**ACREAGE :** 26.000      **SALE PRICE :** \$0      **QUALIFIED SALE (Y/N) :**  
**LAND VALUE :** \$846,810      **IMPVMTS VALUE :** \$7,706,120      **TOTAL VALUE :** \$8,552,930

**LAND-USE TYPE :** APARTMENT      **BUILDING TYPE :** GARDEN APARTMENT  
**YEAR BUILT :** 1,980      **SQUARE FEET :** 6,876      **STYLE CODE :** 2.0 STORIES  
**BEDROOMS :** 0      **BATHROOMS :** 0      **RESTROOMS :** 0      **BASEMENT :** N      **GARAGE :** N  
**EXTERIOR TYPE :** WOOD ON SHEATHING OR PLYWO      **QUALITY GRADE :** 2      **IMPVMT. VALUE :** \$225,370  
**A/C :** CENTRAL      **FIREPLACE :** NONE

**Record No.:** 48      **BUILDING KEY NUMBER :** 16924105 037  
**PARCEL-ID :** 16924105      **NEIGHBORHOOD CODE :** 16901      **ZONING CLASS :** R12MF  
**OWNER'S NAME :** WXI/MCN MULTIFAMILY R/E LP  
**MAILING ADDRESS :** PO BOX 81290  
**CITY :** CHICAGO      **STATE :** IL      **ZIP CODE :** 606810290

**PROPERTY LOCATION :** 8733      OLD PINEVILLE RD  
**LEGAL DESC. :** NA      **DEED BK,PG & DATE :** 11080 /176 2000-02-10  
**ACREAGE :** 26.000      **SALE PRICE :** \$0      **QUALIFIED SALE (Y/N) :**  
**LAND VALUE :** \$846,810      **IMPVMTS VALUE :** \$7,706,120      **TOTAL VALUE :** \$8,552,930

**LAND-USE TYPE :** APARTMENT      **BUILDING TYPE :** GARDEN APARTMENT  
**YEAR BUILT :** 1,980      **SQUARE FEET :** 6,876      **STYLE CODE :** 2.0 STORIES  
**BEDROOMS :** 0      **BATHROOMS :** 0      **RESTROOMS :** 0      **BASEMENT :** N      **GARAGE :** N  
**EXTERIOR TYPE :** WOOD ON SHEATHING OR PLYWO      **QUALITY GRADE :** 2      **IMPVMT. VALUE :** \$225,370  
**A/C :** CENTRAL      **FIREPLACE :** NONE



**MECKLENBURG COUNTY, NC**  
**GIS PUBLIC ACCESS SYSTEM REPORT**

DATE PRINTED

Note : Records are sorted in Parcel Number order.

PAGE : 17

**Record No.:** 49      **BUILDING KEY NUMBER:** 20517106 001  
**PARCEL-ID:** 20517106      **NEIGHBORHOOD CODE:** 20501      **ZONING CLASS:** R15MFC  
**OWNER'S NAME:** MV/ALG RIVER CROSSING LIMITED  
**MAILING ADDRESS:** 4000 MILLER VALENTINE CT  
**CITY:** DAYTON      **STATE:** OF      **ZIP CODE:** 45439

**PROPERTY LOCATION:** 440 E ARROWOOD      **RE**  
**LEGAL DESC.:** L1 M34-525      **DEED BK,PG & DATE:** 12727 /056 2001-10-02  
**ACREAGE:** 9.000      **SALE PRICE:** \$0      **QUALIFIED SALE (Y/N):** Y  
**LAND VALUE:** \$264,020      **IMPVMTS VALUE:** \$26,400      **TOTAL VALUE:** \$290,420

**LAND-USE TYPE:** VACANT      **BUILDING TYPE:** GARDEN APARTMENT  
**YEAR BUILT:**      **SQUARE FEET:**      **STYLE CODE:**  
**BEDROOMS:**      **BATHROOMS:** 0      **RESTROOMS:**      **BASEMENT:** N      **GARAGE:** N  
**EXTERIOR TYPE:**      **QUALITY GRADE:** 0      **IMPVMT. VALUE:** \$0  
**A/C:**      **FIREPLACE:**

**OWNER'S NAME:** CRIST BUILDING  
**MAILING ADDRESS:** 1015 E WESTINGHOUSE BLVD  
**CITY:** CHARLOTTE      **STATE:** NC      **ZIP CODE:** 282735805

**PROPERTY LOCATION:** 340 W ARROWOOD      **RE**  
**LEGAL DESC.:** P1 BA M230-166      **DEED BK,PG & DATE:** 10146 /181 1998-12-29  
**ACREAGE:** 40.000      **SALE PRICE:** \$603,500      **QUALIFIED SALE (Y/N):** Y  
**LAND VALUE:** \$1,203,710      **IMPVMTS VALUE:** \$58,750      **TOTAL VALUE:** \$1,262,460

**LAND-USE TYPE:** SINGLE FAMILY      **BUILDING TYPE:** SINGLE FAMILY RESIDENTIAL  
**YEAR BUILT:** 1,955      **SQUARE FEET:** 2,102      **STYLE CODE:** 1. STORY  
**BEDROOMS:** 3      **BATHROOMS:** 2      **RESTROOMS:** 0      **BASEMENT:** Y      **GARAGE:** N  
**EXTERIOR TYPE:** STUCCO ON TILE OR WOOD FRAME      **QUALITY GRADE:** 2      **IMPVMT. VALUE:** \$58,750  
**A/C:** NONE      **FIREPLACE:** 1 STY SINGLE

**Record No.:** 51      **BUILDING KEY NUMBER:** 20517108 001  
**PARCEL-ID:** 20517108      **NEIGHBORHOOD CODE:** 20501      **ZONING CLASS:** R17MF  
**OWNER'S NAME:** HONDROS S C & ASSOCIATES INC  
**MAILING ADDRESS:** PO BOX 220456  
**CITY:** CHARLOTTE      **STATE:** NC      **ZIP CODE:** 282220456

**PROPERTY LOCATION:** NATIONS FORD      **RE**  
**LEGAL DESC.:** ARROWOOD RD      **DEED BK,PG & DATE:** 05385 /191 1988-10-15  
**ACREAGE:** 8.000      **SALE PRICE:** \$150,000      **QUALIFIED SALE (Y/N):** Y  
**LAND VALUE:** \$74,720      **IMPVMTS VALUE:**      **TOTAL VALUE:** \$74,720

**LAND-USE TYPE:** VACANT      **BUILDING TYPE:** GARDEN APARTMENT  
**YEAR BUILT:**      **SQUARE FEET:**      **STYLE CODE:**  
**BEDROOMS:**      **BATHROOMS:**      **RESTROOMS:**      **BASEMENT:** N      **GARAGE:** N  
**EXTERIOR TYPE:**      **QUALITY GRADE:** 0      **IMPVMT. VALUE:** \$0



**MECKLENBURG COUNTY, NC**  
**GIS PUBLIC ACCESS SYSTEM REPORT**

DATE PRINTED

Note : Records are sorted in Parcel Number order.

PAGE : 18

**Record No.:** 52 **BUILDING KEY NUMBER:** 20517109 001  
**PARCEL-ID:** 20517109 **NEIGHBORHOOD CODE:** 20501 **ZONING CLASS:** R17MF  
**OWNER'S NAME:** JEFFERSON PILOT BROADCASTING % CBIZ PROPERTY TAX SOLUTIONS  
**MAILING ADDRESS:** PO BOX 723715  
**CITY:** ATLANTA **STATE:** GA **ZIP CODE:** 31139

**PROPERTY LOCATION:** 9201 NATIONS FORD RE  
**LEGAL DESC.:** NA **DEED BK,PG & DATE:** /  
**ACREAGE:** 19.000 **SALE PRICE:** \$0 **QUALIFIED SALE (Y/N):**  
**LAND VALUE:** \$497,630 **IMPVMTS VALUE:** \$67,400 **TOTAL VALUE:** \$565,030

**LAND-USE TYPE:** COMMERCIAL **BUILDING TYPE:** COMMERCIAL  
**YEAR BUILT:** 1922 **SQUARE FEET:** 3,270 **STYLE CODE:** 1,051  
**BEDROOMS:** 0 **BATHROOMS:** 0 **RESTROOMS:** 0 **BASEMENT:** Y **GARAGE:**  
**EXTERIOR TYPE:** FACE BRICK **QUALITY GRADE:** 4 **IMPVMT. VALUE:** 50,340  
**A/C:** CENTRAL **FIREPLACE:** NONE

**OWNER'S NAME:** BLUE HILL TRUCKING INC  
**MAILING ADDRESS:** 1015 L WESTINGHOUSE BLVD  
**CITY:** CHARLOTTE **STATE:** NC **ZIP CODE:** 28273

**PROPERTY LOCATION:** 327 OLD HEBRON RE  
**LEGAL DESC.:** L99-104 P98 & 105-109 **DEED BK,PG & DATE:** 06245 /390 1990-04-02  
**ACREAGE:** 10.000 **SALE PRICE:** \$175,000 **QUALIFIED SALE (Y/N):** Y  
**LAND VALUE:** \$265,460 **IMPVMTS VALUE:** \$0 **TOTAL VALUE:** \$265,460

**LAND-USE TYPE:** VACANT **BUILDING TYPE:** INDUSTRIAL  
**YEAR BUILT:** 0 **SQUARE FEET:** 0 **STYLE CODE:**  
**BEDROOMS:** 0 **BATHROOMS:** 0 **RESTROOMS:** 0 **BASEMENT:** N **GARAGE:** N  
**EXTERIOR TYPE:** **QUALITY GRADE:** 0 **IMPVMT. VALUE:** \$0  
**A/C:** **FIREPLACE:**

**Record No.:** 54 **BUILDING KEY NUMBER:** 20517120 001  
**PARCEL-ID:** 20517120 **NEIGHBORHOOD CODE:** 20501 **ZONING CLASS:** B1  
**OWNER'S NAME:** HONDROS S C ASSOCIATES INC  
**MAILING ADDRESS:** PO BOX 220456  
**CITY:** CHARLOTTE **STATE:** NC **ZIP CODE:** 28220456

**PROPERTY LOCATION:** 9101 NATIONS FORD RE  
**LEGAL DESC.:** NA **DEED BK,PG & DATE:** 04978 /036 1985-02-26  
**ACREAGE:** 8.000 **SALE PRICE:** \$0 **QUALIFIED SALE (Y/N):** N  
**LAND VALUE:** \$0 **IMPVMTS VALUE:** \$0 **TOTAL VALUE:** \$0

**LAND-USE TYPE:** VACANT **BUILDING TYPE:** COMMERCIAL  
**YEAR BUILT:** 0 **SQUARE FEET:** 0 **STYLE CODE:**  
**BEDROOMS:** 0 **BATHROOMS:** 0 **RESTROOMS:** 0 **BASEMENT:** N **GARAGE:** N  
**EXTERIOR TYPE:** **QUALITY GRADE:** 0 **IMPVMT. VALUE:** \$0



**MECKLENBURG COUNTY, NC**  
**GIS PUBLIC ACCESS SYSTEM REPORT**

DATE PRINTED

Note : Records are sorted in Parcel Number order.

PAGE : 19

**Record No.:** 55 **BUILDING KEY NUMBER :** 20517122 001  
**PARCEL-ID :** 20517122 **NEIGHBORHOOD CODE :** 20501 **ZONING CLASS :** I2  
**OWNER'S NAME :** YOUNG DAVID T **% TRI SQUARE CONST CO**  
**MAILING ADDRESS :** 2012 EUCLID AVE  
**CITY :** CHARLOTTE **STATE :** NC **ZIP CODE :** 28203  
**PROPERTY LOCATION :** 319 OLD HEBRON RE  
**LEGAL DESC. :** NA **DEED BK,PG & DATE :** 08227 /208 1995-07-27  
**ACREAGE :** 2.000 **SALE PRICE :** \$330,000 **QUALIFIED SALE (Y/N) :** Y  
**LAND VALUE :** \$119,080 **IMPVMTS VALUE :** \$357,750 **TOTAL VALUE :** \$476,830

**LAND-USE TYPE :** WAREHOUSE/INDUSTRIAL **BUILDING TYPE :** PREFAB WAREHOUSE  
**YEAR BUILT :** 1,997 **SQUARE FEET :** 2,500 **STYLE CODE :** 1.5 STORY  
**BEDROOMS :** 0 **BATHROOMS :** 0 **RESTROOMS :** 0 **BASEMENT :** N **GARAGE :** N  
**EXTERIOR TYPE :** NONE **QUALITY GRADE :** 2 **IMPVMT. VALUE :** \$67,420  
**A/C :** NONE **FIREPLACE :** NONE

**Record No.:** 56 **BUILDING KEY NUMBER :** 20517123 001  
**PARCEL-ID :** 20517123 **NEIGHBORHOOD CODE :** 20501 **ZONING CLASS :** I2  
**OWNER'S NAME :** YOUNG DAVID T **% TRI SQUARE CONST CO**  
**MAILING ADDRESS :** 2012 EUCLID AVE  
**CITY :** CHARLOTTE **STATE :** NC **ZIP CODE :** 28203  
**PROPERTY LOCATION :** 323 OLD HEBRON RE  
**LEGAL DESC. :** NA **DEED BK,PG & DATE :** 08227 /208 1995-07-27  
**ACREAGE :** 2.000 **SALE PRICE :** \$330,000 **QUALIFIED SALE (Y/N) :** Y  
**LAND VALUE :** \$119,080 **IMPVMTS VALUE :** \$357,750 **TOTAL VALUE :** \$476,830

**LAND-USE TYPE :** WAREHOUSE/INDUSTRIAL **BUILDING TYPE :** PREFAB WAREHOUSE  
**YEAR BUILT :** 1,997 **SQUARE FEET :** 2,500 **STYLE CODE :** 1.5 STORY  
**BEDROOMS :** 0 **BATHROOMS :** 0 **RESTROOMS :** 0 **BASEMENT :** N **GARAGE :** N  
**EXTERIOR TYPE :** NONE **QUALITY GRADE :** 2 **IMPVMT. VALUE :** \$67,420  
**A/C :** NONE **FIREPLACE :** NONE

**Record No.:** 57 **BUILDING KEY NUMBER :** 20517124 001  
**PARCEL-ID :** 20517124 **NEIGHBORHOOD CODE :** 20501 **ZONING CLASS :** I2  
**OWNER'S NAME :** BOWERS BILL D  
**MAILING ADDRESS :** 224 RED BARN TRL  
**CITY :** MATTHEWS **STATE :** NC **ZIP CODE :** 281045441  
**PROPERTY LOCATION :** 227 OLD HEBRON RE  
**LEGAL DESC. :** NA **DEED BK,PG & DATE :** 09425 /297 1997-12-30  
**ACREAGE :** 2.000 **SALE PRICE :** \$334,500 **QUALIFIED SALE (Y/N) :** N  
**LAND VALUE :** \$125,470 **IMPVMTS VALUE :** \$176,720 **TOTAL VALUE :** \$302,190

**LAND-USE TYPE :** WAREHOUSE/INDUSTRIAL **BUILDING TYPE :** WAREHOUSE  
**YEAR BUILT :** 1,982 **SQUARE FEET :** 9,200 **STYLE CODE :** 1.5 STORY  
**BEDROOMS :** 0 **BATHROOMS :** 0 **RESTROOMS :** 0 **BASEMENT :** Y **GARAGE :** N  
**EXTERIOR TYPE :** NONE **QUALITY GRADE :** 3 **IMPVMT. VALUE :** \$176,720  
**A/C :** NONE **FIREPLACE :** NONE



# MECKLENBURG COUNTY, NC

## GIS PUBLIC ACCESS SYSTEM REPORT

DATE PRINTED

Note : Records are sorted in Parcel Number order.

PAGE : 20

**Record No.:** 58      **BUILDING KEY NUMBER :** 20517127 001  
**PARCEL-ID :** 20517127      **NEIGHBORHOOD CODE :** 20501      **ZONING CLASS :** BP  
**OWNER'S NAME :** ALISAN J INC  
**MAILING ADDRESS :** 750 IMPERIAL CT  
**CITY :** CHARLOTTE      **STATE :** NC      **ZIP CODE :** 28273

**PROPERTY LOCATION :** 750 IMPERIAL CT  
**LEGAL DESC. :** L10 & 11 M24-296      **DEED BK,PG & DATE :** 07540 /125 1993-11-12  
**ACREAGE :** 2.000      **SALE PRICE :** \$165,000      **QUALIFIED SALE (Y/N) :** Y  
**LAND VALUE :** \$161,000      **IMPVMTS VALUE :** \$986,010      **TOTAL VALUE :** \$1,147,010

**LAND-USE TYPE :** WAREHOUSE/INDUSTRIAL      **BUILDING TYPE :** WAREHOUSE  
**YEAR BUILT :** 1,995      **SQUARE FEET :** 11,777      **STYLE CODE :** 10 STOREY  
**BEDROOMS :** 0      **BATHROOMS :** 0      **BASEMENT :** N      **GARAGE :** N  
**EXTERIOR TYPE :** COMMON BRICK      **QUALITY GRADE :** 3      **IMPVMT. VALUE :** \$483,920  
**A/C :** CENTRAL      **FIREPLACE :** NONE

**OWNER'S NAME :** BARWICK ALLAN  
**MAILING ADDRESS :** 1824 WALDEN FOND LN  
**CITY :** WAXHAW      **STATE :** NC      **ZIP CODE :** 28173

**PROPERTY LOCATION :** 725 IMPERIAL CT  
**LEGAL DESC. :** L15 M26-759      **DEED BK,PG & DATE :** 08158 /482 1995-05-30  
**ACREAGE :** 3.000      **SALE PRICE :** \$110,000      **QUALIFIED SALE (Y/N) :** N  
**LAND VALUE :** \$171,240      **IMPVMTS VALUE :** \$524,480      **TOTAL VALUE :** \$705,720

**LAND-USE TYPE :** WAREHOUSE/INDUSTRIAL      **BUILDING TYPE :** WAREHOUSE  
**YEAR BUILT :** 1,995      **SQUARE FEET :** 11,777      **STYLE CODE :** 10 STOREY  
**BEDROOMS :** 0      **BATHROOMS :** 0      **BASEMENT :** N      **GARAGE :** N  
**EXTERIOR TYPE :** COMMON BRICK      **QUALITY GRADE :** 3      **IMPVMT. VALUE :** \$483,920  
**A/C :** CENTRAL      **FIREPLACE :** NONE

**Record No.:** 60      **BUILDING KEY NUMBER :** 20517130 001  
**PARCEL-ID :** 20517130      **NEIGHBORHOOD CODE :** 20501      **ZONING CLASS :** BP  
**OWNER'S NAME :** ARROWOOD LTD PARTNERSHIP  
**MAILING ADDRESS :** PO BOX 7718  
**CITY :** FLINT      **STATE :** MI      **ZIP CODE :** 48507

**PROPERTY LOCATION :** 710 PENINSULA LN  
**LEGAL DESC. :** NA      **DEED BK,PG & DATE :** 05164 /708 1986-01-30  
**ACREAGE :** 6.000      **SALE PRICE :** \$0      **QUALIFIED SALE (Y/N) :** N  
**LAND VALUE :** \$399,360      **IMPVMTS VALUE :** \$0      **TOTAL VALUE :** \$399,360

**LAND-USE TYPE :** VACANT      **BUILDING TYPE :** OFFICE WAREHOUSE  
**YEAR BUILT :** 0      **SQUARE FEET :** 0      **STYLE CODE :**  
**BEDROOMS :** 0      **BATHROOMS :** 0      **BASEMENT :** N      **GARAGE :** N  
**EXTERIOR TYPE :**      **QUALITY GRADE :** 0



**MECKLENBURG COUNTY, NC**  
**GIS PUBLIC ACCESS SYSTEM REPORT**

DATE PRINTED

Note : Records are sorted in Parcel Number order.

PAGE : 21

**Record No.:** 61 **BUILDING KEY NUMBER :** 20517131 001  
**PARCEL-ID :** 20517131 **NEIGHBORHOOD CODE :** 20501 **ZONING CLASS :** BD  
**OWNER'S NAME :** EQUITY INVESTMENT PARTNERS LLC  
**MAILING ADDRESS :** 730 WINDSOR CT  
**CITY :** CHARLOTTE **STATE :** NC **ZIP CODE :** 282736946

**PROPERTY LOCATION :** 730 WINDSOR OAK CT  
**LEGAL DESC. :** LA & B M27-287 **DEED BK,PG & DATE :** 08308 /342 1995-09-29  
**ACREAGE :** 2.000 **SALE PRICE :** \$67,500 **QUALIFIED SALE (Y/N) :** Y  
**LAND VALUE :** \$87,540 **IMPVMTS VALUE :** \$482,100 **TOTAL VALUE :** \$569,640

**LAND-USE TYPE :** VACANT **BUILDING TYPE :** CT  
**YEAR BUILT :** 0 **SQUARE FEET :** 0 **STYLE CODE :**  
**BEDROOMS :** 0 **BATHROOMS :** 0 **RESTROOMS :** 0 **BASEMENT :** N **GARAGE :** N  
**EXTERIOR TYPE :** CENTRAL **QUALITY GRADE :** 0 **IMPVMT. VALUE :** \$0  
**A/C :** CENTRAL **FIREPLACE :** NONE

**OWNER'S NAME :** LISA WILSON JERRY MYERS  
**MAILING ADDRESS :** 1100 SCALLYBARK RD  
**CITY :** CHARLOTTE **STATE :** NC **ZIP CODE :** 28209

**PROPERTY LOCATION :** SWEDEN RE  
**LEGAL DESC. :** NA **DEED BK,PG & DATE :** 05176 /891 1986-01-09  
**ACREAGE :** 2.000 **SALE PRICE :** \$10,000 **QUALIFIED SALE (Y/N) :** N  
**LAND VALUE :** \$11,520 **IMPVMTS VALUE :** \$0 **TOTAL VALUE :** \$11,520

**LAND-USE TYPE :** VACANT **BUILDING TYPE :** INDUSTRIAL  
**YEAR BUILT :** 0 **SQUARE FEET :** 0 **STYLE CODE :**  
**BEDROOMS :** 0 **BATHROOMS :** 0 **RESTROOMS :** 0 **BASEMENT :** N **GARAGE :** N  
**EXTERIOR TYPE :** **QUALITY GRADE :** 0 **IMPVMT. VALUE :** \$0  
**A/C :** **FIREPLACE :**

**Record No.:** 63 **BUILDING KEY NUMBER :** 20517134 001  
**PARCEL-ID :** 20517134 **NEIGHBORHOOD CODE :** 20501 **ZONING CLASS :** BP  
**OWNER'S NAME :** GRAND CRU PROPERTIES LLC % PRISTIGE WINES INC  
**MAILING ADDRESS :** 720 IMPERIAL CT  
**CITY :** CHARLOTTE **STATE :** NC **ZIP CODE :** 28273

**PROPERTY LOCATION :** WINDSOR OAK CT  
**LEGAL DESC. :** L9 M30-629 **DEED BK,PG & DATE :** 10701 /884 1999-08-19  
**ACREAGE :** 1.000 **SALE PRICE :** \$0 **QUALIFIED SALE (Y/N) :** N  
**LAND VALUE :** \$69,700 **IMPVMTS VALUE :** \$0 **TOTAL VALUE :** \$69,700

**LAND-USE TYPE :** VACANT **BUILDING TYPE :** INDUSTRIAL  
**YEAR BUILT :** 0 **SQUARE FEET :** 0 **STYLE CODE :**  
**BEDROOMS :** 0 **BATHROOMS :** 0 **RESTROOMS :** 0 **BASEMENT :** N **GARAGE :** N  
**EXTERIOR TYPE :** **QUALITY GRADE :** 0 **IMPVMT. VALUE :** \$0



# MECKLENBURG COUNTY, NC

DATE PRINTED

## GIS PUBLIC ACCESS SYSTEM REPORT

Note : Records are sorted in Parcel Number order.

PAGE : 22

**Record No.:** 64      **BUILDING KEY NUMBER:** 20517135 001  
**PARCEL-ID:** 20517135      **NEIGHBORHOOD CODE:** 20501      **ZONING CLASS:** BP  
**OWNER'S NAME:** GRAND CRU PROPERTIES LLC      % PRESTIGE WINES INC  
**MAILING ADDRESS:** 720 IMPERIAL CT  
**CITY:** CHARLOTTE      **STATE:** NC      **ZIP CODE:** 28273

**PROPERTY LOCATION:** IMPERIAL      CT  
**LEGAL DESC.:** L12 M30-629      **DEED BK,PG & DATE:** 10701 /884 1999-08-19  
**ACREAGE:** 1.000      **SALE PRICE:** \$0      **QUALIFIED SALE (Y/N):** N  
**LAND VALUE:** \$69,700      **IMPVMTS VALUE:** \$847,560      **TOTAL VALUE:** \$917,260

**LAND-USE TYPE:** RESIDENTIAL      **BUILDING TYPE:** VACANT  
**YEAR BUILT:** 0      **SQUARE FEET:** 0      **STYLE CODE:** 0  
**BEDROOMS:** 0      **BATHROOMS:** 0      **RESTROOMS:** 0      **BASEMENT:** N      **GARAGE:** N  
**EXTERIOR TYPE:** NONE      **QUALITY GRADE:** 3      **IMPVMT. VALUE:** \$0  
**A/C:** NONE      **FIREPLACE:** NONE

**MAILING ADDRESS:** 3840 V. WEDGE BLVD  
**CITY:** FAIRFIELD      **STATE:** OE      **ZIP CODE:** 450147565

**PROPERTY LOCATION:** E ARROWOOD      RE  
**LEGAL DESC.:** GREENWAY M34-525      **DEED BK,PG & DATE:** 10821 /049 1999-10-07  
**ACREAGE:** 4.000      **SALE PRICE:** \$0      **QUALIFIED SALE (Y/N):** Y  
**LAND VALUE:** \$30,970      **IMPVMTS VALUE:** \$0      **TOTAL VALUE:** \$30,970

**LAND-USE TYPE:** VACANT      **BUILDING TYPE:** NEW PARCEL  
**YEAR BUILT:** 0      **SQUARE FEET:** 0      **STYLE CODE:** 0  
**BEDROOMS:** 0      **BATHROOMS:** 0      **RESTROOMS:** 0      **BASEMENT:** N      **GARAGE:** N  
**EXTERIOR TYPE:** NONE      **QUALITY GRADE:** 0      **IMPVMT. VALUE:** \$0  
**A/C:** NONE      **FIREPLACE:** NONE

**Record No.:** 66      **BUILDING KEY NUMBER:** 20517137 001  
**PARCEL-ID:** 20517137      **NEIGHBORHOOD CODE:** 20501      **ZONING CLASS:** BP  
**OWNER'S NAME:** LEMRAC INC  
**MAILING ADDRESS:** 8030 ENGLAND ST  
**CITY:** CHARLOTTE      **STATE:** NC      **ZIP CODE:** 28273

**PROPERTY LOCATION:** PENINSULA      LN  
**LEGAL DESC.:** L2 M35-239      **DEED BK,PG & DATE:** 12328 /667 2001-06-12  
**ACREAGE:** 3.000      **SALE PRICE:** \$190,000      **QUALIFIED SALE (Y/N):** N  
**LAND VALUE:** \$17,710      **IMPVMTS VALUE:** \$107,710      **TOTAL VALUE:** \$1,016,480

**LAND-USE TYPE:** WAREHOUSE/INDUSTRIAL      **BUILDING TYPE:** OFFICE/WAREHOUSE  
**YEAR BUILT:** 2,001      **SQUARE FEET:** 24,849      **STYLE CODE:** 1.0 STORY  
**BEDROOMS:** 0      **BATHROOMS:** 0      **RESTROOMS:** 0      **BASEMENT:** N      **GARAGE:** N  
**EXTERIOR TYPE:** CONCRETE      **QUALITY GRADE:** 2      **IMPVMT. VALUE:** \$0  
**A/C:** NONE      **FIREPLACE:** NONE





# MECKLENBURG COUNTY, NC

## GIS PUBLIC ACCESS SYSTEM REPORT

DATE PRINTED

Note : Records are sorted in Parcel Number order.

PAGE : 23

**Record No.:** 67      **BUILDING KEY NUMBER :** 20517139 001  
**PARCEL-ID :** 20517139      **NEIGHBORHOOD CODE :** 20501      **ZONING CLASS :** BP  
**OWNER'S NAME :** CAROLINAS ROOFING AND SHEET      METAL CONTRACTORS ASSOC INC  
**MAILING ADDRESS :** 4335 STUART ANDREW BLVD #100  
**CITY :** CHARLOTTE      **STATE :** NC      **ZIP CODE :** 28217

**PROPERTY LOCATION :** IMPERIAL      CT  
**LEGAL DESC. :** L13 M36-461      **DEED BK,PG & DATE :** 13065 /835 2001-12-21  
**ACREAGE :** 2.000      **SALE PRICE :** \$82,000      **QUALIFIED SALE (Y/N) :** Y  
**LAND VALUE :** \$154,730      **IMPVMTS VALUE :** \$0      **TOTAL VALUE :** \$154,730

**BATHROOMS :**      **BEDROOMS :**      **HALL ROOMS :**      **KITCHEN :**      **LIVING ROOMS :**      **PORCH :**      **SCREENED PORCH :**      **WALK OUT :**      **WATER :**      **WELL :**

**POOL :**      **POOL TYPE :**      **POOL MATERIAL :**      **POOL YEAR :**      **POOL COVER :**      **POOL COVER TYPE :**      **POOL COVER YEAR :**      **POOL COVER MATERIAL :**      **POOL COVER YEAR :**      **POOL COVER MATERIAL :**

**AC :**      **FIREPLACE :**

Petition #: 2002-71

Petitioner: Liberty Oak, Inc.

Hearing Date: June 17, 2002

Zoning Classification (Existing): R-17MF(CD)

Zoning Classification (Requested): R-12MF(CD)

Acresage & Location Approximately 22.3 acres located on the south side of Arrowood Road, east of Nations Ford Road.

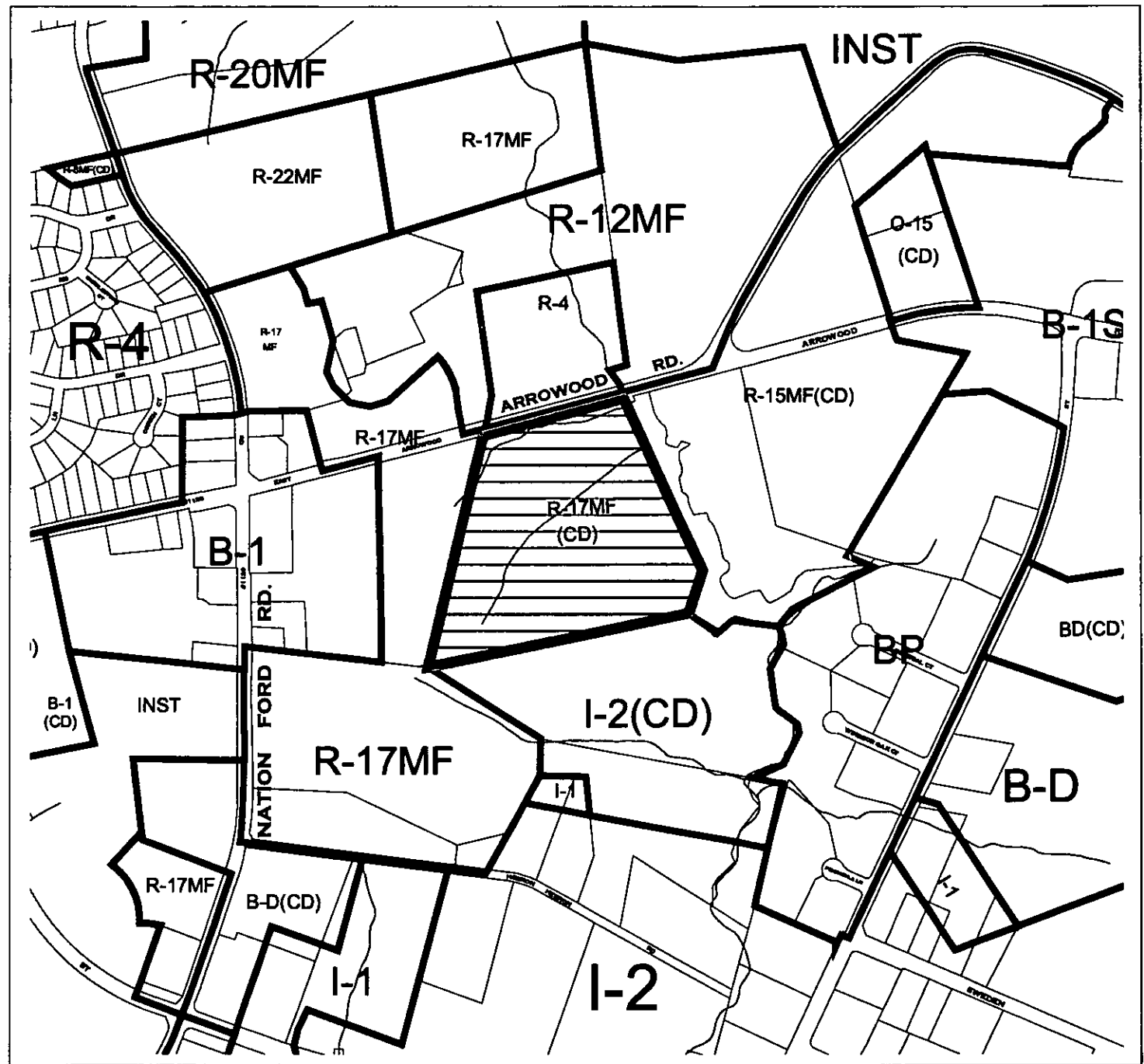

Zoning Map #(s); 148

**Map Legend**

|  |                   |  |              |
|--|-------------------|--|--------------|
|  | ETU               |  | Foodplnt/lyp |
|  | Almsbshp          |  | County Line  |
|  | Washshd           |  | City Unltpnc |
|  | Historic District |  |              |