



\* 0 0 B R E A K 0 0 \*



**ADVANCED  
IMAGING  
SYSTEMS**

www.aisimc.com

An Information  
Management Company

# City of Charlotte – Planning Dept. Scanning Rezoning Files

Petition # \_\_\_\_\_

## Document type:

- Applications
- Correspondence
- Department Comments
- Land Use Consistency
  - Mail Info
  - Mapping
  - Other
- Site Plans



\* 0 0 B R E A K 0 0 \*

# MECKLENBURG COUNTY, NC GIS PUBLIC ACCESS SYSTEM

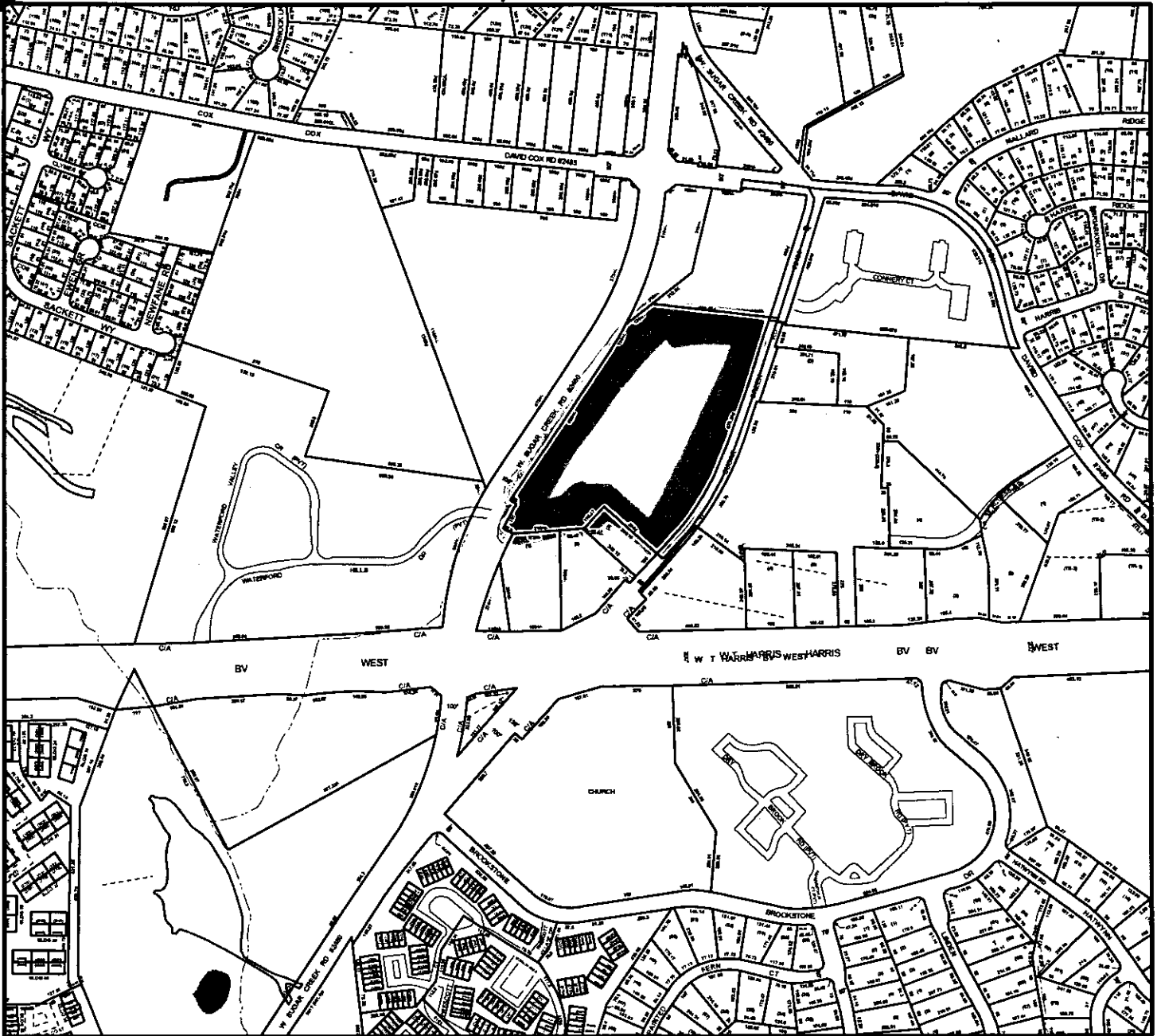

Tax Parcel-Id#s Selected: See Tax Information Report for List of Parcel-Id#s

Tax Book & Page Selected: N/A

**LEGEND**

- County Boundary
- Rivers/Creeks/Streams
- Railroad ROW
- Water Bodies

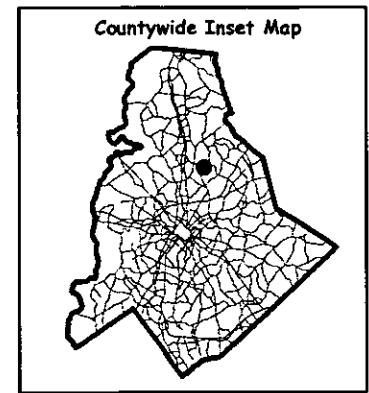
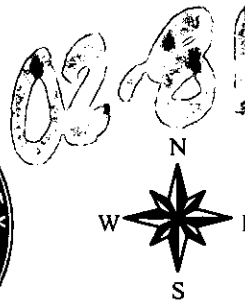

Scale : 1 Inch = 600 Feet  
 Map Created on Tuesday, May 7, 2002 01:46 PM

This map is prepared for the inventory of real property within Mecklenburg County and is compiled from recorded deeds, plats, tax maps, surveys, planimetric maps, and other public records and data. Users of this map are hereby notified that the aforementioned public primary information sources should be consulted for verification. Mecklenburg County and its mapping contractors assume no legal responsibility for the information contained herein.

Petition #: **2002-81**

Petitioner: Crosland, Inc.

Hearing Date: September 17, 2002

Zoning Classification (Existing): CC

Zoning Classification (Requested): CC Site Plan Amendment

Acreeage & Location Approximately 11.64 acres located between West Sugar Creek Road and Cheshire Road, north of West W. T. Harris Boulevard

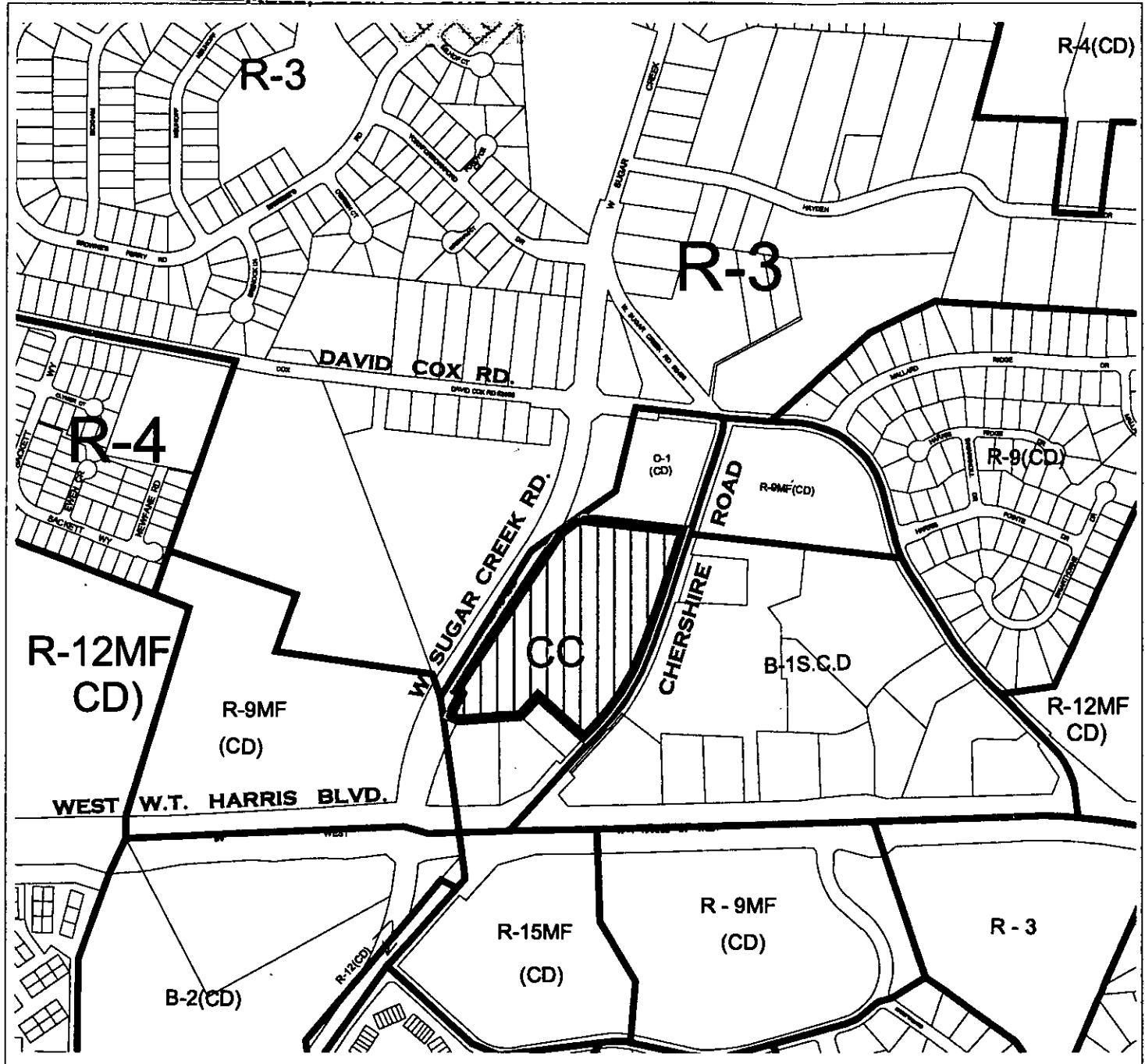

Zoning Map #(s);

**52**

**Map Legend**

	EIU		Floodplain/shp
	Airphoto/shp		County Line
	Watershed		City Limits(parc)
	Historic District		