

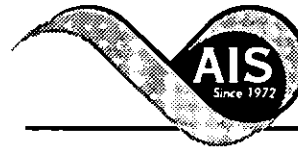

* 0 0 B R E A K 0 0 *



**ADVANCED
IMAGING
SYSTEMS**

An Information
Management Company

www.aisimc.com

City of Charlotte – Planning Dept. Scanning Rezoning Files

Petition # _____

Document type:

- Applications
- Correspondence
- Department Comments
- Land Use Consistency
 - Mail Info
 - Mapping
 - Other
- Site Plans



* 0 0 B R E A K 0 0 *

Petition #: **2002-107**

Petitioner: **NFM Properties, LLC**

Hearing Date: **October 23, 2002**

Zoning Classification (Existing): **I-2**

Zoning Classification (Requested): **MUDD-O**

Acresage & Location **Approximately 1.9 acres located at the southeast corner of South Church Street and West Bland Street**

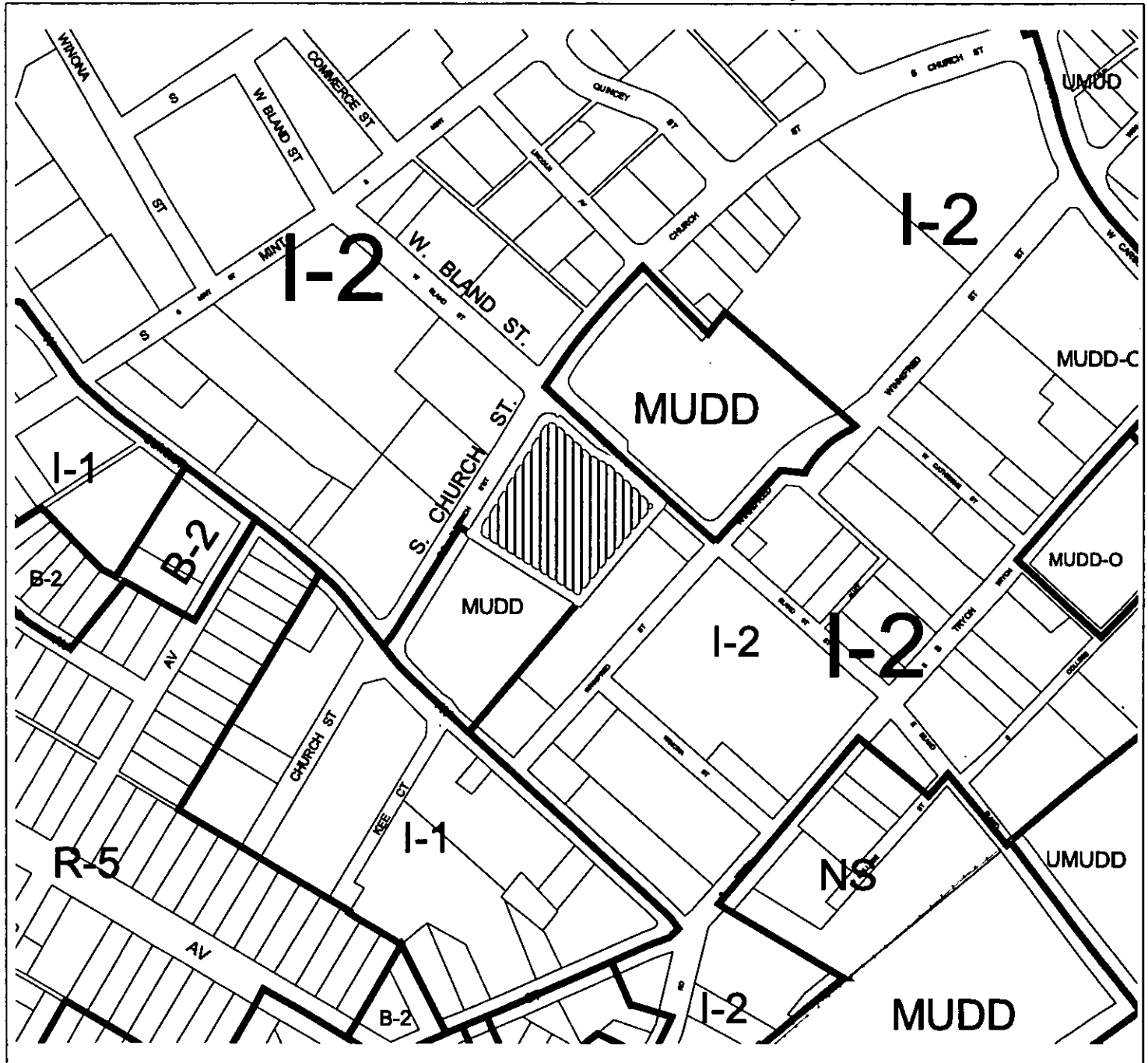

Zoning Map #(s): **102**

Map Legend

	ETU		Plat/Block Map
	Altitude Map		County Line
	Watershed		City Limit(s)
	Historic District		

MECKLENBURG COUNTY, NC GIS PUBLIC ACCESS SYSTEM

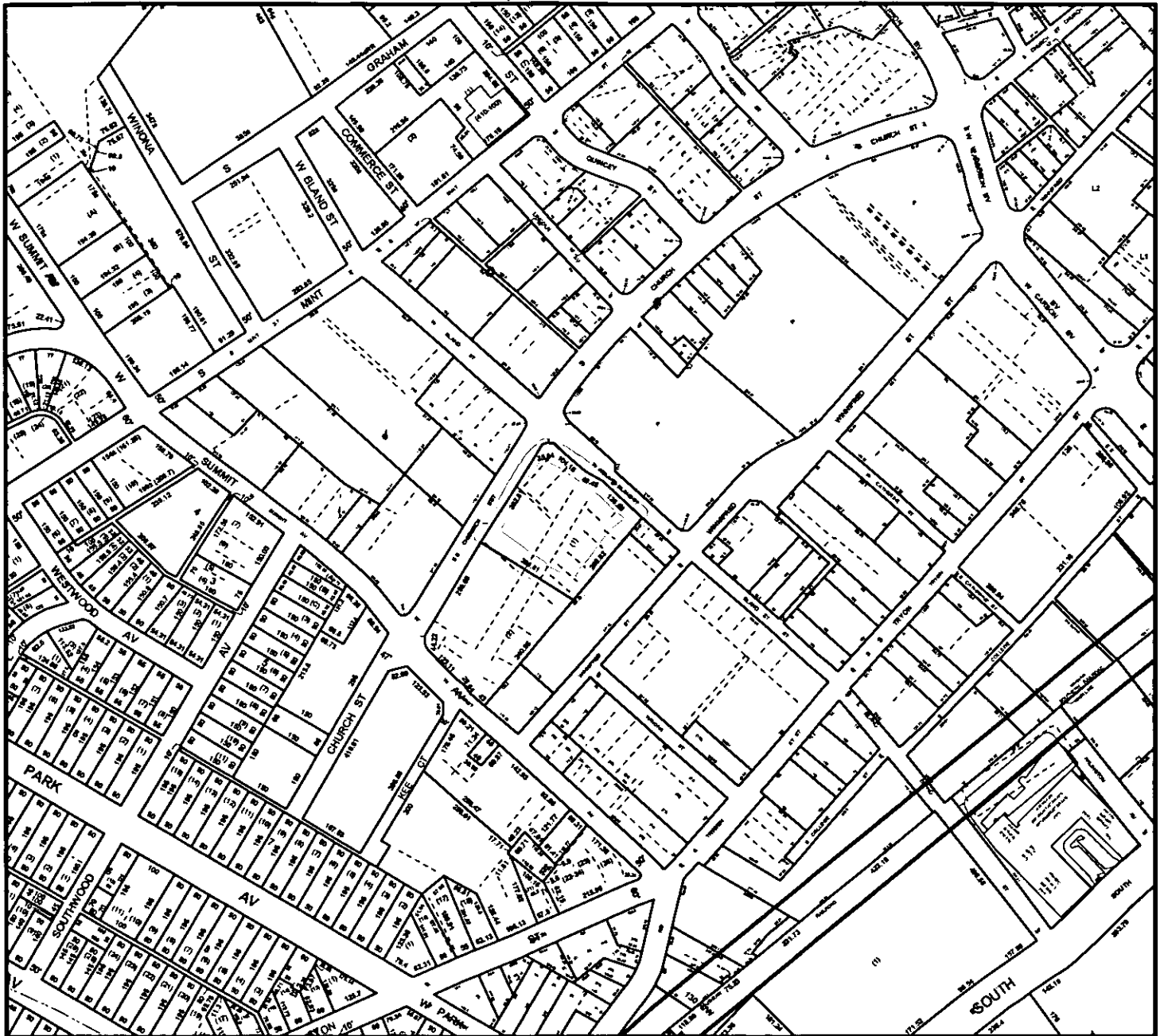

Tax Parcel-Ids Selected: See Tax Information Report for List of Parcel-Ids

Tax Book & Page Selected: N/A

02-107

LEGEND

- County Boundary
- Rivers/Creeks/Streams
- Railroad ROW
- Water Bodies

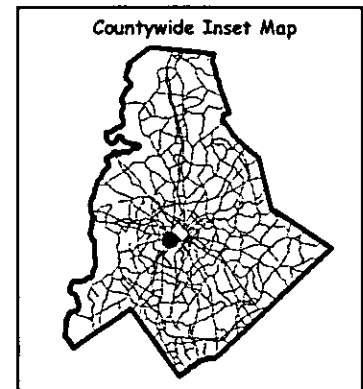
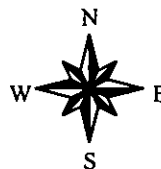

Scale : 1 Inch = 400 Feet
 Map Created on Wednesday, October 9, 2002 03:29 PM

This map is prepared for the inventory of real property within Mecklenburg County and is compiled from recorded deeds, plats, tax maps, surveys, planimetric maps, and other public records and data. Users of this map are hereby notified that the aforementioned public primary information sources should be consulted for verification. Mecklenburg County and its mapping contractors assume no legal responsibility for the information contained herein.

02-107

Zone	ODzone_area
1	0.021562
2	0.028560
3	0.044092
4	0.057789
5	0.061914
8	0.094302
9	0.079433
10	0.108199
11	0.074612
12	0.062949
13	0.051511
14	0.204910
15	0.311937
16	0.132046
17	0.160859
18	0.365655
19	0.209830
20	0.244424
144	0.433422
145	0.228744
146	0.322869
147	0.345543
148	0.547574
149	0.396737
152	0.491220
177	0.663447
182	0.507222
183	0.407781
184	0.242041

02-108

Zone	ODzone_area
5	0.061914
14	0.204910
15	0.311937
23	0.090022
24	0.121539
25	0.210799
26	0.496561
28	0.142641
29	0.377861
31	0.310383
32	0.299922
33	0.723544
91	0.247106
92	0.199598
93	0.105638
94	0.590257
95	0.275327
96	0.127572
97	0.181438
102	0.390901
184	0.242041

02-109
02-109

Zone	ODzone_area
26	0.496561
29	0.377861
30	0.430585
31	0.310383
32	0.299922
36	0.257936
37	0.147616
38	0.857688
39	0.512577
40	0.318134
203	0.862529
216	0.220756
217	0.204563
218	0.320833
219	0.318431
220	0.368085
221	0.822370
223	0.232762
224	0.560234

Zone	ODzone_area
245	1.493631
246	0.754615
411	1.986975
415	0.350315
416	0.449994
417	0.353577
418	1.445339
420	1.836784
423	4.292044

02-110

Zone	ODzone_area
245	1.493631
411	1.986975
415	0.350315
416	0.449994
417	0.353577
418	1.445339
420	1.836784
421	1.121783
423	4.292044

02-111

Zone	ODzone_area
256	1.970706
266	1.241634
267	1.529777
268	2.879760
269	1.255808
270	2.248349
276	2.646459

02-112

Zone	ODzone_area
196	1.227998
197	0.342433
199	0.476548
203	0.862529
208	0.452429
211	0.572777
229	0.216123
230	0.573027
231	1.142991
232	0.632769
233	1.050568
234	0.454959
235	0.486264
406	1.421952

02-113

02-114

Zone	ODzone_area
8	0.094302
9	0.079433
10	0.108199
17	0.160859
18	0.365655
19	0.209830
20	0.244424
148	0.547574
149	0.396737
179	0.466848
180	0.495103
181	0.268776
182	0.507222
183	0.407781
184	0.242041
185	0.446015
186	0.615251
187	1.309623
200	0.348954
201	0.358679
202	0.247828
204	0.209841
205	0.222251
206	0.241956
209	0.358374

02-115

Zone	ODzone_area
195	0.766344
203	0.862529
206	0.241956
207	0.626268
208	0.452429
209	0.358374
210	0.360726
211	0.572777
213	0.863915
214	0.397754
215	0.343661
217	0.204563
218	0.320833
219	0.318431

02-116

Zone	ODzone_area
26	0.496561
29	0.377861
30	0.430585
31	0.310383
32	0.299922
36	0.257936
37	0.147616
38	0.857688
39	0.512577
40	0.318134
203	0.862529
216	0.220756
217	0.204563
218	0.320833
219	0.318431
220	0.368085
221	0.822370
223	0.232762
224	0.560234
225	0.746324

Zone	ODzone_area
353	1.385216
354	1.892744
355	1.920794
357	4.832229
358	4.650979
359	2.444656
360	1.845285
361	2.082869

02-117

Zone	ODzone_area
162	0.799356
351	0.688967
352	2.305380
361	2.082869
362	1.142269
363	2.355592
364	0.526410
367	2.526150

02-118

Zone	ODzone_area
251	3.221238
252	1.248428
253	2.726586
254	1.886081
256	1.970706
257	0.701286
258	0.937818

02-119

Zone	ODzone_area
196	1.227998
197	0.342433
203	0.862529
208	0.452429
211	0.572777
229	0.216123
230	0.573027
231	1.142991
232	0.632769
233	1.050568
234	0.454959
235	0.486264
405	2.239508

02-120