

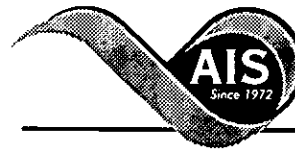

* 0 0 B R E A K 0 0 *



**ADVANCED
IMAGING
SYSTEMS**

www.aisimc.com

An Information
Management Company

City of Charlotte – Planning Dept. Scanning Rezoning Files

Petition # _____

Document type:

- Applications
- Correspondence
- Department Comments
- Land Use Consistency
 - Mail Info
 - Mapping
 - Other
- Site Plans



* 0 0 B R E A K 0 0 *

MECKLENBURG COUNTY, NC GIS PUBLIC ACCESS SYSTEM

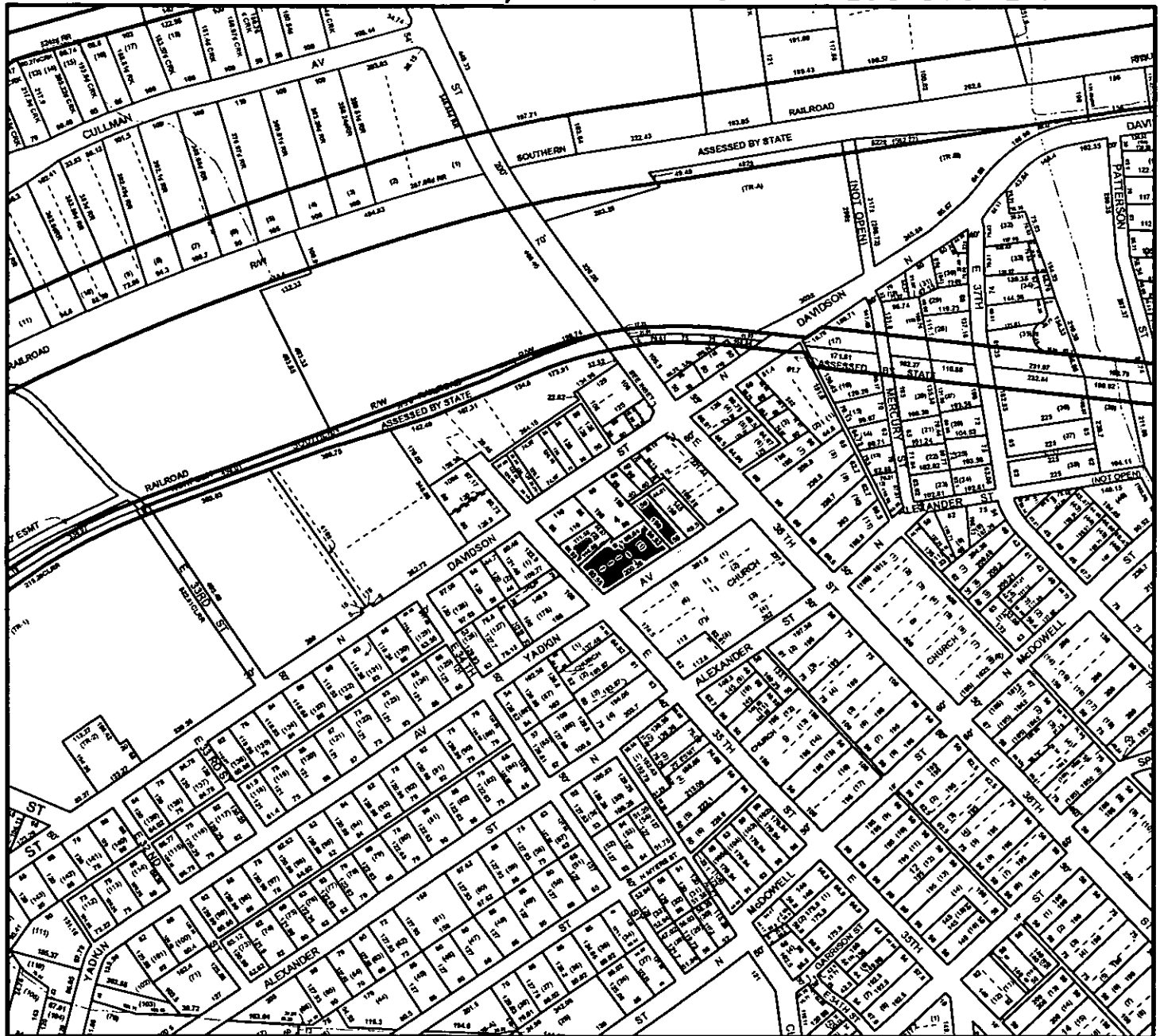

Tax Parcel-Ids Selected: See Tax Information Report for List of Parcel-Ids

Tax Book & Page Selected: NA

LEGEND

- County Boundary
- Rivers/Creeks/Streams
- Railroad ROW
- Water Bodies



02-116

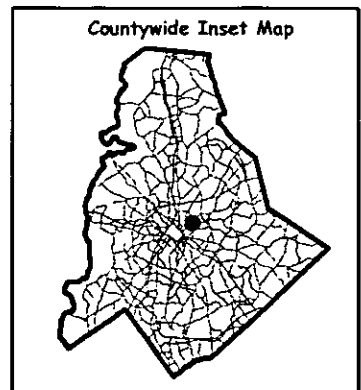
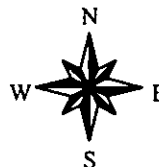

Scale : 1 Inch = 400 Feet
 Map Created on Thursday, November 21, 2002 02:10 PM

This map is prepared for the inventory of real property within Mecklenburg County and is compiled from recorded deeds, plats, tax maps, surveys, planimetric maps, and other public records and data. Users of this map are hereby notified that the aforementioned public primary information sources should be consulted for verification. Mecklenburg County and its mapping contractors assume no legal responsibility for the information contained herein.

(Zoning map 89)

Petition #: 2002-116

Petitioner: Mullaney, Sires and Lyons

Hearing Date: November 18, 2002

Zoning Classification (Existing): R-5 and O-2

Zoning Classification (Requested): MUDD-O

Acres & Location Approximately 1.03 acres located at the northwest corner of the intersection of East 35th Street and Yadkin Avenue

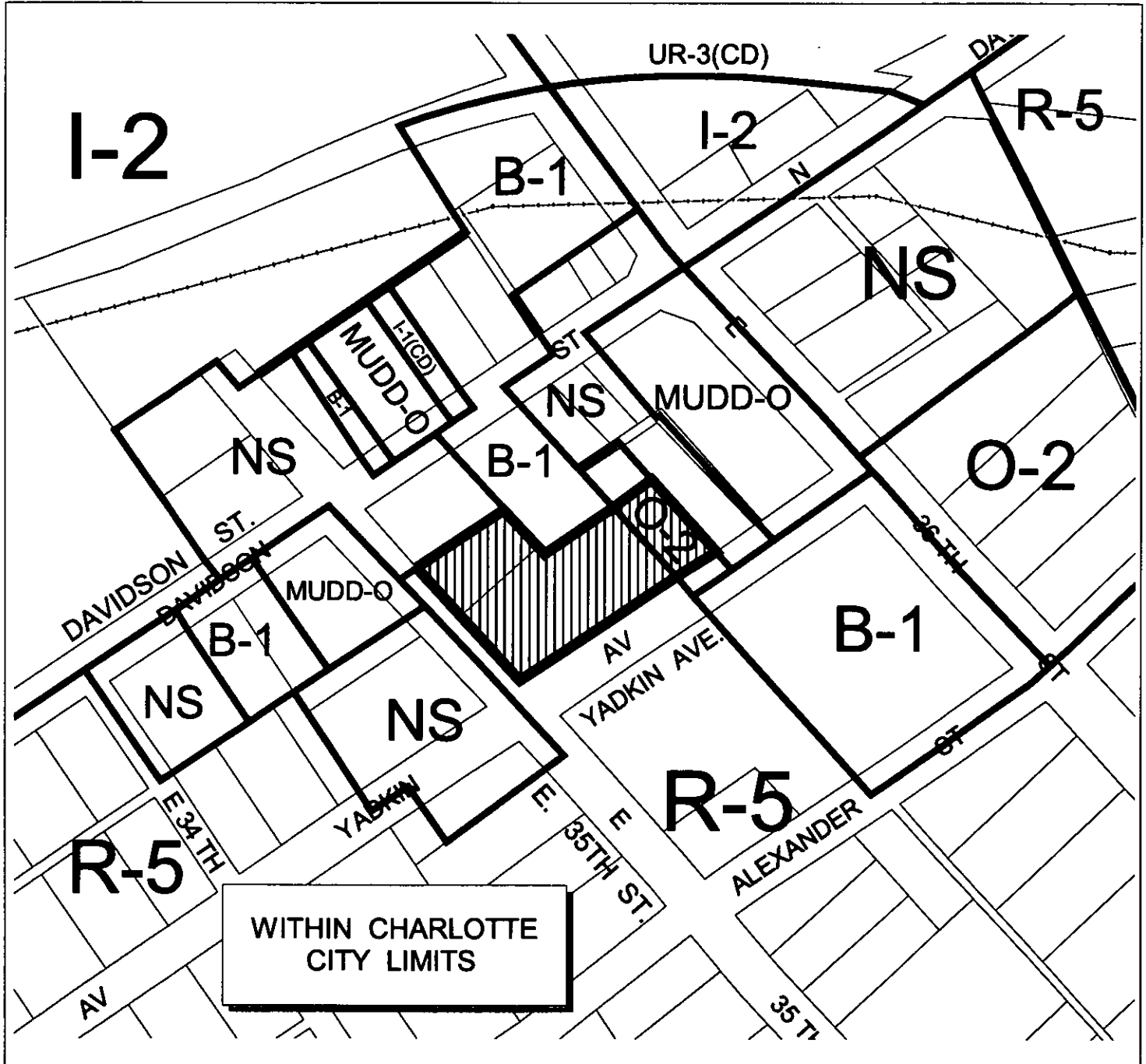

Zoning Map #(s); 89

Map Legend

	ETJ		Floodplain
	Abandonment		County Line
	Watershed		City Unincorporated
	Historic District		

MECKLENBURG COUNTY, NC GIS PUBLIC ACCESS SYSTEM



Tax Parcel-Ids Selected: See Tax Information Report for List of Parcel-Ids#s

Tax Book & Page Selected: N/A

LEGEND

- County Boundary
- Rivers/Creeks/Streams
- Railroad ROW
- Water Bodies



02-116

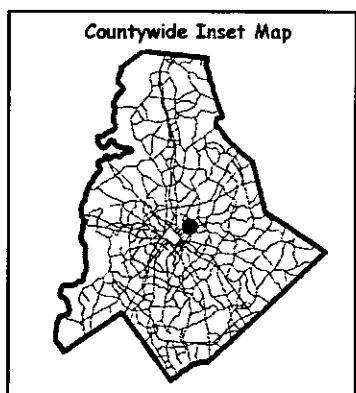
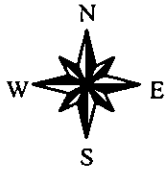

Scale : 1 Inch = 400 Feet

Map Created on Monday, October 14, 2002 02:45 PM

This map is prepared for the inventory of real property within Mecklenburg County and is compiled from recorded deeds, plats, tax maps, surveys, planimetric maps, and other public records and data. Users of this map are hereby notified that the aforementioned public primary information sources should be consulted for verification. Mecklenburg County and its mapping contractors assume no legal responsibility for the information contained herein.

Petition #: 2002-116

Petitioner: Mullaney, Sires and Lyons

Hearing Date: October 23, 2002

Zoning Classification (Existing): R-5

Zoning Classification (Requested): MUDD(CD)

Acreage & Location: Approximately 0.61 acres located on the northwest corner East 35th Street and Yadkin Avenue

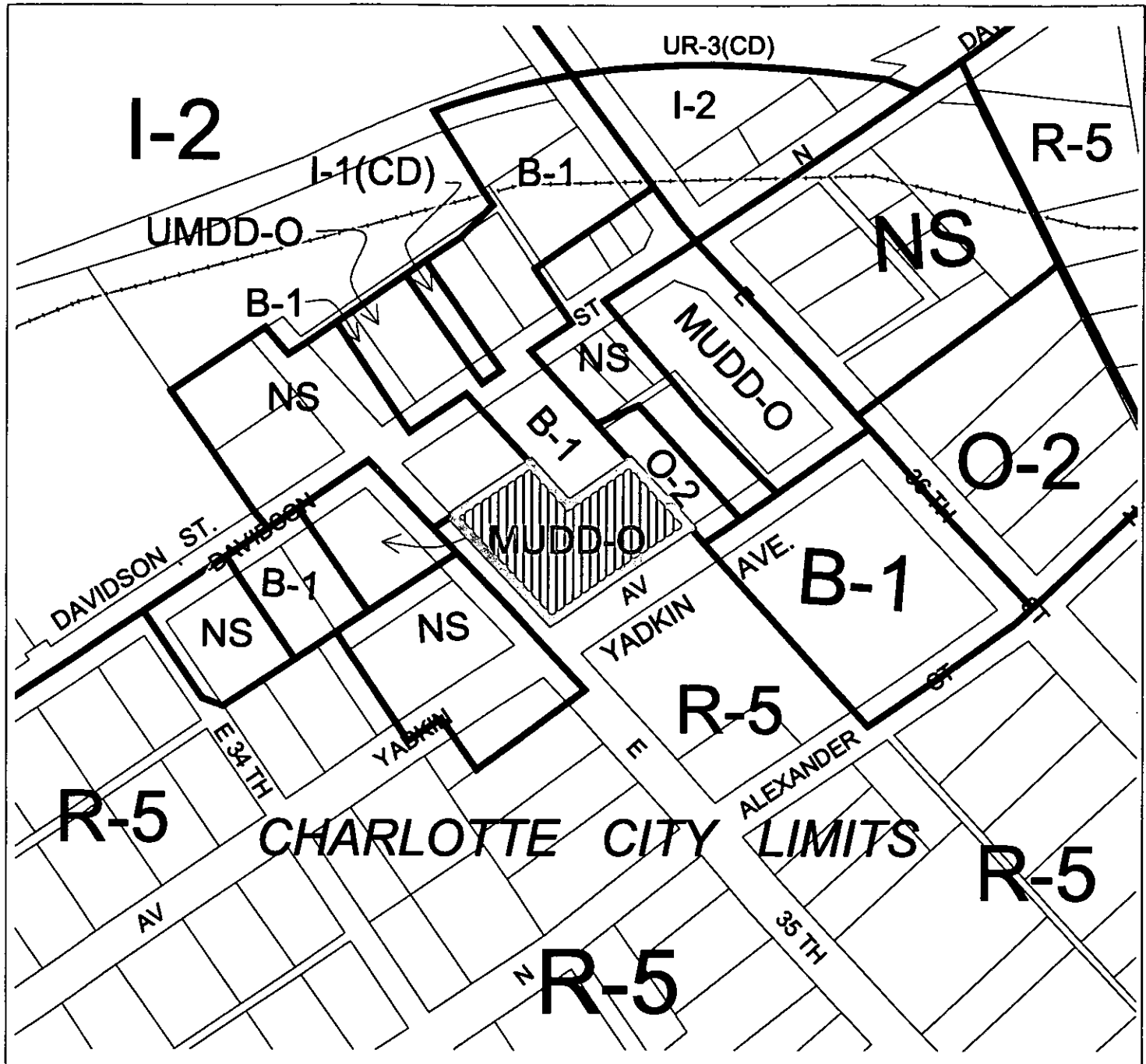

Zoning Map #(s):

89

Charlotte-Mecklenburg Planning Commission

Map Legend

	ETU		Platification
	Altitude		County Line
	Wetland		City Limits
	Historic District		

MECKLENBURG COUNTY, NC GIS PUBLIC ACCESS SYSTEM

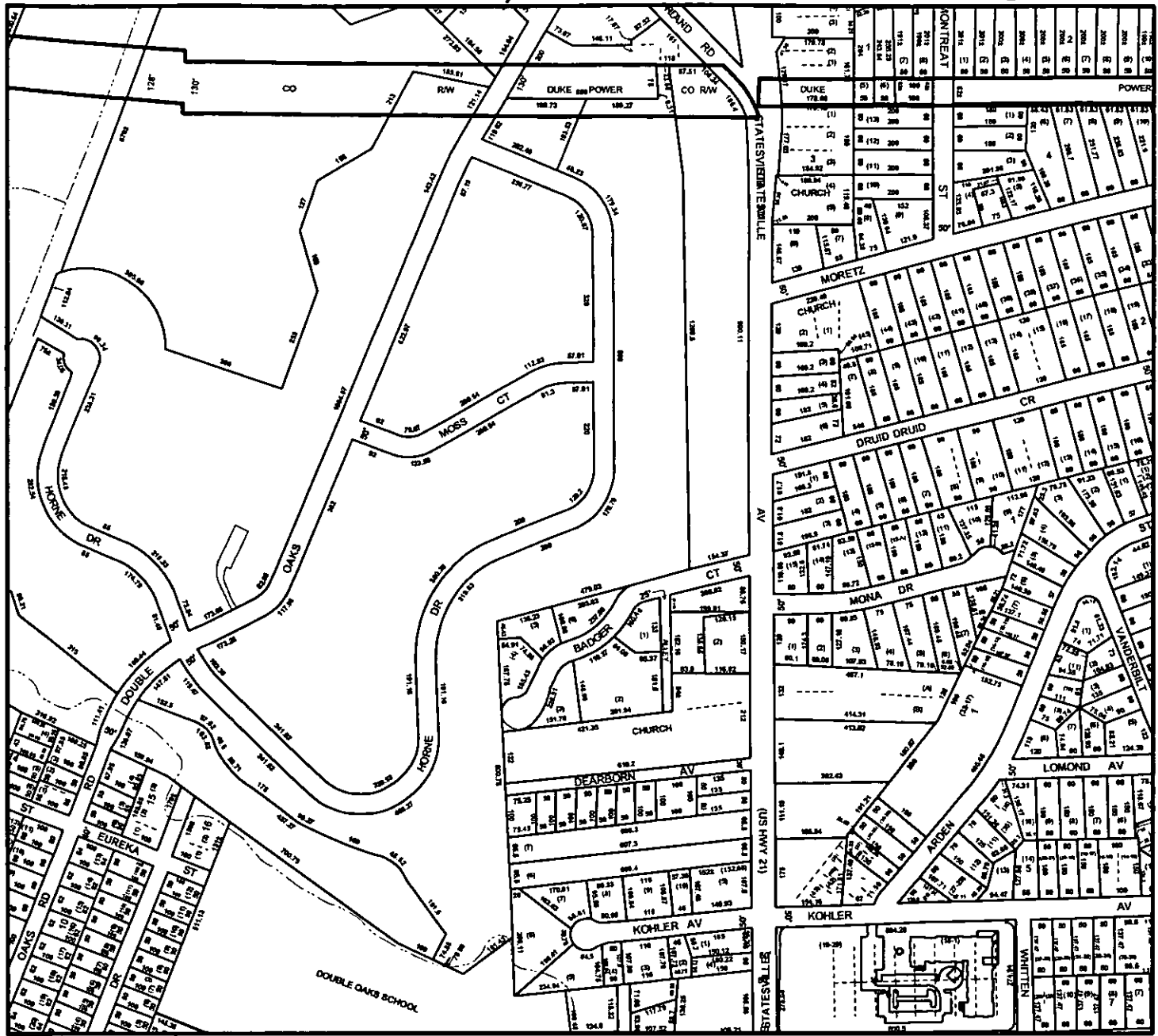

Tax Parcel-Id#s Selected: See Tax Information Report for List of Parcel-Id#s

Tax Book & Page Selected: N/A

LEGEND

- County Boundary
- Rivers/Creeks/Streams
- Preliminary Plans
- Railroad ROW
- Water Bodies
- Jurisdictions**
- County
- Charlotte
- Cornellus
- Davidson
- Huntersville
- Matthews
- Mint Hill
- Pineville

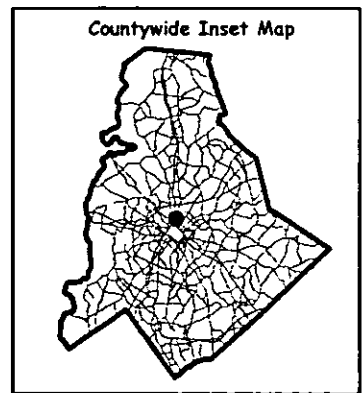
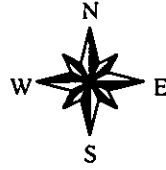

Scale : 1 Inch = 400 Feet
 Map Created on Thursday, October 10, 2002 01:25 PM

This map is prepared for the inventory of real property within Mecklenburg County and is compiled from recorded deeds, plats, tax maps, surveys, planimetric maps, and other public records and data. Users of this map are hereby notified that the aforementioned public primary information sources should be consulted for verification. Mecklenburg County and its mapping contractors assume no legal responsibility for the information contained herein.