



\* 0 0 B R E A K 0 0 \*



**ADVANCED  
IMAGING  
SYSTEMS**

An Information  
Management Company

www.aisimc.com

# City of Charlotte – Planning Dept. Scanning Rezoning Files

Petition # \_\_\_\_\_

## Document type:

- Applications
- Correspondence
- Department Comments
- Land Use Consistency
  - Mail Info
  - Mapping
  - Other
- Site Plans



\* 0 0 B R E A K 0 0 \*

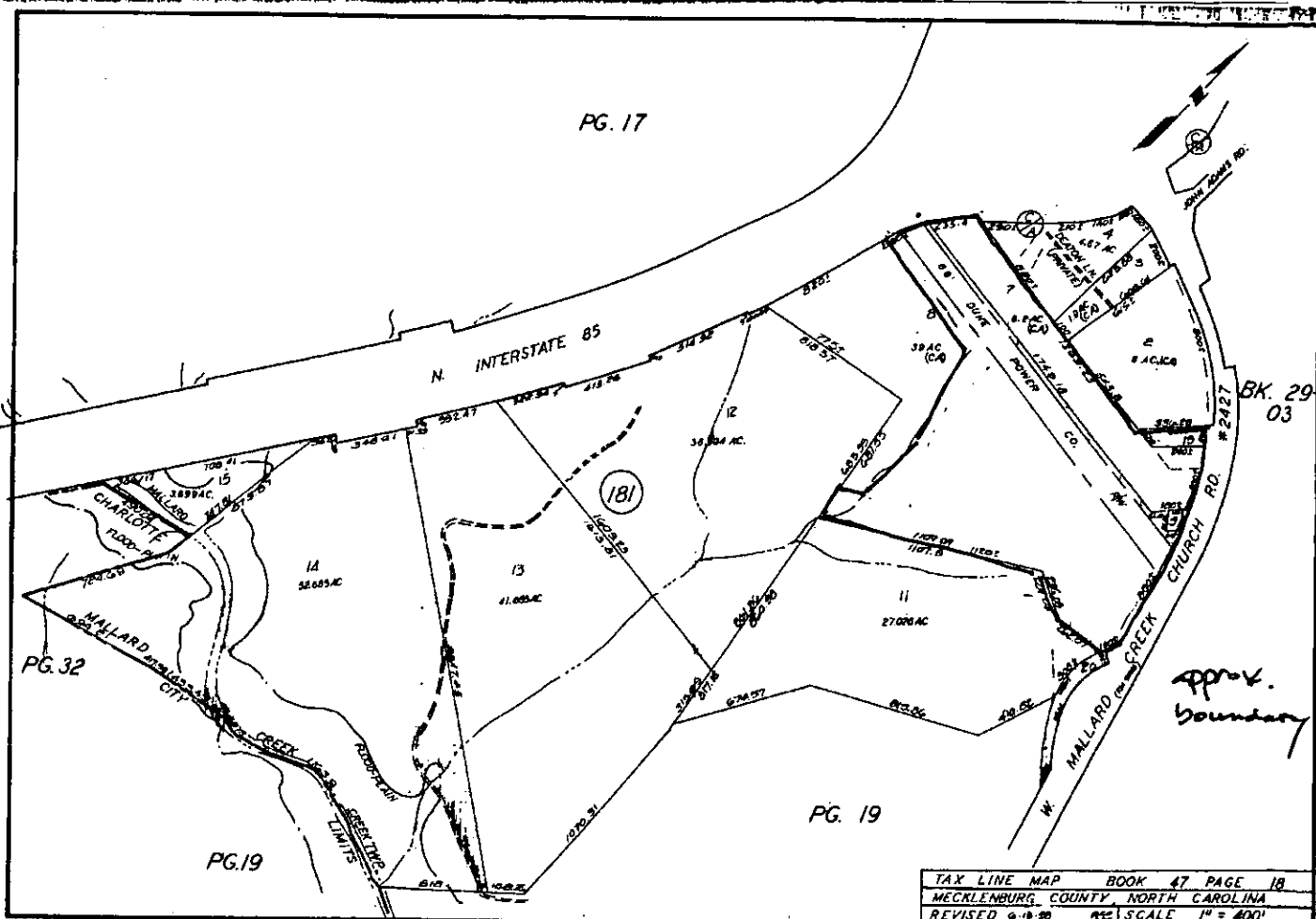
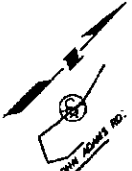

PG. 32

PG. 19

PG. 19

approx. boundary

BK. 29-03

TAX LINE MAP BOOK 47 PAGE 18  
 MECKLENBURG COUNTY NORTH CAROLINA  
 REVISED 6-15-80 SCALE 1" = 400'



# MECKLENBURG COUNTY, NC GIS PUBLIC ACCESS SYSTEM







Tax Parcel-Id#s Selected: See Tax Information Report for List of Parcel-Id#s

Tax Book & Page Selected: N/A

02-127

**LEGEND**

-  County Boundary
-  Rivers/Creeks/Streams
-  Railroad ROW
-  Water Bodies

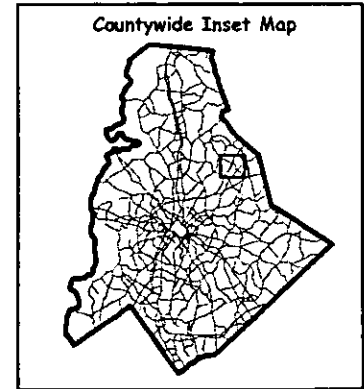
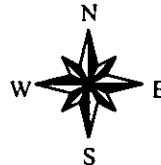
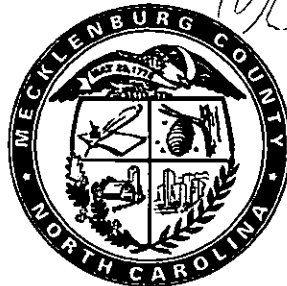

Scale : 1 Inch = 2000 Feet

Map Created on Monday, September 9, 2002 10:34 AM

This map is prepared for the inventory of real property within Mecklenburg County and is compiled from recorded deeds, plats, tax maps, surveys, planimetric maps, and other public records and data. Users of this map are hereby notified that the aforementioned public primary information sources should be consulted for verification. Mecklenburg County and its mapping contractors assume no legal responsibility for the information contained herein.

Zone	ODzone_area
251	3.221238
255	0.831402
256	1.970706
257	0.701286
261	2.435357
262	1.729388
263	0.585217
267	1.529777
268	2.879760

02 127