



* 0 0 B R E A K 0 0 *



**ADVANCED
IMAGING
SYSTEMS**

www.aisimc.com

An Information
Management Company

City of Charlotte – Planning Dept. Scanning Rezoning Files

Petition # _____

Document type:

- Applications
- Correspondence
- Department Comments
- Land Use Consistency
 - Mail Info
 - Mapping
 - Other
- Site Plans



* 0 0 B R E A K 0 0 *

Petition #: **2004-007**

Petitioner: T.A. Baucom and Anthony V. Hunt

Zoning Classification (Existing): R-3
(Single-family Residential, up to 3 dwelling units per acre)

Zoning Classification (Requested): INST(CD)
(Institutional, Conditional)

Acres & Location : Approximately 1.8 acres located on the northeast corner of East Lake Forest Road and Albemarle Road

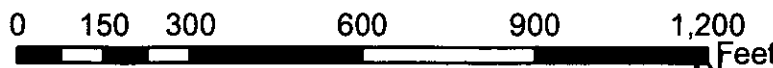
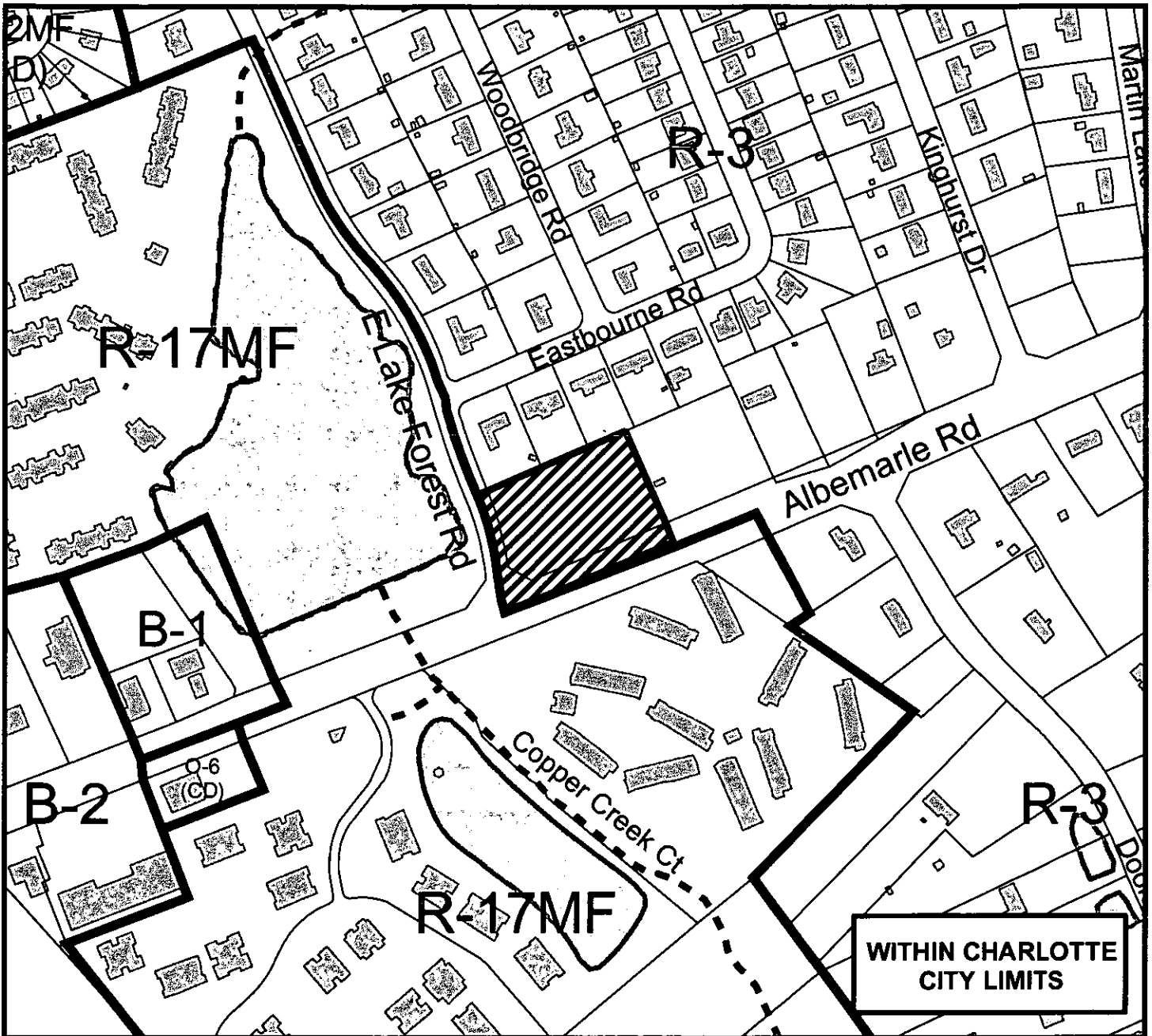

Zoning Map #(s) **114**

Map Produced by the
Charlotte-Mecklenburg Planning Commission
10-29-2003

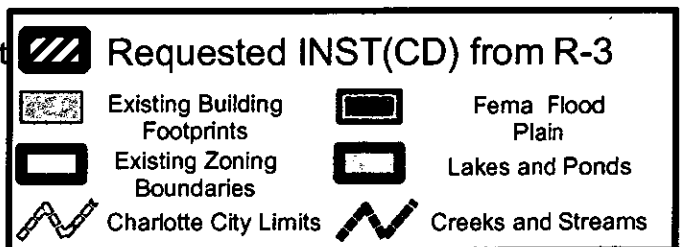

Mecklenburg County, NC POLARIS Parcel Ownership and GIS Summary <i>Date and Time: 10/10/2003 3:26:45 PM</i>	
Parcel ID #: 10913133 GIS ID #: 10913133	
Owner Name:	THOMAS A BAUCOM AND LOIS F BAUCOM
Mailing Address:	1632 MCMANUS RD MIDLAND, NC 28107
Property Characteristics	
Legal Desc.:	NA
Land Area:	1.79 AC
Fire District:	00-CITY OF CHARLOTTE
Special District:	NA
Account Type:	INDIVIDUAL
Municipality:	1-CHARLOTTE
Property Use:	VACANT
Deed Reference(s) and Sales Price	
04994-961 (2/20/1985) \$0.00	
Situs Addresses Tied to This Parcel	
7419 ALBEMARLE RD	
Site Location Information	
Zoning Boundaries:	Contact Appropriate Planning Department
ETJ Area: CHARLOTTE	
6/30/03 Charlotte Annexation: NO	
Charlotte Historic Districts: NO	
Census Tract #: 19.13	
Parcel Falls Inside SWIM Buffer?: NO	
FEMA Flood Information	
FEMA Panel #:	3701590015B
FEMA Flood Zone:	OUT
FEMA Panel Date:	03/02/93
Regulated Watershed Information	
Watershed Name:	McALPINE
Watershed Class:	
The information provided by this program is prepared for the inventory of real property within Mecklenburg County and is compiled from recorded deeds, plats, tax maps, surveys, and other public records and data. Users of this map data are hereby notified that the aforementioned public primary information sources should be consulted for verification of the information. Mecklenburg County and its mapping contractors assume no legal responsibility for the information contained herein.	

Get Quats from SURVEYS

Mecklenburg County, North Carolina
POLARIS
Property Ownership Land Records Information System
Date Printed: Mon Oct 13 09:15:16 EDT 2003



This map is prepared for the inventory of real property within Mecklenburg County and is compiled from recorded deeds, plats, tax maps, surveys, planimetric maps, and other public records and data. Users of this map are hereby notified that the aforementioned public primary information sources should be consulted for verification. Mecklenburg County and its mapping contractors assume no legal responsibility for the information contained herein.

Mecklenburg County, North Carolina
POLARIS
Property Ownership Land Records Information System
 Date Printed: Fri Oct 10 15:16:02 EDT 2003

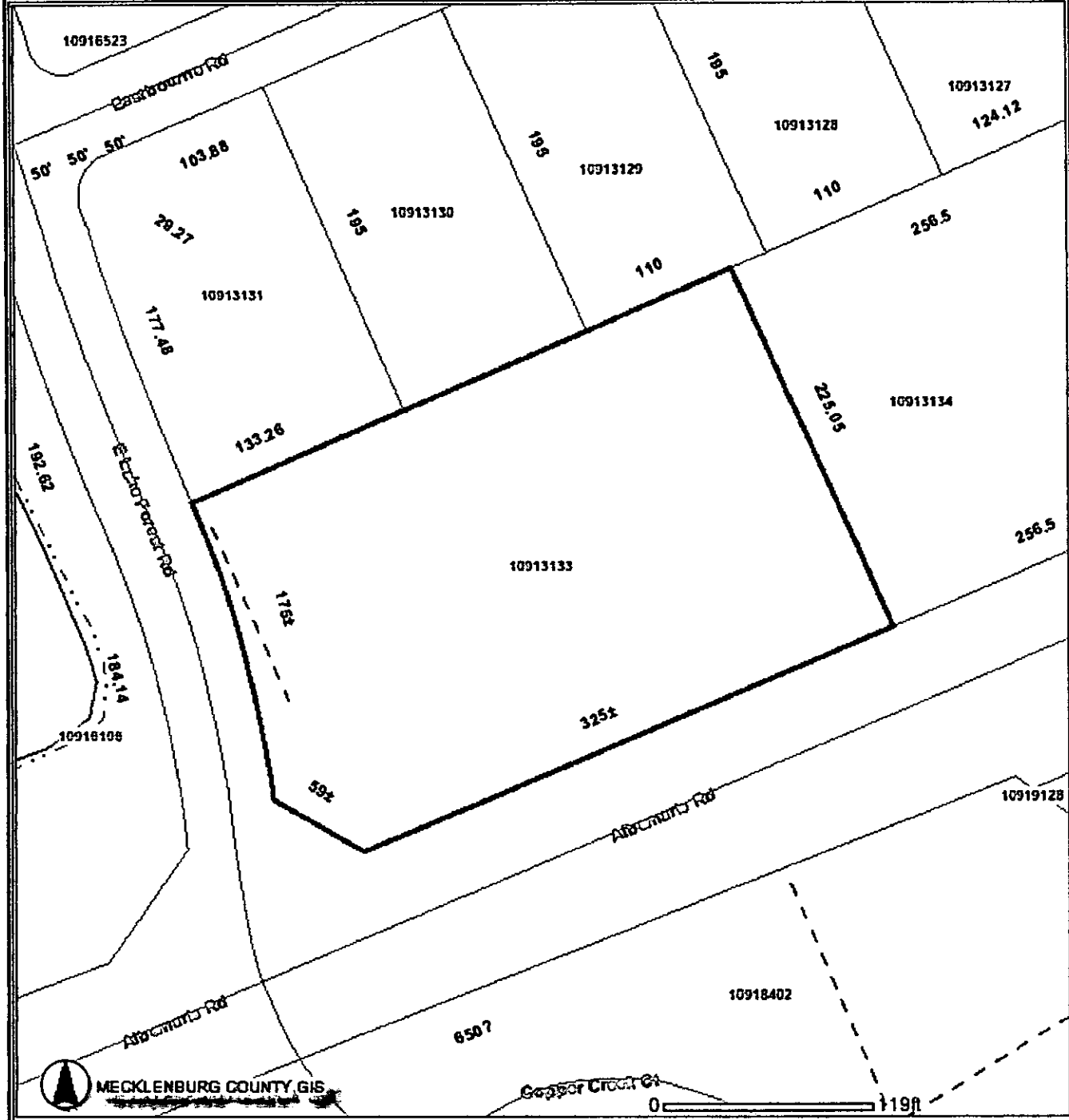

This map is prepared for the inventory of real property within Mecklenburg County and is compiled from recorded deeds, plats, tax maps, surveys, planimetric maps, and other public records and data. Users of this map are hereby notified that the aforementioned public primary information sources should be consulted for verification. Mecklenburg County and its mapping contractors assume no legal responsibility for the information contained herein.

Mecklenburg County, NC POLARIS
Property Ownership Land Records Information System
Adjoining Owner's Report
 Buffer Distance: 100 Feet
 10/22/2003 11:55:26 AM

[Click Here to Open Owner's List \(Comma-Delimited\)](#)

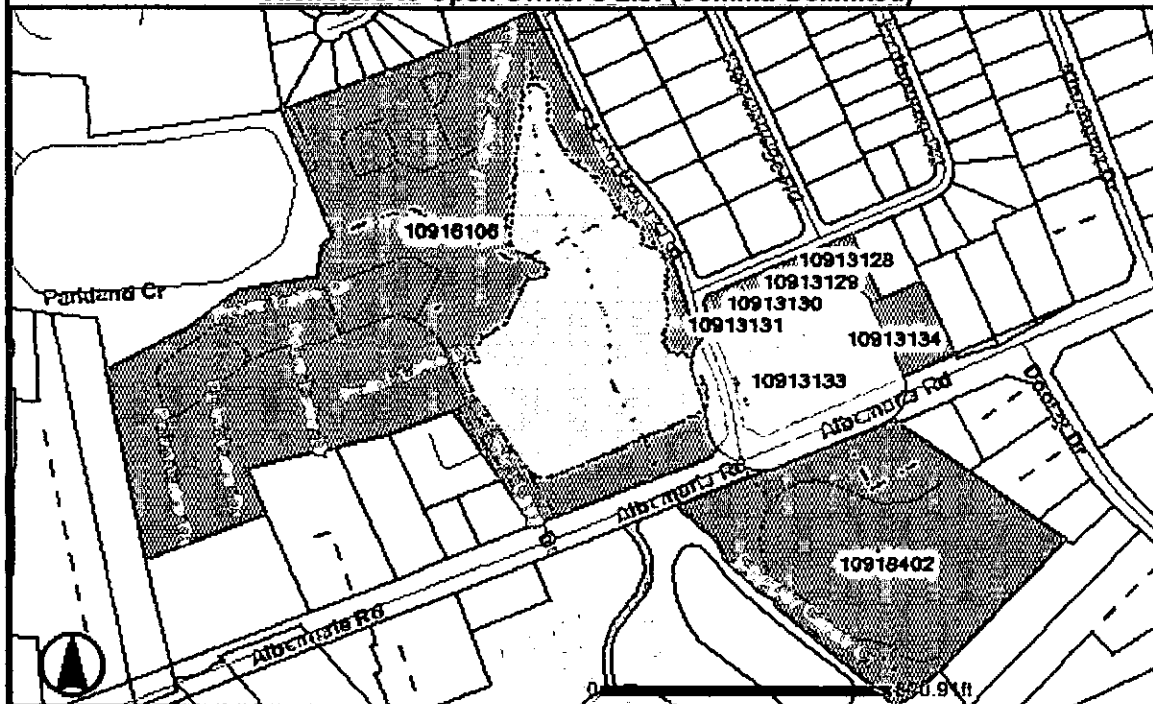

This map is prepared for the inventory of real property within Mecklenburg County and is compiled from recorded deeds, plats, tax maps, surveys, planimetric maps, and other public records and data. Users of this map are hereby notified that the aforementioned public primary information sources should be consulted for verification. Mecklenburg County and its mapping contractors assume no legal responsibility for the information contained herein.

Parcel ID	Owner Name	Mailing Address	City	State	ZIP	Legal Description	Deed Book	Deed Page	Land Area
10913128	ELAINE WALKER	7502 EASTBOURNE RD	CHARLOTTE	NC	28227	L4 B1 M9-389	06303	921	1 LT
10913129	LAM VAN LEE AND NHUNG THI	7420 EASTBOURNE RD	CHARLOTTE	NC	28227	L3 B1 M8-165	04622	708	1 LT
10913130	EDWIN G MORETZ AND BY ENT	7410 EASTBOURNE RD	CHARLOTTE	NC	28227	L2 B1 M9-389	03423	626	1 LT
10913131	DEVERNON POLSTON AND BARBARA L POLSTON	7400 EASTBOURNE RD	CHARLOTTE	NC	28227	L1 B1 M8-165	04075	511	1 LT
10913133	THOMAS A BAUCOM AND LOIS F BAUCOM	1632 MCMANUS RD	MIDLAND	NC	28107	NA	04994	961	1.79 AC
10913134	CHURCH PHILADELPHIA PRESBYTERIAN	7429 ALBEMARLE RD	CHARLOTTE	NC	28215	SM-TR M9-309	14620	511	1.32 AC
10916106	LLC LAKE POINT GARDENS ASSOCIATES AND KINGSBERRY JACKSONVILLE LLC AND % HARBOR GROUP INTL LLC	555 EAST MAIN ST #1700	NORFOLK	VA	23510	L1 M20-299 & TR	15463	463	32.15 AC
	PARAGON GROUP LP AND								

10918402	CAMDEN PRPOERTY TRUST AND % PROPERTYTAX- DEPT 112	PO BOX 4900	SCOTTSDALE	AZ	85261- 4900	P11-13 M3-68	07859	493	10.28 AC
----------	---	-------------	------------	----	----------------	--------------	-------	-----	-------------