

THIS DRAWING IS THE PROPERTY OF JMA, JAMES MCGOVERN & ASSOCIATES CONSULTING ENGINEERS, AND IS NOT TO BE REPRODUCED OR COPIED IN WHOLE OR IN PART. IT IS NOT TO BE USED ON ANY OTHER PROJECT AND IS TO BE RETURNED UPON REQUEST.

JMA
 800 Town Center Blvd, Suite 100
 P.O. Box 691
 Pineville, North Carolina 28134
 (704) 699-9200
 James McGovern & Associates
 Consulting Engineers

Hunters Crossing Business Park
 Hwy 521
 Charlotte, North Carolina
 ILLUSTRATIVE
 SITE PLAN

Project _____
 Sheet Title _____

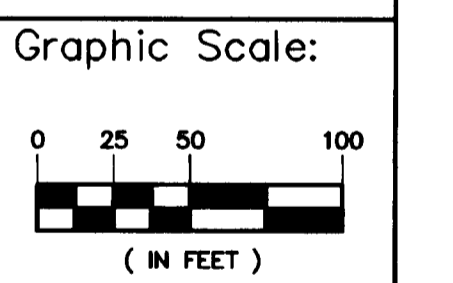
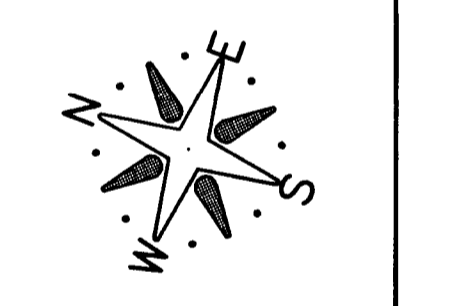

Scale: (1"=50')
 Engineer
 James J. McGovern
 Senior Designer
 Ted W. Lawrence
 Date
 4.23.2006

Revisions	No	Date
	No 1	Date 6.20.2006
	No 2	Date 7.12.2006
	No 3	Date 1.29.2014
	No	Date
	No	Date
	No	Date

ATTACHED TO ADMINISTRATIVE APPROVAL

APR / 2014
 BY: DEBRA CAMPBELL

Dwg. No.
 \dwg\rezoningbase

Project Number
 483.001

Sheet No. No. of Sheet
 isp 2 3

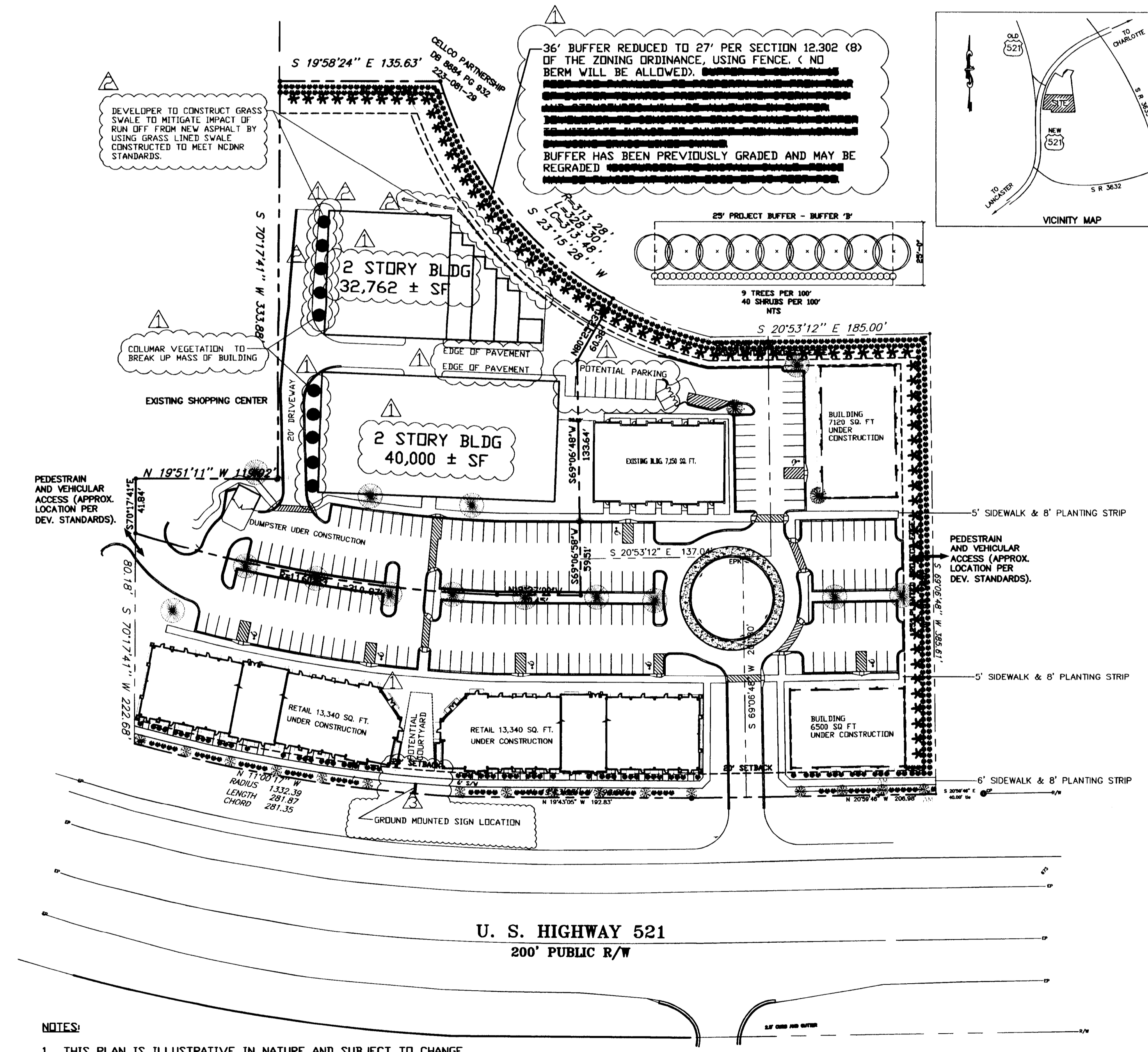

- NOTES:**
1. THIS PLAN IS ILLUSTRATIVE IN NATURE AND SUBJECT TO CHANGE PENDING FINAL SITE PLAN DOCUMENTS.
 2. ALL BUILDINGS LOCATED ON TRACT SHALL BE BUILT TO THE RELEVANT SETBACK LINE, HOWEVER THE PLACEMENTS, CONFIGURATIONS AND SIZES OF SUCH BUILDINGS DEPICTED ON THE SCHEMATIC SITE PLAN ARE CONCEPTUAL AND THE SAME MAY BE ALTERED OR MODIFIED DURING DESIGN DEVELOPMENT AND CONSTRUCTION DOCUMENT PHASES SUBJECT TO THE REQUIREMENT THAT SUCH BUILDING BE BUILT TO THE RELEVANT SETBACK LINE.

FOR PUBLIC HEARING PETITION No. 2006-100
 SIGN LOCATION BY SHAD SPENCER'S DIRECTION.