

**REVISIONS:**

- 1. REVISED MAY 18, 2009
- 2. REVISED JUNE 19, 2009
- 3. REVISED JULY 10, 2009

**APPROVED BY CITY COUNCIL**  
 JUL 20 2009

**FOR PUBLIC HEARING**  
 PETITION #: 2009-042

**1" = 60'**  
 0 30 60 120

# TECHNICAL DATA SHEET

## SHEET 1

CHARLOTTE, NC      10 JULY 2009



LS

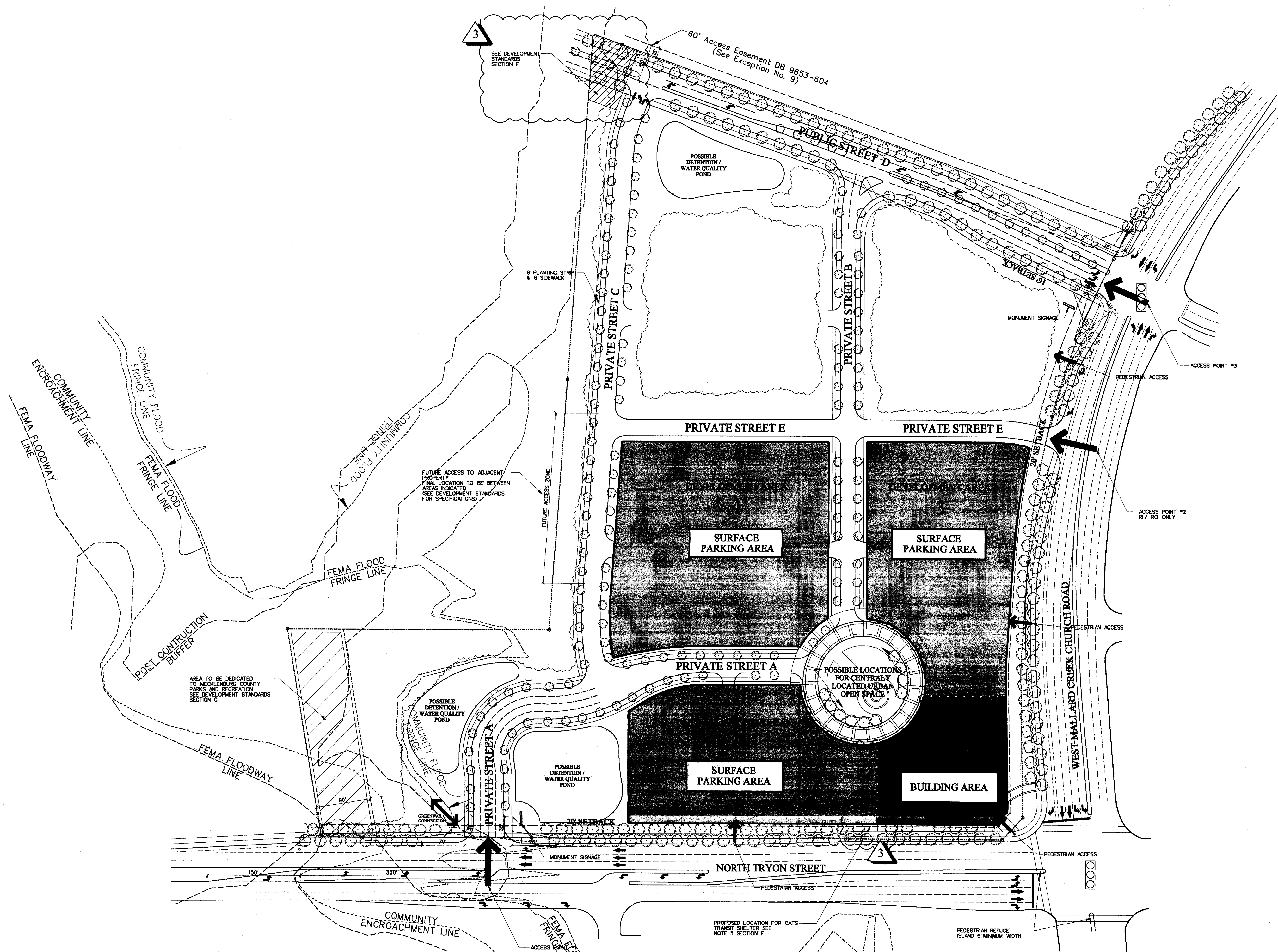

APPROVED BY  
CITY COUNCIL  
JUL 20 2009

- 1 REVISED MAY 18, 2009
- 2 REVISED JUNE 19, 2009
- 3 REVISED JULY 10, 2009

FOR PUBLIC HEARING  
PETITION #: 2009-042

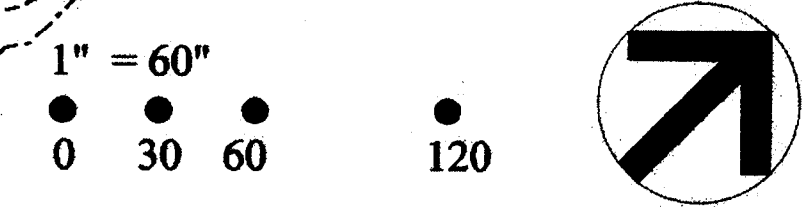

# DEVELOPMENT AREA ONE - TECHNICAL DATA SHEET

## SHEET 2

CHARLOTTE, NC      10 JULY 2009

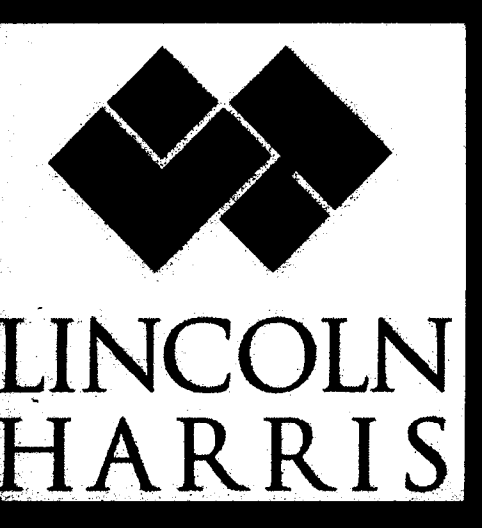

LS

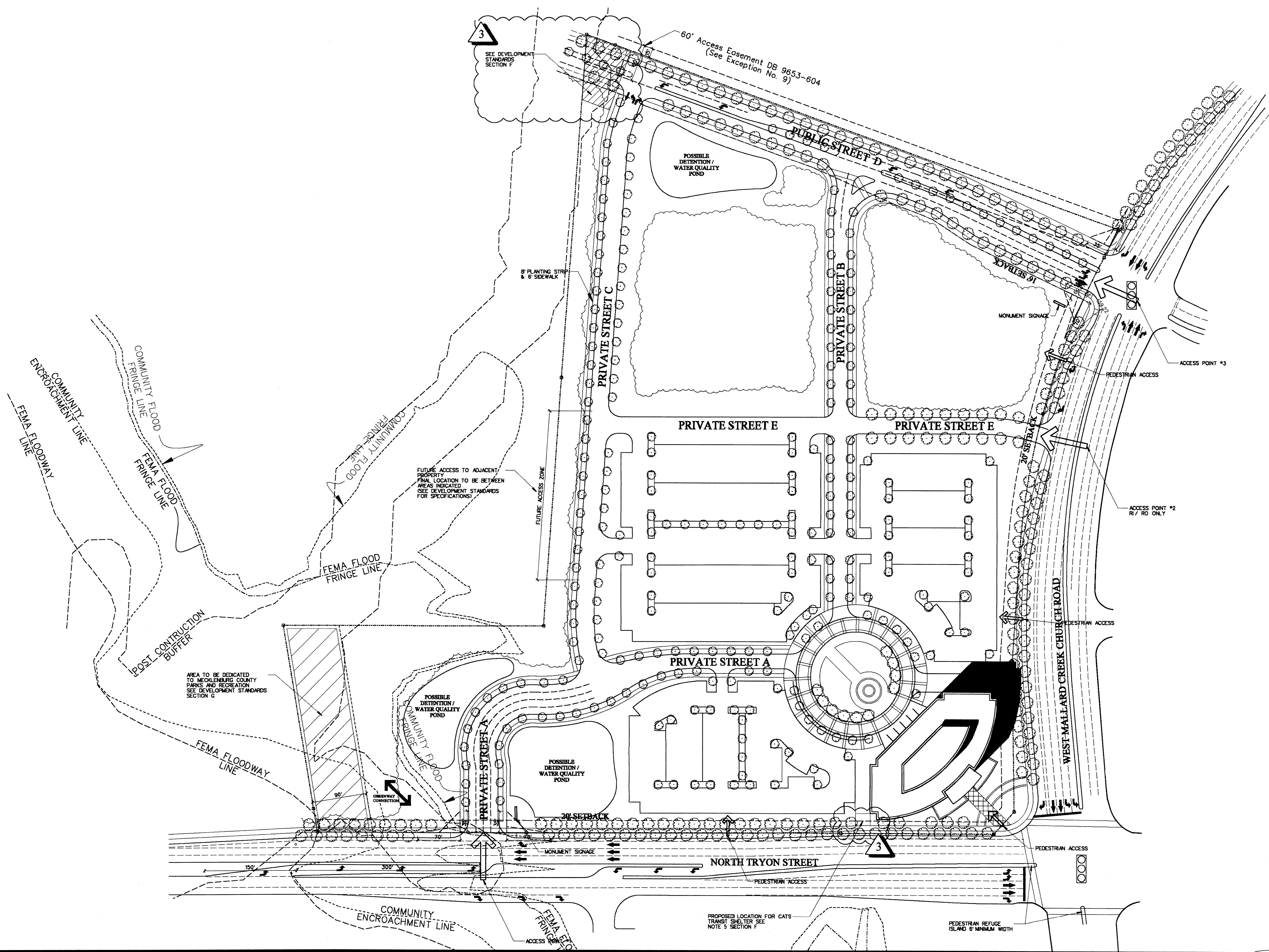

APPROVED BY  
CITY COUNCIL  
JUL 29 2009

- 1 REVISED MAY 18, 2009
- 2 REVISED JUNE 19, 2009
- 3 REVISED JULY 10, 2009

FOR PUBLIC HEARING  
PETITION #: 2009-042

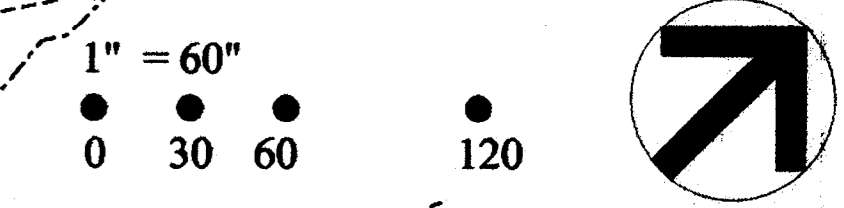

# DEVELOPMENT AREA ONE - ILLUSTRATIVE MASTER PLAN

## SHEET 3

CHARLOTTE, NC

10 JULY 2009

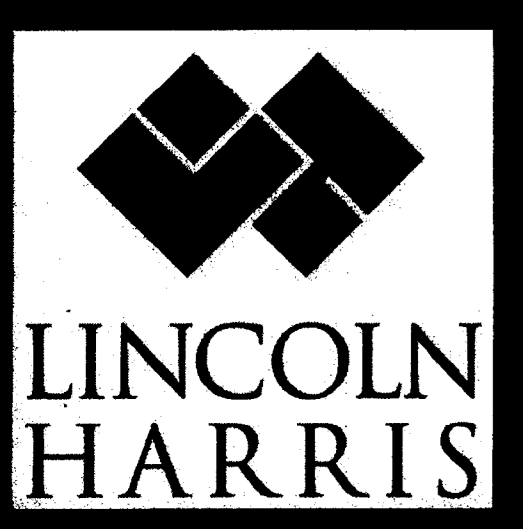

LS

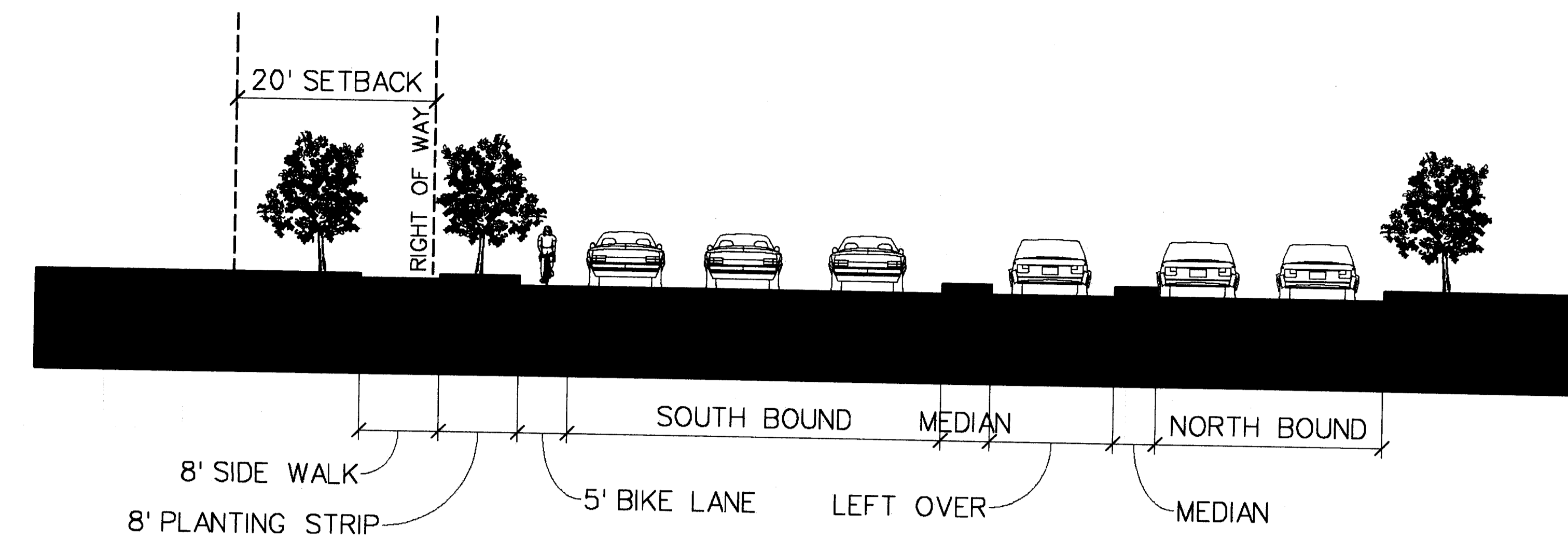

**A. NORTH TRYON STREET SECTION**  
SCALE = 1" = 10'-0"

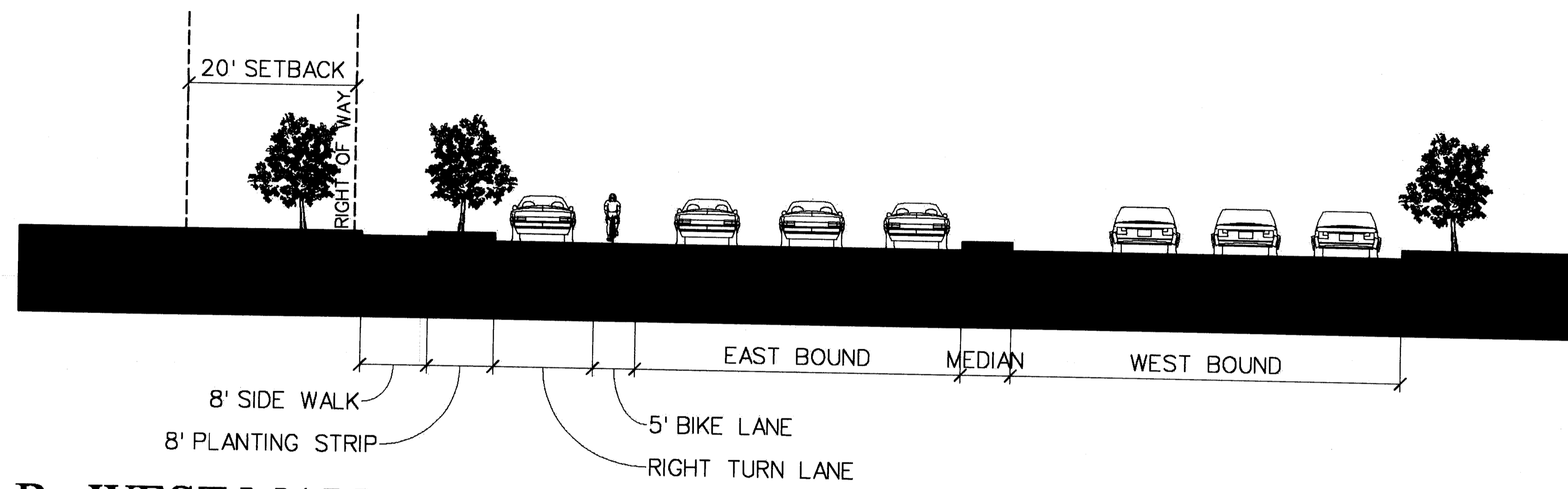

**B. WEST MALLARD CREEK CHURCH ROAD STREET SECTION**  
SCALE = 1" = 10'-0"

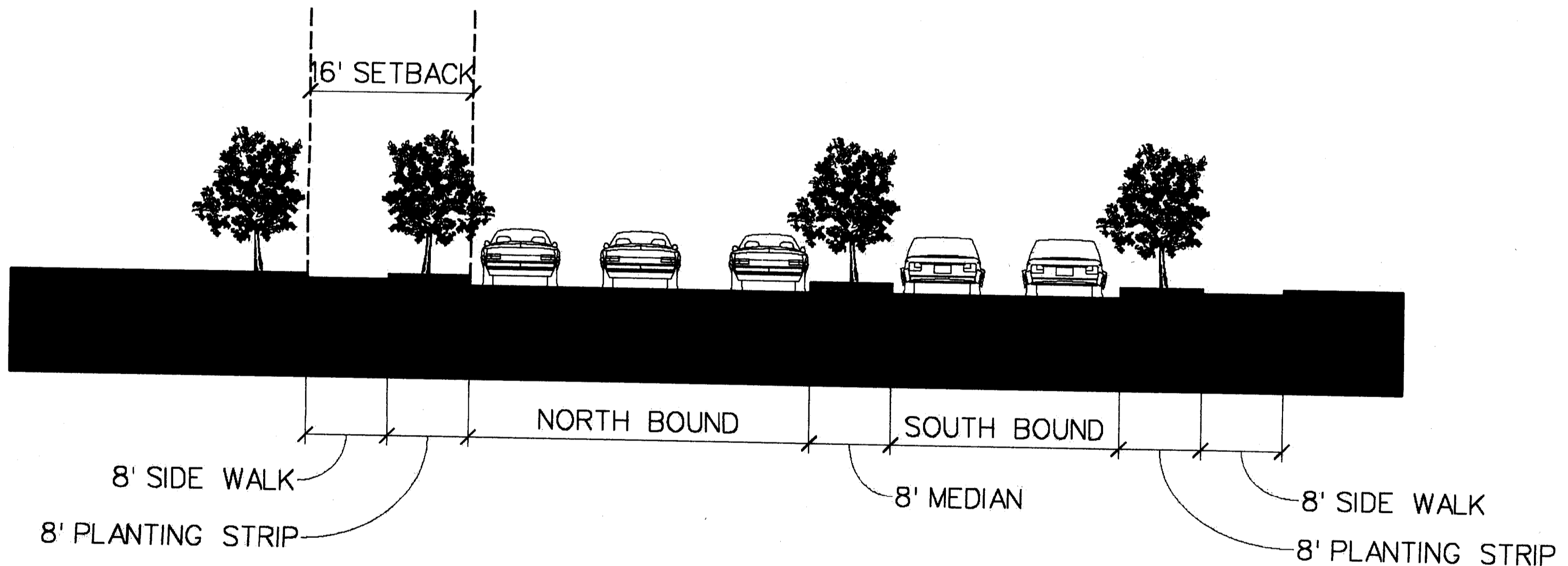

**C. STREET D STREET SECTION**  
SCALE = 1" = 10'-0"

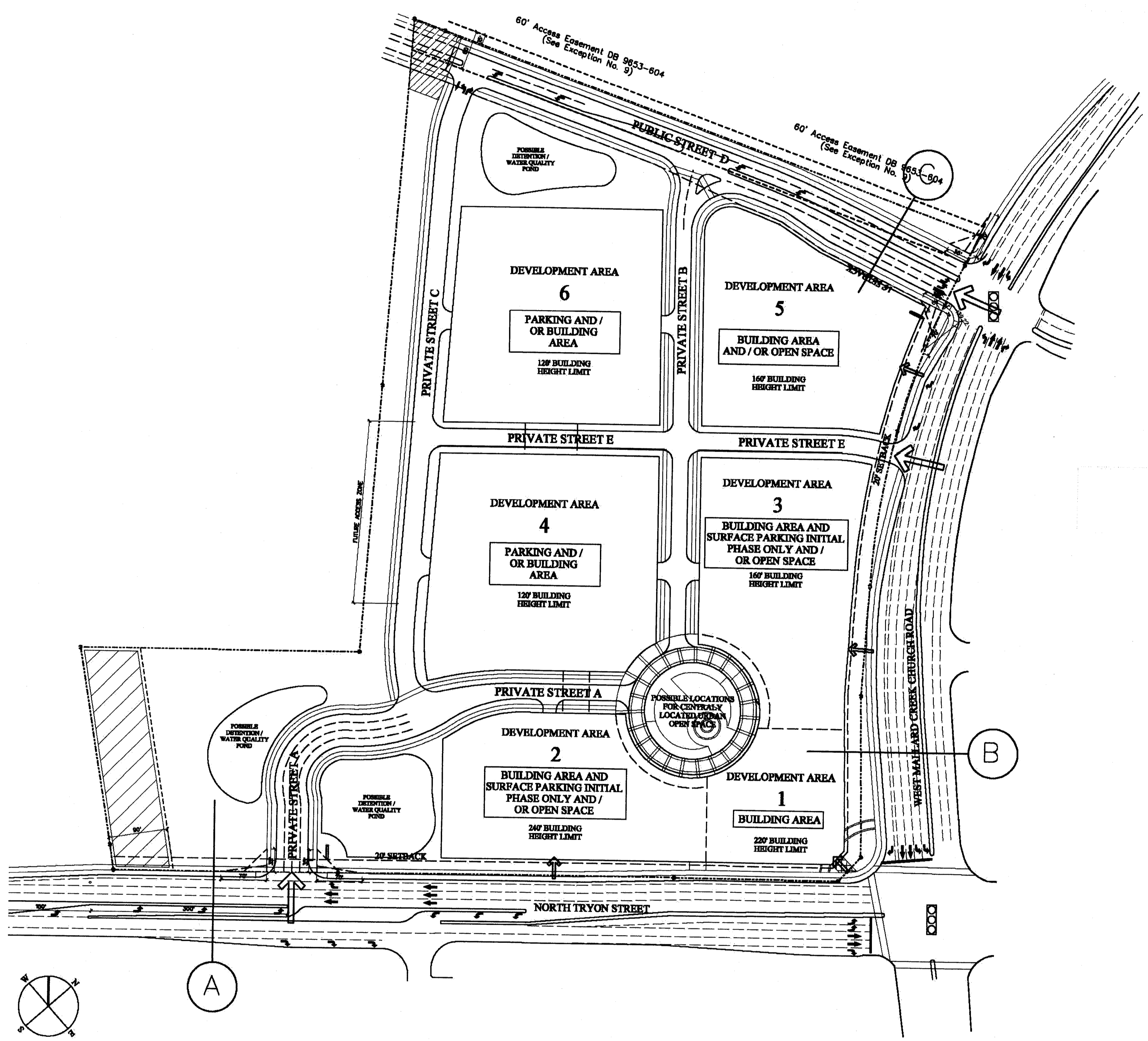

**KEY PLAN**

APPROVED BY  
CITY COUNCIL  
JUL 20 2009

FOR PUBLIC HEARING  
PETITION #: 2009-042



**STREET SECTIONS**

SHEET 4

CHARLOTTE, NC

10 JULY 2009

LS



NORTH TRYON & WEST MALLARD CREEK  
CHURCH ROAD INTERSECTION



NORTH TRYON & WEST MALLARD CREEK  
CHURCH ROAD INTERSECTION



ENTRY PLAZA / MOTOR COURT

APPROVED BY  
CITY COUNCIL  
JUL 20 2009

Note:  
These attached elevations are included to reflect  
the architectural style and quality of the buildings  
that will be constructed on the site (the actual buildings  
constructed on the site may vary from these illustrations  
as long the general architectural concepts and intent  
illustrated is maintained)

FOR PUBLIC HEARING  
PETITION #: 2009-042



# CONCEPTUAL PERSPECTIVES

## SHEET 5

CHARLOTTE, NC

10 JULY 2009

LS