

Previously
Approved
Site Plan

Scale	1"=40'
Date	12/17/07
Drawn By	MKS
Checked By	JFS
Job No.	1507

1. ALL DIMENSIONS ARE TO FACE UNLESS OTHERWISE NOTED.
 2. ALL DIMENSIONS ARE TO FACE UNLESS OTHERWISE NOTED.

1115 GREENWOOD CLIFF
 CHARLOTTE, NORTH CAROLINA 28204
 ENGINEERING
 LAND SURVEYING
 ENVIRONMENTAL DESIGN
 KENNEY DESIGN GROUP, PA
 1000 W. WILSON ROAD
 SUITE 100
 CHARLOTTE, NC 28202
 PHONE: 704.366.1111
 FAX: 704.366.1112
 WWW.KENNEYDESIGN.COM

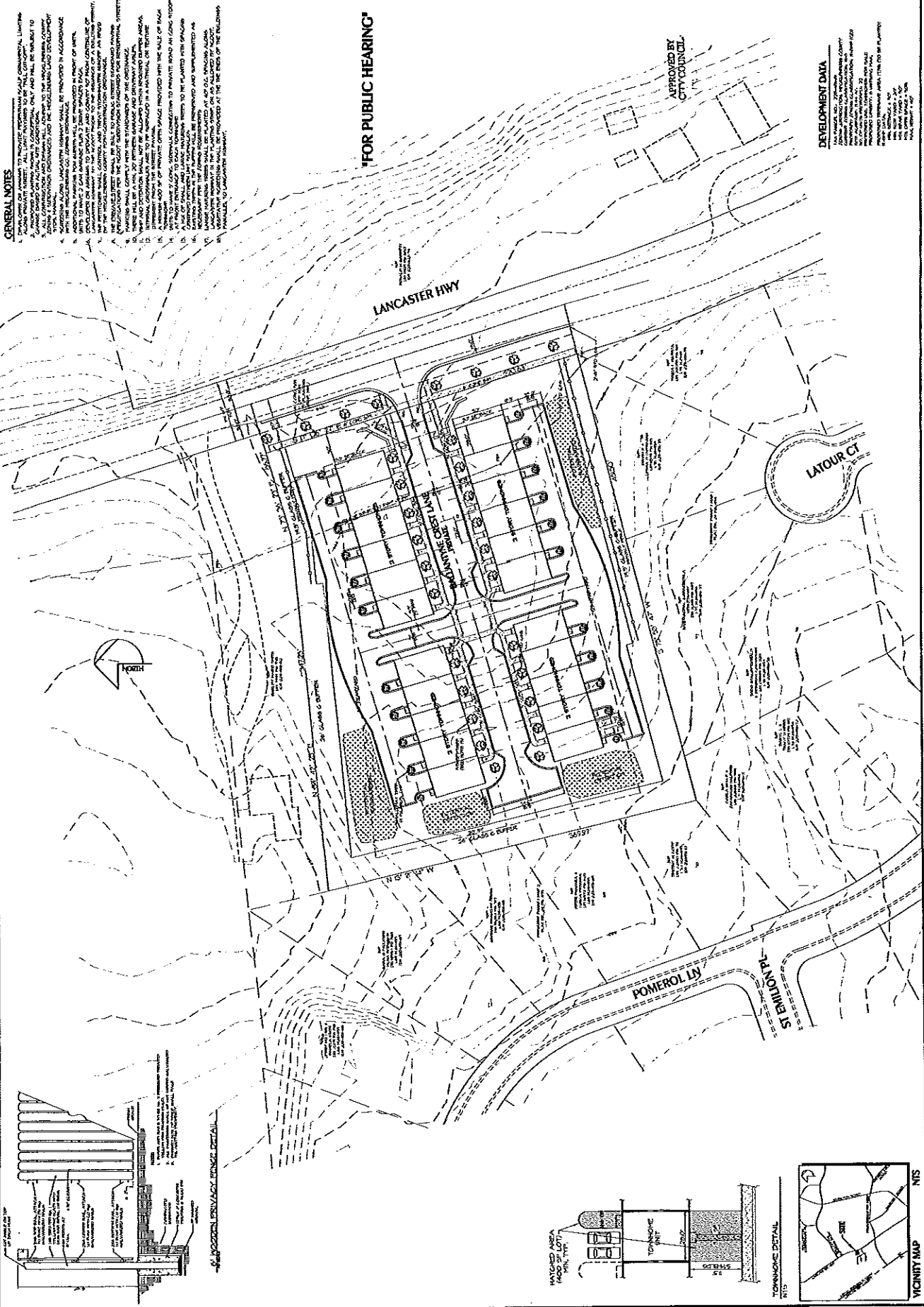

GENERAL NOTES

1. THIS PLAN IS FOR APPROVAL TO REZONE THE PROPERTY FROM COMMERCIAL LIGHT INDUSTRIAL TO RESIDENTIAL MEDIUM DENSITY (R-100) AND TO REZONE THE PROPERTY FROM COMMERCIAL LIGHT INDUSTRIAL TO RESIDENTIAL MEDIUM DENSITY (R-100) AND TO REZONE THE PROPERTY FROM COMMERCIAL LIGHT INDUSTRIAL TO RESIDENTIAL MEDIUM DENSITY (R-100).
2. THE DEVELOPER SHALL BE RESPONSIBLE FOR OBTAINING ALL NECESSARY PERMITS AND APPROVALS FROM THE LOCAL GOVERNMENT AND STATE AGENCIES.
3. THE DEVELOPER SHALL BE RESPONSIBLE FOR OBTAINING ALL NECESSARY PERMITS AND APPROVALS FROM THE LOCAL GOVERNMENT AND STATE AGENCIES.
4. THE DEVELOPER SHALL BE RESPONSIBLE FOR OBTAINING ALL NECESSARY PERMITS AND APPROVALS FROM THE LOCAL GOVERNMENT AND STATE AGENCIES.
5. THE DEVELOPER SHALL BE RESPONSIBLE FOR OBTAINING ALL NECESSARY PERMITS AND APPROVALS FROM THE LOCAL GOVERNMENT AND STATE AGENCIES.
6. THE DEVELOPER SHALL BE RESPONSIBLE FOR OBTAINING ALL NECESSARY PERMITS AND APPROVALS FROM THE LOCAL GOVERNMENT AND STATE AGENCIES.
7. THE DEVELOPER SHALL BE RESPONSIBLE FOR OBTAINING ALL NECESSARY PERMITS AND APPROVALS FROM THE LOCAL GOVERNMENT AND STATE AGENCIES.
8. THE DEVELOPER SHALL BE RESPONSIBLE FOR OBTAINING ALL NECESSARY PERMITS AND APPROVALS FROM THE LOCAL GOVERNMENT AND STATE AGENCIES.
9. THE DEVELOPER SHALL BE RESPONSIBLE FOR OBTAINING ALL NECESSARY PERMITS AND APPROVALS FROM THE LOCAL GOVERNMENT AND STATE AGENCIES.
10. THE DEVELOPER SHALL BE RESPONSIBLE FOR OBTAINING ALL NECESSARY PERMITS AND APPROVALS FROM THE LOCAL GOVERNMENT AND STATE AGENCIES.

'FOR PUBLIC HEARING'

APPROVED BY
 CITY COUNCIL

DEVELOPMENT DATA

1. TOTAL AREA: 10.0 ACRES
 2. TOTAL LOT AREA: 10.0 ACRES
 3. TOTAL BUILDING AREA: 100,000 SQ FT
 4. TOTAL PARKING SPACES: 100
 5. TOTAL UNITS: 100
 6. TOTAL GARAGES: 100
 7. TOTAL STREETS: 100
 8. TOTAL UTILITIES: 100
 9. TOTAL LANDSCAPING: 100
 10. TOTAL FURNITURE: 100

