

Petition #: 97-36(c)
 Petitioner: Jim McLaughlin
 Hearing Date: July 15, 1997
 Zoning Classification (Existing): R-3
 Zoning Classification (Requested): I-1
 Location: Approximately 5.6 acres located on the east side of Old Concord Road, south of the Rocky River Road intersection.

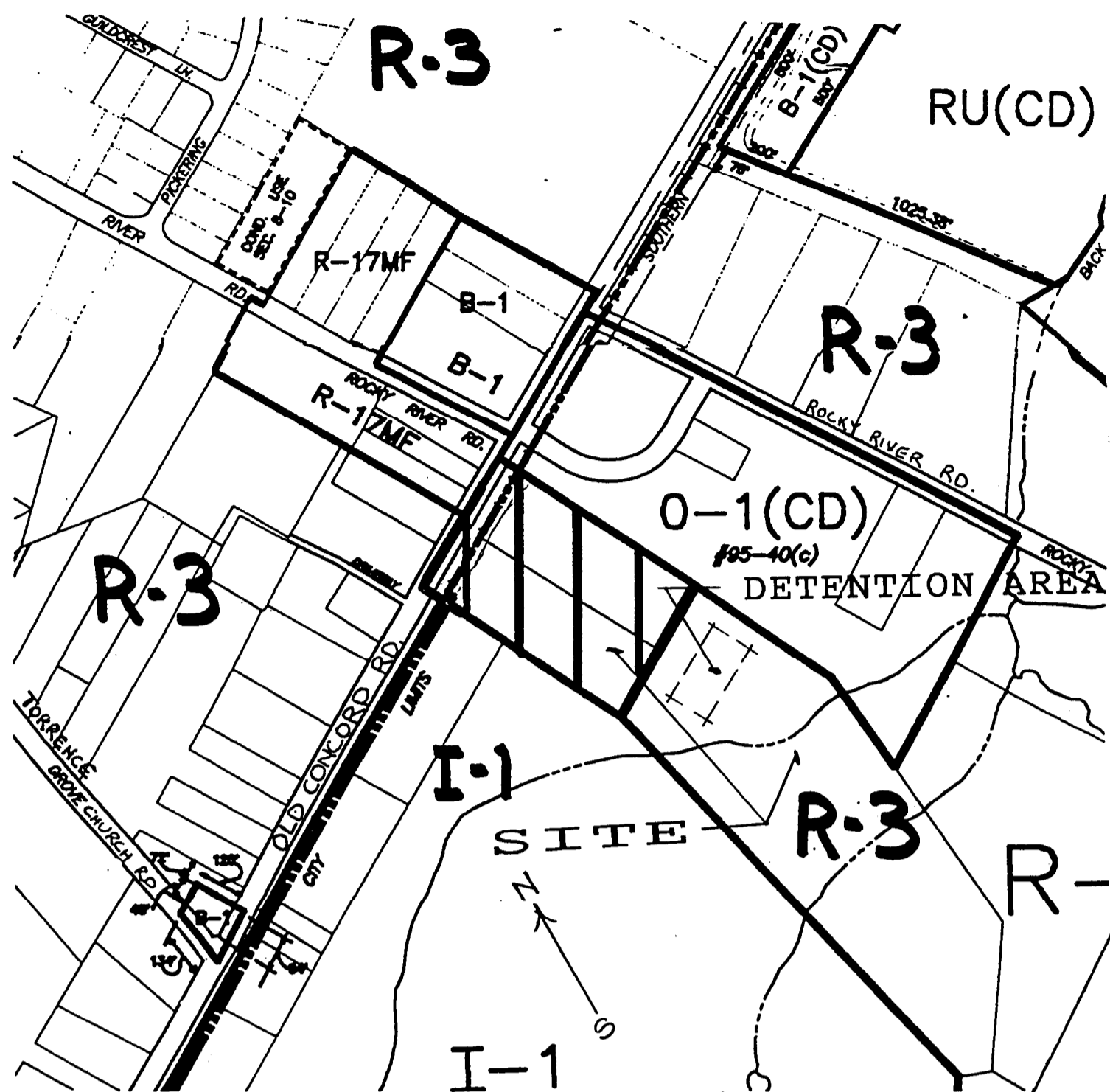

PROPOSED ZONING ~~R-3 & I-1~~ EXISTING
 SITE AREA APPROX. 17 ACRES
 MAX. TOTAL BUILDING S.F. 69,000 S.F.
 PARKING REQUIRED 345 SPACES
 PARKING PROVIDED 345 SPACES
 ALLOWABLE USES INDOOR & OUTDOOR REC.

NOTES:

1. SIGNAGE WILL BE PERMITTED IN ACCORDANCE WITH THE ZONING ORDINANCE.
2. ALL BUFFERS WILL REMAIN UNDISTURBED.
3. STORM WATER DETENTION WILL BE PROVIDED TO MEET REGULATORY STANDARDS BUT WILL NOT BE LOCATED IN EITHER SETBACK OR BUFFER AREAS.
4. MAX. HT. OF DETACHED LIGHTING NOT TO EXCEED 30 FT. IN PARKING LOT.
5. SCREENING SHALL COMPLY WITH SEC. 12.303 OF THE MECK. CO. ZONING ORDINANCE.
6. ALL DUMPSTERS SHALL BE SCREENED WITH A SOLID ENCLOSURE & GATE.
7. A VARIANCE WILL BE SOUGHT FOR THE ELIMINATION OF 78' BUFFER AT REAR OF 5.6 AC. PART OF PROPERTY. IF VARIANCE IS NOT GRANTED THE 78' BUFFER SHALL BE PROVIDED.
8. PARKING WILL COMPLY WITH RULE No. 12.208 OF THE ZONING ORDINANCE.

PROPOSED DETENTION AREA
 NOTE-THIS AREA IS A PART OF THE NEW APPROX. 12 AC. TO BE PURCHASED FOR THIS RECREATION DEVELOPMENT. SEE LOCATION MAP. THERE IS NO SURVEY OF THIS AREA.

105-012-09
 MCLAUGHLIN J. FAMILY
 P.O. BOX 158
 NEWELL, N.C.

* IF REQUIRED BY ZONING ADMINISTRATOR, PETITIONER WILL APPLY FOR ZONING VARIANCE.

APPROVED BY COUNTY COMMISSION
 DATE 10/14/97

VICINITY & ZONING
 MAP

105-012-09
 MCLAUGHLIN J. FAMILY
 P.O. BOX 158
 NEWELL, N.C.

105-011-06
 NEWTON & ASSOC.
 1806 ROCKY RIVER RD.
 CHARLOTTE 28213
 S.R. 2841

PROPOSED SPORTS COMPLEX BUILDING
 105-012-01
 MCLAUGHLIN J. FAMILY
 P.O. BOX 158
 NEWELL, N.C.

105-012-03
 LESTONE TOM
 P.O. BOX 46145
 8108 OLD CON

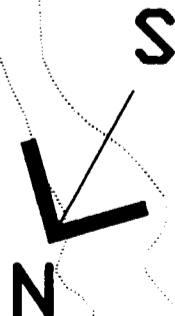
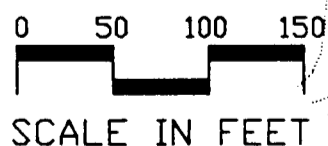

OLD CONCORD ROAD (S.R. #2939) 60' RIGHT OF WAY
 OWNER/PETITIONER: J. MCLAUGHLIN # 97-36(C)
 PLAN BY: LEE THOMAS & ASSOCIATES
 LAND PLANING LANDSCAPE ARCHITECTURE

BASE INFORMATION PROVIDED BY OWNER/PETITIONER. NO FORMAL SURVEY INFORMATION IS AVAILABLE AT THIS TIME.
 DATE: JULY 15, 1997
 REVISED DATE: JULY 31, 1997
 REVISED DATE: AUG. 12, 1997

THE PASTURE SPORTS COMPLEX PHASE I SITE PLAN